



INSTRUCTIONS

-J03669

2010-09-17

SPORT LUGGAGE RACKS

GENERAL

Kit Numbers

Table 1. Sport Luggage Rack Kits

Kit Number	Rack Description
53896-06	Softail Five Bar (Chrome)
53953-06	Softail Custom Tapered (Chrome)
53965-06	Softail Five Bar (Wrinkle Black)
53982-08	Dyna Five Bar Tapered (Chrome)
54049-10	Dyna Five Bar Tapered (Gloss Black)
54055-10	Dyna Five Bar Tapered (Chrome)
54263-10	Softail Custom Tapered (Gloss Black)
50300030	Custom Tapered Sport (Chrome)
50300031	Custom Tapered Sport (Gloss Black)

Models

For model fitment information, see the P&A retail catalog or the Parts and Accessories section of www.harley-davidson.com (English only).

Additional Parts Required

Separate purchase of additional parts or accessories may be required for proper installation of this Luggage Rack on this model motorcycle. See the P&A retail catalog or the Parts and Accessories section of www.harley-davidson.com (English only) for a list of required parts or accessories for this model.

Tools and Supplies Required

Loctite[®] 271 Threadlocker and Sealant - Red (H-D Part Number 99671-97) is required for the proper installation of this kit. This item is available from a Harley-Davidson dealer.

Kit Contents

See Figure 1 and Table 2.

INSTALLATION

NOTE

Cover the rear fender with an H-D Service Cover or clean shop towel to prevent scratching the finish.

Rigid Mount Sideplates Only

1. See Figure 1. **Loosen** front two 3/8-16 TORX screws that attach rigid mount sideplates (A).
2. Loosen and **remove** rear two sideplate screws.
3. Raise sissy bar/sideplate assembly to gain access to screws (2) that attach sissy bar (B) to sideplates.

Rigid and Detachable Sideplates

1. Remove and discard four button head TORX screws (2) that attach sissy bar to sideplates.

2. Position luggage rack (1) between the sideplates.

NOTE

When properly installed the bumpers will cover the lower TORX head screws, and will bend around the lower edge of the sideplate channel.

3. Apply Loctite 271 - Red to **new** TORX screws (2) from kit, and insert screws through holes in luggage rack, sideplate and sissy bar. Tighten screws to 10.8–13.6 N-m (8–10 ft-lbs).
4. Remove backing strip from two rubber bumpers (3) and install onto luggage rack.
 - a. Align notches in bumper with bottom edge of channel on sideplate.
 - b. Wrap bumper up side of luggage rack channel and across bottom of sissy bar.

Rigid Mount Sideplates Only

1. Return sissy bar/sideplates to the normal position.

NOTE

Thoroughly remove all existing threadlocking agent from fastener and mounting hole threads before applying new threadlocking agent.

9.
 - a. Apply Loctite 271 - Red to the **clean** threads of the rear two TORX screws that attach rigid mount sideplates to motorcycle. Install rear two sideplate screws finger-tight.
 - b. Remove, clean and apply Loctite to front two screws, and install.
 - c. Tighten front and rear screws to 28.5–36.6 N-m (21–27 ft-lbs).

▲ WARNING

Do not exceed luggage rack weight capacity. Too much weight can cause loss of control, which could result in death or serious injury. (00373a)

NOTE

- The luggage rack weight capacity is limited to a maximum of 4.5 kg (10 lb).
- Do not use this rack as a seat.
- Do not exceed the fender rack weight capacity.

-J03669

Many Harley-Davidson® Parts & Accessories are made of plastics and metals which can be recycled. Please dispose of materials responsibly.

1 / 2

Service Parts

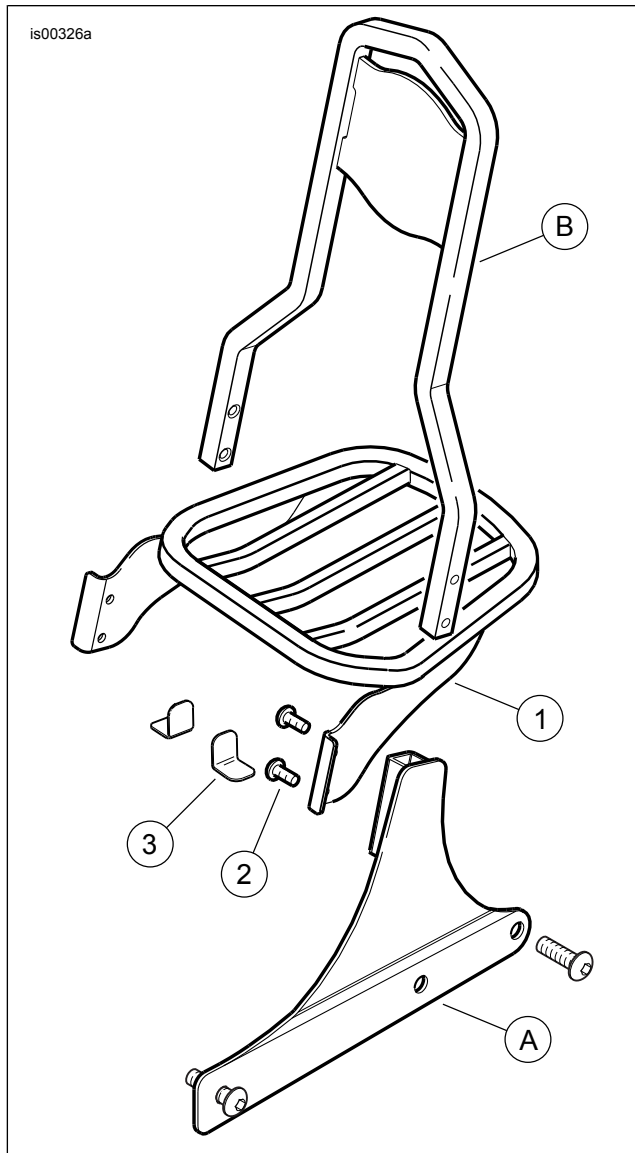

Figure 1. Service Parts, Sport Luggage Racks

Table 2. Service Parts

Item	Description (Quantity)	Part Number
1	Luggage rack (1)	Not sold separately
2	Screw, button head TORX®, 1/4-20 x 19 mm (¾ in) long (4)	94593-98
3	Rubber bumper (2)	53707-96A
Items mentioned in text, but not included in kit:		
A	Sideplate	
B	Sissy bar	