



# INSTRUCTIONS

-J00221

REV. 7-7-03

Kit Numbers 52284-96A and 52359-97

## BADLANDER SEAT KIT

### General

Kits **52284-96A** and **52359-97** are designed for installation on 1996 - 2003 **Dyna Glide** model motorcycles.

See *Service Parts* on page two for a list of kit contents.

### Installation

#### CAUTION

When performing the following procedures, be careful not to scratch painted surfaces (fender, tank, etc.) with metal tabs on seat.

1. Remove existing seat from motorcycle by removing screw with lockwasher, and nylon washer from rear fender mounting bracket. Keep lockwasher and nylon washer. Discard screw. Disengage seat from frame tab at front of seat.
2. Remove and discard existing seat strap and all attaching hardware.
3. See *Service Parts Illustration*. Place 1/16 in. (6) washer followed by 5/64 in. washer (5) onto hex head screw (4). Use this hardware assembly to install new seat strap onto motorcycle at same location old seat strap was removed.
4. **On FXD models, except FXDWG**, reuse the existing seat bracket, but use mounting hardware (8) from kit.  
**On FXDWG models**, replace attached fender seat bracket with seat bracket (7) and mounting hardware (8).
5. Position new seat on motorcycle, sliding the rear of the seat under the seat strap. Be sure bracket on front of seat fully engages seat mounting tab on frame.

#### NOTE

On rear fenders of 1997-2003 models, a captive nut secured with a plastic retention washer has replaced the previously used weld nut. Do not remove the plastic retention washer unless the captive nut is damaged and must be replaced. The plastic retention washer also prevents seat bracket from contacting paint on fender. Therefore, no nylon washer is required between bracket and fender on 1997-2003 models.

6. Follow the appropriate instructions to secure seat to rear fender:
  - 6a. **1996 Dyna models, except FXDWG**.- Secure seat with screw (1) stock lockwasher and place stock nylon washer between seat bracket and fender.
  - 6b. **1997 - 2003 Dyna models, except FXDWG**.- Secure seat with screw (1) and stock lockwasher.
  - 6c. **1996 FXDWG**.- Secure seat with screw (1) stock lockwasher and place guide washer (2) between seat bracket and fender.
  - 6d. **1997 - 2003 FXDWG**.- Secure seat with screw (1) and stock lockwasher.

#### WARNING

After installing seat, pull upward on front of seat to be sure it is in locked position. While riding, a loose seat can shift causing loss of control, which could result in death or serious injury. (00070a)



# Service Parts

Part No. 52284-96A/52359-97

Date 7/03

## Badlander Seat Kit

SP52284a

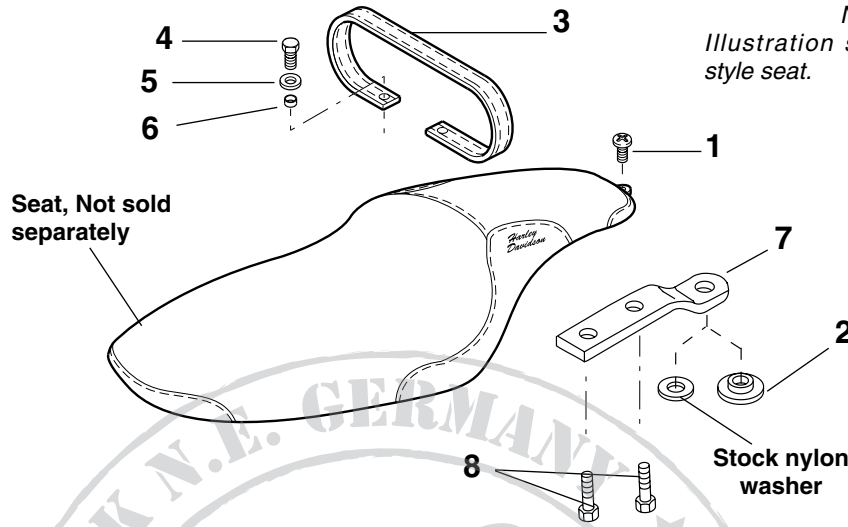

Item	Description	Part No.	Item	Description	Part No.
1	Screw, 1/4-20 X 1/2	2952	5	Washer, 5/16 X 1-1/8 X 5/64	6237
2	Guide washer	7487	6	Washer, 5/16 X 11/16 X 1/16	6702
3	Seat strap	52313-96	7	Seat mounting bracket	52152-97
4	Screw, 5/16-18 X 1-1/4 hex. hd.	2871W	8	Screw, hex cap, 1/4-20 X 1/2 (2)	3728

