



INSTRUCTIONS

-J05570

2012-02-16

FXSBSE DOCKING HARDWARE

GENERAL

Kit Number

523000239

Models

For model fitment information, see the P&A retail catalog or the Parts and Accessories section of www.harley-davidson.com (English only).

This kit is also required when mounting a Softail Detachable Saddlebag Kit.

Installation Requirements

If installing this kit for Softail Detachable Saddlebags, there may be other items required depending upon the accessory configurations being installed. See the P&A retail catalog or the instructions included in the Detachable Saddlebag Kit for a list of other items required.

Loctite[®] 243 Medium Strength Threadlocker and Sealant - Blue (Part No. 99642-97) is required for proper installation of this kit, and is available from a Harley-Davidson dealer.

▲ WARNING

The rider's safety depends upon the correct installation of this kit. If the procedure is not within your capabilities or you do not have the correct tools, have a Harley-Davidson dealer perform the installation. Improper installation of this kit could result in death or serious injury. (00308a)

NOTE

This instruction sheet refers to service manual information. A service manual for this year/model motorcycle is available from a Harley-Davidson dealer.

Kit Contents

See Figure 1 and Table 1.

INSTALLATION

NOTE

For vehicles equipped with security siren:

- Verify that the Hands-Free Fob is present.

Perform the following procedures one side at a time to maintain fender alignment.

1. See Figure 1. Remove and discard one **rear** fender support screw.
2. Get a wide docking point (1), long screw (2) and docking spacer (3) from the kit.
3. Install the docking point, countersunk end (E) last as shown, onto the screw threads, followed by the spacer, large end first.

4. Apply a few drops of Loctite 243 - Blue to the first four threads of the screw.
5. Install the screw through the fender support (B) and fender (A), and into the fender rear mounting bracket (C). Tighten to 28.5–36.6 N·m (21–27 ft-lbs).
6. Remove and discard the **front** fender support screw on the same side of the vehicle.
7. Get a narrow docking point (4), short screw (5) and docking spacer (3) from the kit.
8. Install the docking point onto the screw threads, followed by the spacer, large end first.
9. Install the screw through the fender support and fender, and into the fender front mounting bracket (D). Tighten to 28.5–36.6 N·m (21–27 ft-lbs).
10. Repeat Steps 1-9 on the opposite side of the fender.

CARE AND MAINTENANCE

Docking Point Maintenance

NOTE

In time docking points may wear, causing the mating luggage rack or sideplates to become loose and rattle. The fit may be tightened using the following procedure.

1. If desired, mark each docking point to indicate the current top position.
2. Remove the docking hardware.
3. Thoroughly remove all existing threadlocking agent from the docking point fastener and mounting hole threads before applying new Loctite 243 - Blue to the screw threads.
4. Rotate the docking points clockwise approximately 45 degrees from the previous position.
5. Tighten the docking hardware to the torque value indicated in the installation procedures.

This procedure can be repeated up to three times before replacement of the docking points is recommended.



SERVICE PARTS

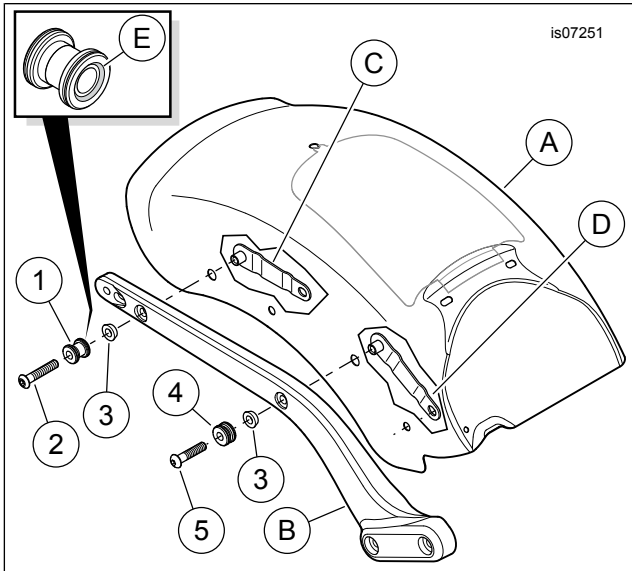

Figure 1. Service Parts, FXSBSE Docking Hardware

Table 1. Service Parts

Item	Description (Quantity)	Part Number
1	Docking point, rear (wide) (2)	53684-96A
2	Screw, hex socket button head, 3/8-16 x 51 mm (2 in) long (2)	4118
3	Spacer (4)	Not sold separately
4	Docking point, front (narrow) (2)	53967-06
5	Screw, hex socket button head, 3/8-16 x 44.5 mm (1.75 in) long, with thread locking agent (2)	4246
Items mentioned in text, but not included in kit.		
A	Rear fender	
B	Fender support (2)	
C	Fender rear mounting bracket (2)	
D	Fender front mounting bracket (2)	
E	Countersunk end of docking point	