



# INSTRUCTIONS

-J06352

2015-11-02

## XL SOLO CUSTOM SEAT KITS

### GENERAL

#### Kit Number

52000269

#### Models

For model fitment information, see the P&A Retail Catalog or the Parts and Accessories section of [www.harley-davidson.com](http://www.harley-davidson.com) (English only).

#### Kit Contents

See Figure 3 and Table 1.

#### ▲ WARNING

The rider's safety depends upon the correct installation of this kit. If the procedure is not within your capabilities or you do not have the correct tools, have a Harley-Davidson dealer perform the installation. Improper installation of this kit could result in death or serious injury. (00308a)

#### NOTE

When a solo seat is installed without a passenger seat, the passenger footpegs or footboards and the passenger grab strap must be removed.

### INSTALLATION

1. Refer to the owner's manual and follow the instructions given to remove the seat.
2. **For models that had a solo seat that uses the front hole:** Proceed to Step 2b. **For models that had a solo seat that uses the center hole:** Proceed to Step 3. **For models that had a two-up seat:** The retention nut and washer must be moved from the rearward mounting hole to the center fender hole where the rear seat bracket is attached. Use a cable strap to aid in this step:
  - a. See Figure 1. Remove retention nut from rearward fender hole (3) and plastic cap (2) from center fender hole (4).
  - b. Install plastic cap into the rearward fender hole.
  - c. See Figure 2. Place the retention nut over the cable strap so the wide end of the nut rests on the eye of the cable strap. Thread the cable strap up under the fender and through the center fender hole. Pull up on the cable strap to hold the nut snug against the underside of the fender.
  - d. With the rib of the retention nut seated into the notch in the fender hole, slide the retention washer into place from the rear. This retention washer locks the retention nut in place.

3. Position the solo seat on the frame with the mounting bracket at the rear. Bring the seat forward and engage the tab on the seat into the slot at the base of the fuel tank.
4. Apply forward pressure on the seat so bottom of the seat bucket area can be pressed down to enlarge the keyhole slot on the bottom of the seat with the retention post on the frame.
5. See Figure 3. Secure the seat to the fender using the knurled knob (3) and nylon washer (4) from the kit. Install the washer on the knob and tighten the knob securely to the fender seat nut.
6. Remove the adhesive backing from the Bar & Shield emblem (2). Install it in the recess in the knob face.
7. See the service manual. Install seat. After installing seat, pull up on the seat to verify that it is secure.

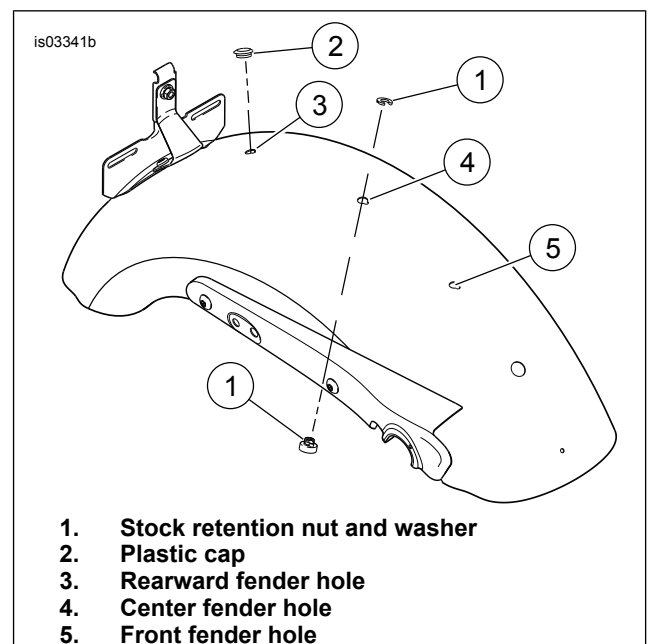

Figure 1. Retention Nut and Plastic Cap Location



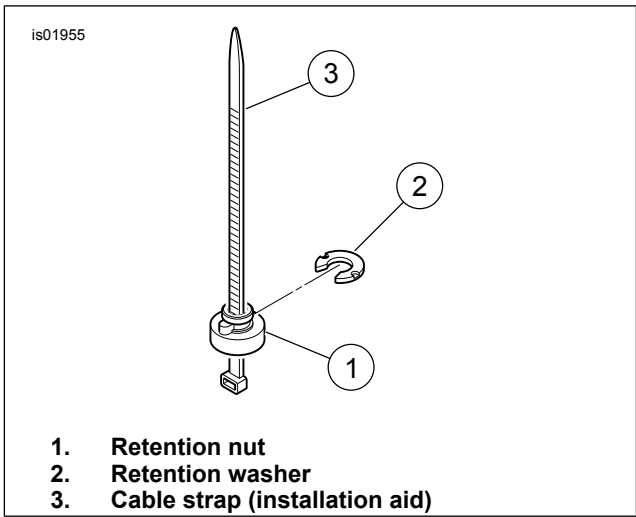

Figure 2. Retention Nut Installation

**SERVICE PARTS**

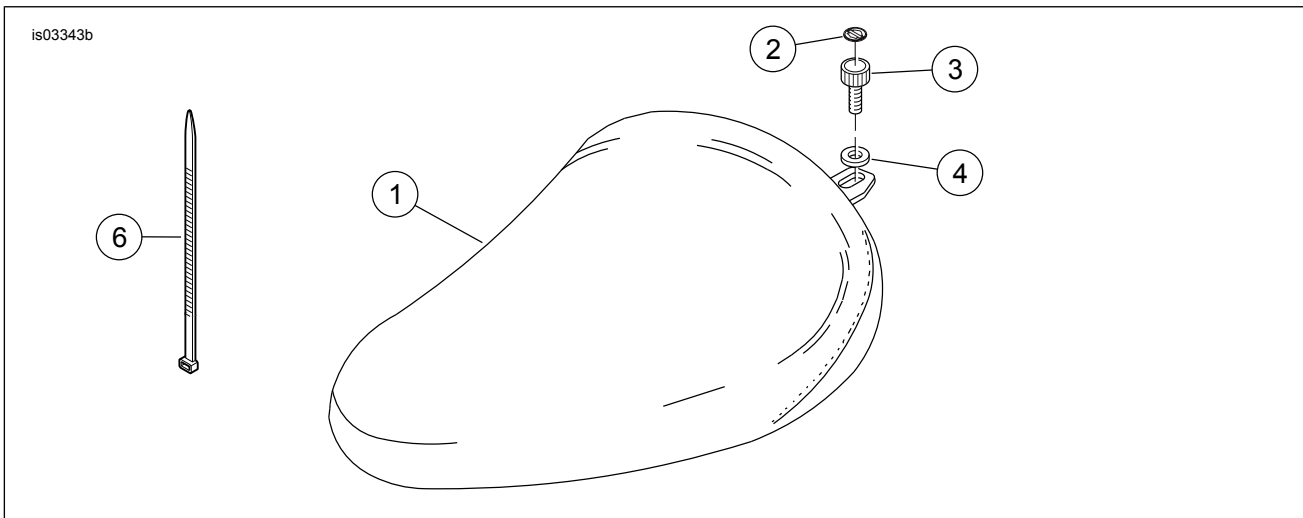

Figure 3. Service Parts for XL Solo Custom Seat Kits

Table 1. Service Parts

Item	Description (Quantity)	Part Number
1	Seat	Not Sold Separately
2	Emblem, Bar & Shield	14628-96
3	Knurled knob, 1/4-20 inch	51948-07
4	Washer, Nylon	6441
5	Leather dressing (not shown)	Not Sold Separately
6	Cable strap	10039