



INSTRUCTIONS

-J06350

2015-11-03

SOFTAIL CUSTOM SOLO SEAT KITS

GENERAL

Kit Number

52000267

Models

For model fitment information, see the P&A Retail Catalog or the Parts and Accessories section of www.harley-davidson.com (English only).

▲ WARNING

The rider's safety depends upon the correct installation of this kit. If the procedure is not within your capabilities or you do not have the correct tools, have a Harley-Davidson dealer perform the installation. Improper installation of this kit could result in death or serious injury. (00308a)

Kit Contents

See Figure 2 and Table 1.

REMOVE EXISTING SEAT

NOTE

When a solo seat is installed without a passenger seat, the passenger footpegs or footboards and the passenger grab strap must be removed.

When removing existing seat, do not scratch painted surfaces (fender, tank, and so on) with metal tab on seat.

1. Remove seat according to the Owner's Manual instructions.
2. See Figure 2 and Table 1. Install flange nuts (5) onto seat mounting studs on rear fender.
3. Remove stock grab strap and hardware.
4. Remove seat mount nut (A) and retaining ring (B) from rear seat mount hole on rear fender. Save seat mount nut and retaining ring for later use.
5. Remove plastic cap (D) from forward seat mount hole on rear fender. Save plastic cap for later use.

INSTALL CUSTOM SOLO SEAT

NOTE

When installing this kit, do not scratch painted surfaces (fender, tank, and so on) with metal tab on seat.

This seat is for solo driver use only. Do not attempt to carry a passenger with this custom solo seat installed.

1. See Figure 2 and Table 1. Install seat mount nut (A) and retaining ring (B) previously removed in forward seat mount hole on rear fender (C).
2. See Figure 1.
 - a. Place the retention nut (1) over the cable strap (3) so the wide end of the nut rests on the eye of the cable strap.
 - b. Thread the cable strap up under the fender and through the rearmost seat mounting hole.
 - c. Pull up on the cable strap to hold the nut snug against the underside of the fender.
 - d. With the rib on the retention nut seated into the notch in the fender hole, slide the retention washer (2) into place from the rear locking the retention nut in place. Remove cable strap.

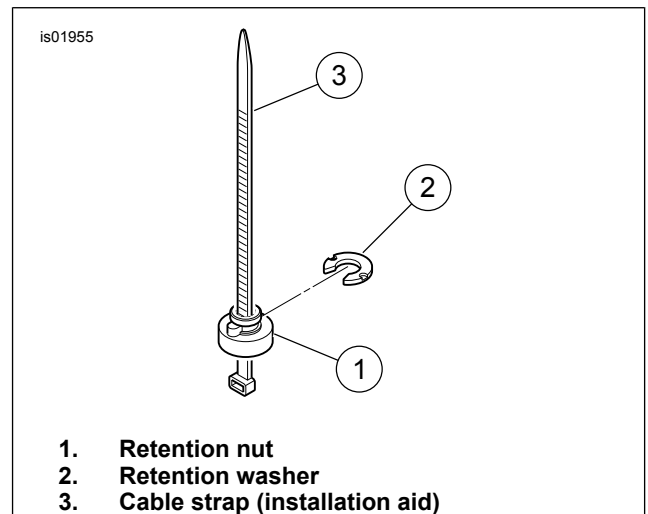

Figure 1. Retention Nut Installation

3. Install plastic cap (D) previously removed in rear seat mount hole on rear fender.
4. See the owner's manual. Install seat.
5. Secure the seat to the fender with the knurled knob (2) and washer (3) from the kit.
6. Remove adhesive backing from emblem (4) and apply emblem to the center recess on the knurled knob. Apply even pressure to the emblem for one minute.



SERVICE PARTS

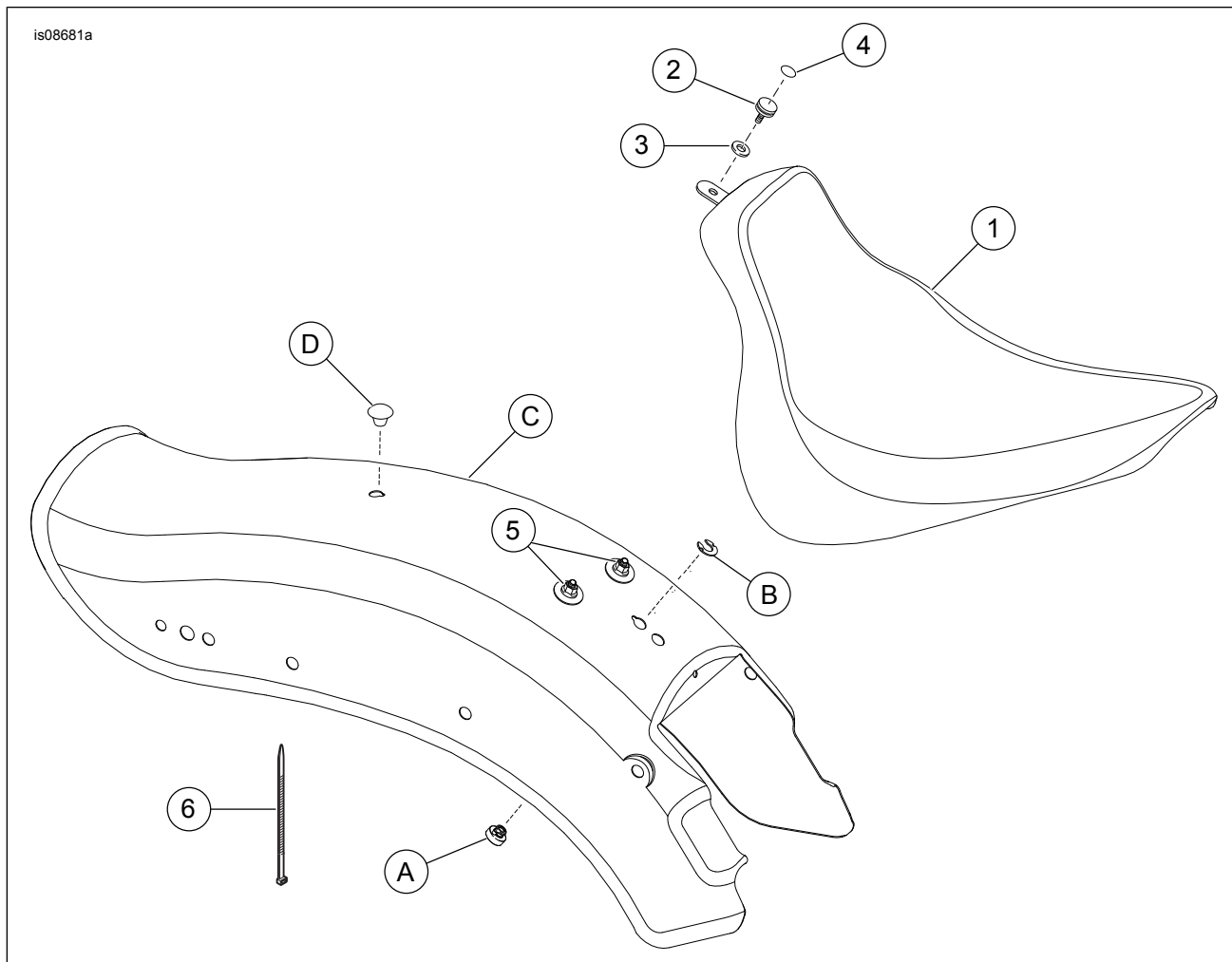

Figure 2. Service Parts: Softail Custom Solo Seat Kit

Table 1. Service Parts: Softail Custom Solo Seat Kit

| Item | Description (Quantity) | Part Number |
|--|------------------------------|---------------------|
| 1 | Solo seat | Not Sold Separately |
| 2 | Knurled knob | 51948-07 |
| 3 | Washer, nylon | 6441 |
| 4 | Emblem | 14628-96 |
| 5 | Flange nuts | 7499 |
| 6 | Cable strap | 10039 |
| - | Leather dressing (not shown) | Not Sold Separately |
| Items mentioned in text, but not included in kit: | | |
| A | Seat mount nut | |
| B | Retaining ring | |
| C | Rear fender | |
| D | Plastic cap | |