



INSTRUCTIONS

-J03777

2015-06-12

SOFTAIL SEAT KITS

GENERAL

Kit Numbers

See Table 1.

Models

For model fitment see the P&A Retail Catalog or the Parts and Accessories section of www.harley-davidson.com (English only).

Installation Requirements

FXSTC models require **EITHER** the additional purchase of a Passenger Backrest Pad **OR** the removal of the original equipment sissy bar upright.

See a Harley-Davidson dealer or the current P&A Retail Catalog for a selection of passenger backrest pads.

Kit Contents

See Figure 3 and Table 2 for complete kit contents.

See Table 1 for the grab strap part number associated with each seat kit.

Table 1. Kit Numbers and Grab Strap Usage

Kit Number	Grab Strap
51310-07	51332-07
51936-08	51910-08
51365-07	
51367-07	
51387-06A	
51398-07	
51410-08	
51411-08	
51412-08	
51414-08	
51407-08	
51418-08	
51426-08	
51431-08	
52193-08	
52000254	
51308-07	51701-06
51388-06	
51389-06	
51390-06	
51391-06	
51392-06	

▲ WARNING

The rider's safety depends upon the correct installation of this kit. If the procedure is not within your capabilities or you do not have the correct tools, have a Harley-Davidson dealer perform the installation. Improper installation of this kit could result in death or serious injury. (00308a)

INSTALLATION

NOTE

When performing the following procedures, avoid scratching painted surfaces (fender, tank, and so forth) with tools or metal seat tabs.

FXST, FXSTB, FXSTS and FLSTSB Models

1. Remove original equipment (OE) seat and mounting hardware following the instructions in the Owner's Manual.
2. Pull the seat slightly to the rear to disengage the tang at the front of the seat.
3. Lift the front of the seat while pulling the seat carefully forward to remove the seat from the vehicle.
4. Remove the OE grab strap and attaching hardware. Save the hardware for later use.
5. Install the grab strap. See either **For Kit 51936-08** or **For All Other Kits** to install the grab strap.

2007 and Later FLSTF Models

1. Remove original equipment (OE) seat and mounting hardware following the instructions in the Owner's Manual.
2. Remove and discard the OE grab strap and attaching hardware.
3. See Figure 3. Install two flange nuts (9) from the kit onto the OE grab strap mounting studs (as shown in Figure 1, Item 1).
4. Install the grab strap. See either **For Kit 51936-08** or **For All Other Kits** to install the grab strap.

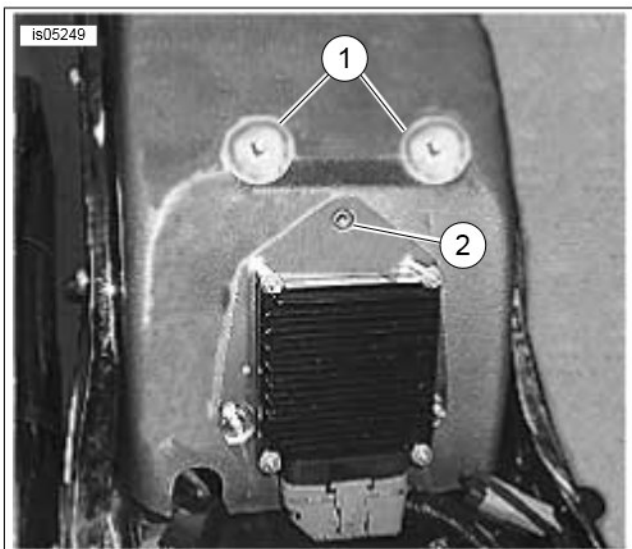

1. Flange nut stud (2)
2. Accessory seat grab strap location

Figure 1. Grab Strap and Flange Nut Installation Location (FLSTF shown)

2007 and Later FXSTC Models

1. Remove original equipment (OE) seat and mounting hardware following the instructions in the Owner's Manual.
2. Remove and discard the OE grab strap and attaching hardware.
3. Carefully remove the plug from the rearmost seat mounting position in the fender and set aside for reuse.

NOTE

The cable strap is used as an installation aid.

4. See Figure 3. Obtain the Seat Nut Kit (10) and cable strap (11) from the kit, and install the nut and washer in the rearmost seat mounting hole in the rear fender.
 - a. See Figure 2. Place the retention nut (1) over the cable strap (3) so that the wide end of the nut rests on the eye of the cable strap.
 - b. Thread the cable strap up under the fender and through the fender hole.
 - c. Pull up on the cable strap to hold the nut snug against the underside of the fender.
 - d. With the rib on the retention nut seated into the notch in the fender hole, slide the retention washer (2) into place from the rear (this locks the retention nut in place). Remove cable strap.
5. Install the grab strap. See either **For Kit 51936-08** or **For All Other Kits** to install the grab strap.

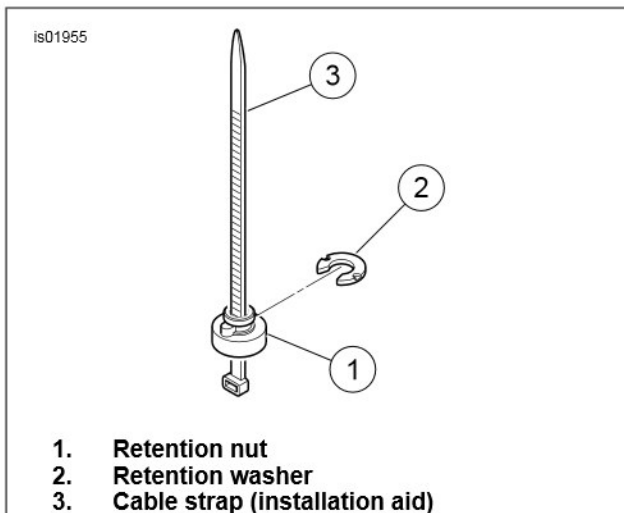

1. Retention nut
2. Retention washer
3. Cable strap (installation aid)

Figure 2. Retention Nut Installation

For Kit 51936-08

1. Wrap grab strap around seat.
2. Position seat in place, but do not install.
3. Tilt the seat slightly and install the grab strap to the accessory seat grab strap location (as shown in Figure 1) with the screw (7) and washer (8) from the kit. Tighten securely.
4. Lower the seat and slide the seat toward the front until the front tang locks into the channel in the frame.
5. Secure the seat to the fender with the knurled knob (2) and neoprene washer (3) from the kit.
6. Proceed to **Final Installation**.

For All Other Kits

1. See Figure 3. Install the grab strap (5) from the kit to the accessory seat grab strap location (as shown in Figure 1) with the screw (7) and washer (8) from the kit.
2. Slide the rear of the **new** seat (1) through the grab strap.
3. Rest the seat on the frame backbone.
4. Slide the seat toward the front until the front tang locks into the channel in the frame.
5. Secure the seat to the fender with the knurled knob (2) and neoprene washer (3) from the kit.
6. Proceed to **Final Installation**.

Final Installation

1. It may be necessary to trim away portions of the protective tape applied at the factory to the fender underneath the passenger pillion. **If any areas of the protective tape remain exposed after the new seat is in place: If no protective tape remains exposed:**
 - a. Mark those areas lightly with a wax pencil or water-based marker.
 - b. Remove seat.
 - c. Peel up the sections of protective tape to be trimmed. Cut away the excess tape. Do not damage the fender paint.
 - d. Reapply the protective tape to the rear fender. Press firmly into place.

NOTE

Ambient temperature of **at least 60°F (16°C)** for proper adhesion of the emblem to the knob.

- e. Refasten the seat to the fender with the knurled knob and neoprene washer.

▲ WARNING

After installing seat, pull upward on seat to be sure it is locked in position. While riding, a loose seat can shift causing loss of control, which could result in death or serious injury. (00070b)

- 2. See Figure 3. Remove the liner from the adhesive backing of the Bar & Shield emblem (4). Rotate the emblem for best appearance, and apply the emblem to the center recess on the knurled knob. Apply even pressure to the emblem for one minute to verify proper adhesion.

SERVICE PARTS

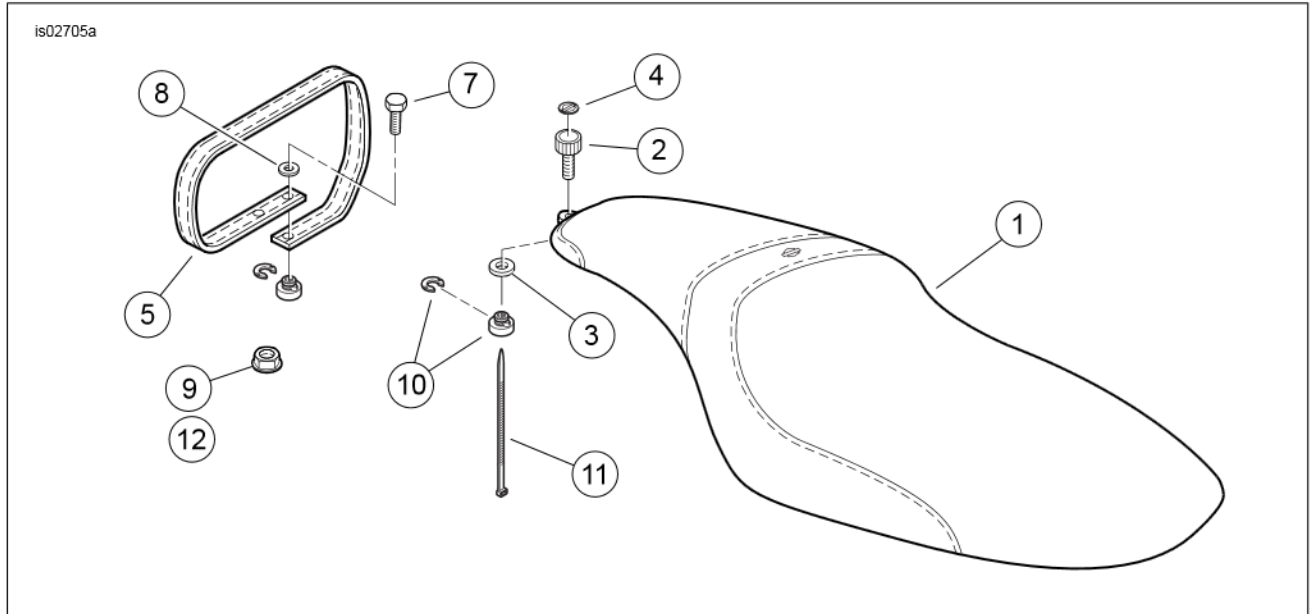

Figure 3. Service Parts, Softail Custom Seats

Table 2. Service Parts Table

Kit	Item	Description (Quantity)	Part Number
Common items for ALL seat kits	1	Seat (plain pattern shown)	Not sold separately
	2	Knurled knob, 1/4-20	3649
	3	Washer, neoprene	6205
	4	Emblem, Bar & Shield	14628-96
	5	Grab strap	See Table 1
	6	Leather dressing (not shown)	Not sold separately
Additional Contents for: Kit 51308-07** Kit 51310-07** Kit 51365-07* Kit 51367-07* Kit 51387-06A* Kit 51388-06 Kit 51389-06 Kit 51390-06 Kit 51391-06 Kit 51392-06 Kit 51398-07* Kit 51407-08* Kit 51410-08* Kit 51411-08* Kit 51412-08* Kit 51414-08* Kit 51936-08 Kit 51418-08 Kit 51426-08 Kit 51431-08 Kit 52193-08* Kit 52000254*	7	Cap screw, hex head, 1/4-20 x 5/8 in.	3767B
	8	Flat washer	6036
	9	Nut, top lock, flanged, 1/4-20 (2) (included with kits marked *)	7499
	10	Seat Nut Kit	59768-97
	11	Cable strap (installation aid)	10039
	12	Flange nut (2) (included with kits marked **)	8021
	* Includes nut (Item 9)		
	** Includes nut (Item 12)		

