



# INSTRUCTIONS

-J04700

REV. 2008-04-07

## SPRING SEAT HARDWARE KIT

### GENERAL

#### Kit Number

51902-09

#### Models

For model fitment information, please see the P&A Retail Catalog or the Parts and Accessories section of [www.harley-davidson.com](http://www.harley-davidson.com) (English only).

#### Additional Parts Required

A spring seat is available for separate purchase. See the P&A Retail Catalog or the Parts and Accessories section of [www.harley-davidson.com](http://www.harley-davidson.com) (English only).

### WARNING

The rider's safety depends upon the correct installation of this kit. If the procedure is not within your capabilities or you do not have the correct tools, have a Harley-Davidson dealer perform the installation. Improper installation of this kit could result in death or serious injury. (00308a)

#### NOTE

This instruction sheet references Service Manual information. A Service Manual for your model motorcycle is required for this installation and is available from a Harley-Davidson Dealer.

#### Kit Contents

See Figure 5 and Table 1.

### REMOVAL

Remove stock seat following the instructions in the appropriate Service Manual.

### INSTALLATION

#### Install Seat

1. See Figure 5. On a workbench, insert pivot bushing (11) into frame mounting pivot bracket (19). Install two bushings (15) into the ends of the frame mounting pivot.
2. Install frame pivot mounting bracket (19) to frame with screws (1) in mounting holes (Figure 1, item 3). Tighten to 90-110 **in-lbs** (10-12 Nm).
3. Remove rear tail lamp connector (Figure 1, item 2) from T-stud. Disconnect connector halves.
4. Remove all T-studs from the fuse block bracket with a side cutter or equivalent tool.
5. Install spring seat support (20) to the bottom of the seat with two bolts (4). Tighten finger-tight.

6. Install seat hinge (14) to seat bottom with bolt (7), washer (9) and locknut (10). Tighten to 20-25 ft-lbs (27-34 Nm).
7. On a workbench, install springs (16) to spring seat support bracket (20) with screws (3) and washers (8). Tighten to 14-16 ft-lbs (19-22 Nm). Install spring bushings (12).
8. Install spring base seat bracket (18) to the fuse block bracket with screws (6). Tighten to 96-120 **in-lbs** (11-14 Nm).
9. Connect the rear tail lamp connector halves and install the connector onto the T-stud.
10. Install frame fairing (17) to the frame with screw (2) in mounting hole (Figure 1, item 1). Ensure the front tang is engaged under the frame mount pivot bracket.
11. Align seat hinge (14) with pivot mounting bracket.
12. Insert screw (5) and washer (9) into seat hinge from the right side of vehicle. Tighten to 14-16 ft-lbs (19.0-21.7 Nm).
13. See Figure 2. Align the bushings on the seat springs (1) with the seat mounting pins (2). Push rear of seat down firmly to engage the seat spring mounting pins.

### WARNING

After installing seat, pull upward on seat to be sure it is locked in position. While riding, a loose seat can shift causing loss of control, which could result in death or serious injury. (00070b)

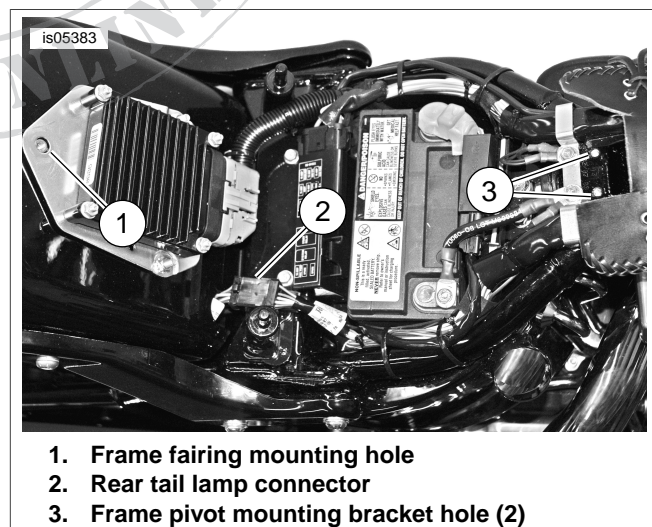

Figure 1. Install Spring Seat

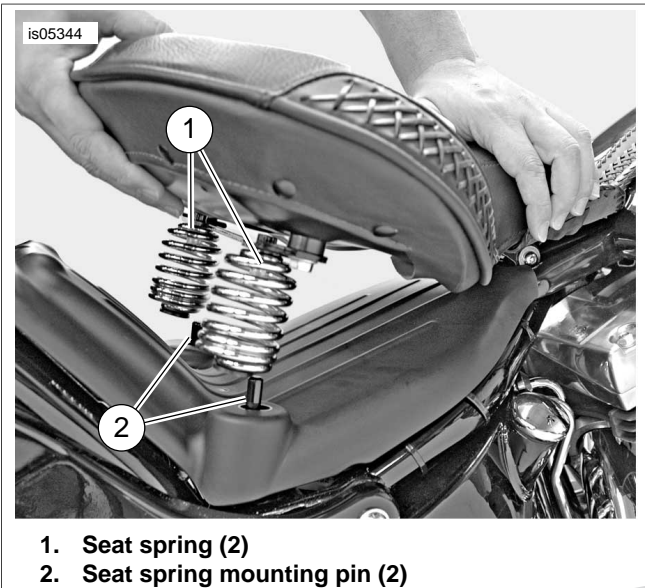

Figure 2. Seat Springs and Mounting Pins

### Adjusting Seat Position

**NOTE**

Seat position may be adjusted forward or rearward for rider comfort.

1. Remove the seat.
2. See Figure 3. Remove the nut (2) from the seat hinge (1).
3. Remove the bolts (5) from the seat spring support bracket (4).

**NOTE**

See Figure 4. The seat hinge and seat spring support bracket must be installed in the same position (forward or rearward configuration) for the seat to fit properly on the vehicle.

4. See Figure 4.
  - Position Seat in Forward Configuration:**
    - a. Install hinge with the front tab (2) in the slot.
    - b. Install the seat spring support bracket with springs toward the rear of seat (3).
  - Position Seat in Rearward Configuration:**
    - a. Install hinge with the rear tab (5) in the slot.
    - b. Install the seat spring support bracket with springs toward the front of seat (6).
5. See Figure 3. Install nut (2) on seat hinge (1) and tighten to 20-25 ft-lbs (27.1-33.9 Nm).
6. Install screws (5) for seat spring support bracket (4). Tighten to 15-20 ft-lbs (20.3-27.1 Nm).
7. Install the seat following steps in the Install Seat section.

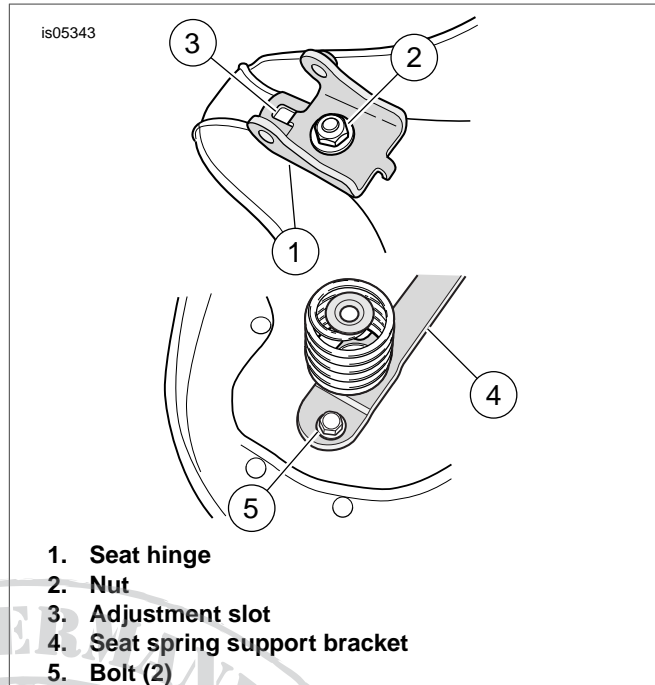

Figure 3. Seat Adjustment

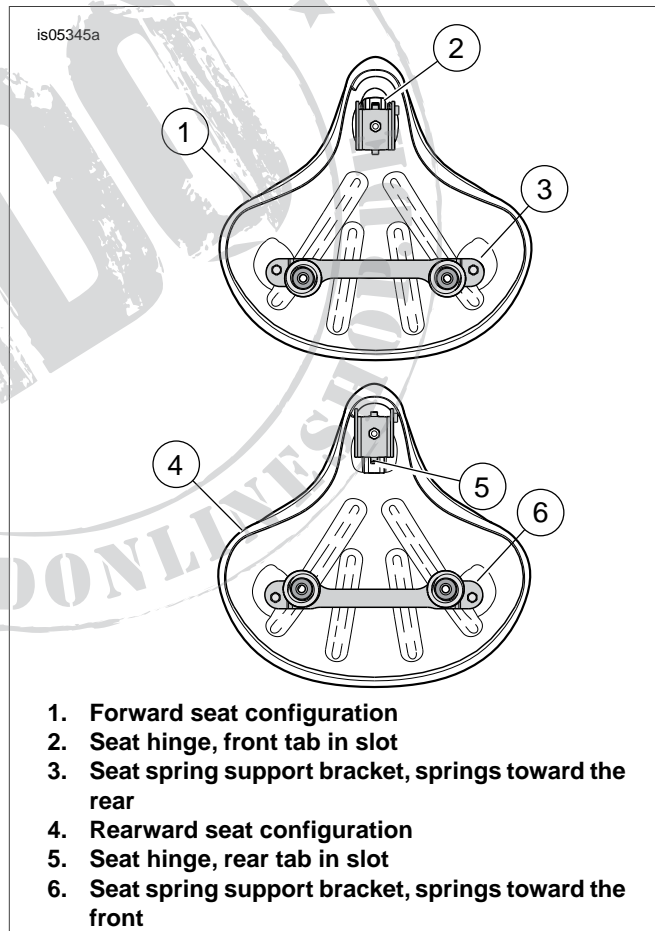
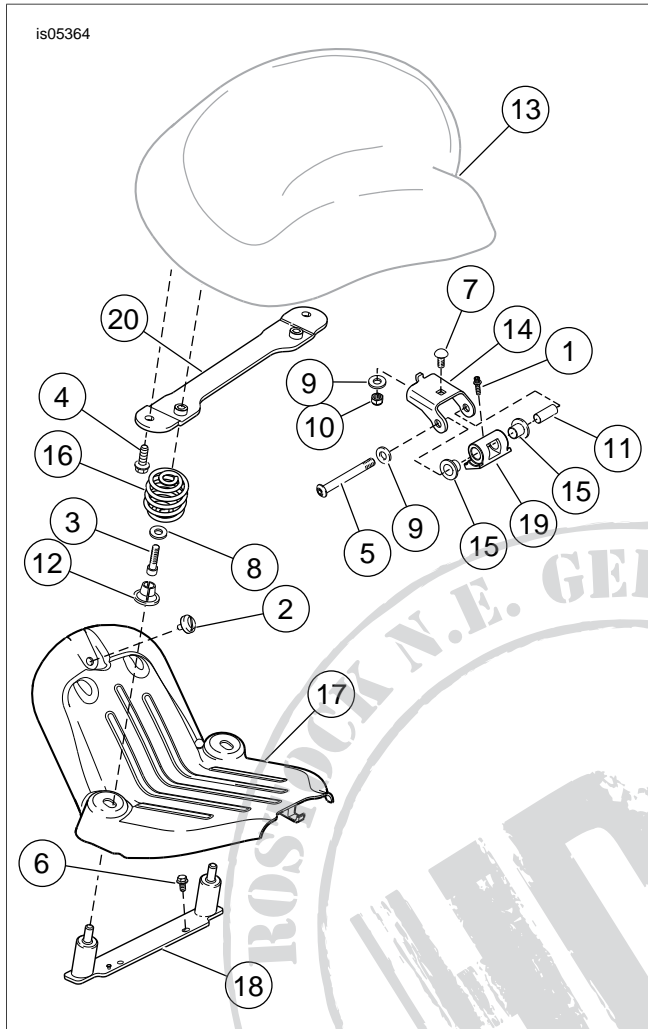

Figure 4. Seat Configurations

# SERVICE PARTS

Table 1. Service Parts Table



Item	Description (Quantity)	Part Number
1	Screw (2)	3061
2	Screw	3075
3	Screw (2)	3275
4	Bolt (2)	3487
5	Screw	3584
6	Screw (2)	3588
7	Bolt	5418
8	Washer (2)	6116
9	Washer (2)	6400HB
10	Locknut	7667
11	Bushing, pivot	9725
12	Bushing, spring (2)	11250
13	Seat assembly, solo	Purchased Separately
14	Hinge, seat	51482-08
15	Bushing (2)	52253-08
16	Spring, seat (2)	52254-08
17	Fairing, frame	52257-08
18	Bracket, spring base seat	52258-08
19	Bracket, frame mounting pivot	52264-08
20	Bracket, spring seat support	52330-08

Figure 5. Service Parts: Spring Seat Kit