



INSTRUCTIONS

-J01539

REV. 2006-10-09

FXSTD PASSENGER BACKREST AND LUGGAGE RACK

GENERAL

Kit Number

51114-00, 51144-02, 51534-02, 52549-00, 53806-00, 52050-00

Models

For model fitment information, please see the P&A Retail Catalog or the Parts and Accessories section of www.harley-davidson.com (English only).

NOTE

A Service Manual for your model motorcycle is available from a Harley-Davidson Dealer.

Kit Contents

See Figure 2 and Table 1.

NOTE

Maximum luggage rack weight capacity is 7 pounds (3.2 Kg).

WARNING

Do not exceed luggage rack weight capacity. Too much weight can cause loss of control, which could result in death or serious injury. (00373a)

INSTALLATION

Passenger Upright

1. Unscrew the captive screw fastening the seat rear bracket to the fender.
2. Remove the rubber plugs from the three holes in the rear fender where the passenger upright installs.
3. See Figure 2. Fasten the studplate (2) to the fender (A) with the backing plate (3) and three flange locknuts (4).
4. See Figure 1. Fasten the passenger upright (3) to the studplate (1) with three flange locknuts (2).
5. Insert the seat front bracket into the frame, then fasten the seat rear bracket to the fender.

NOTE

The seat must be temporarily bowed up in the center to fit the seat rear bracket through the slot in the passenger upright.

6. **Kit 51144-02 only.** See Figure 2. Carefully clean the lower hole (B) on the passenger upright (1) with isopropyl alcohol to remove any grease or dirt. Remove backing from adhesive emblem (5) and press the emblem firmly in to place.

WARNING

After installing seat, pull upward on seat to be sure it is locked in position. While riding, a loose seat can shift causing loss of control, which could result in death or serious injury. (00070b)

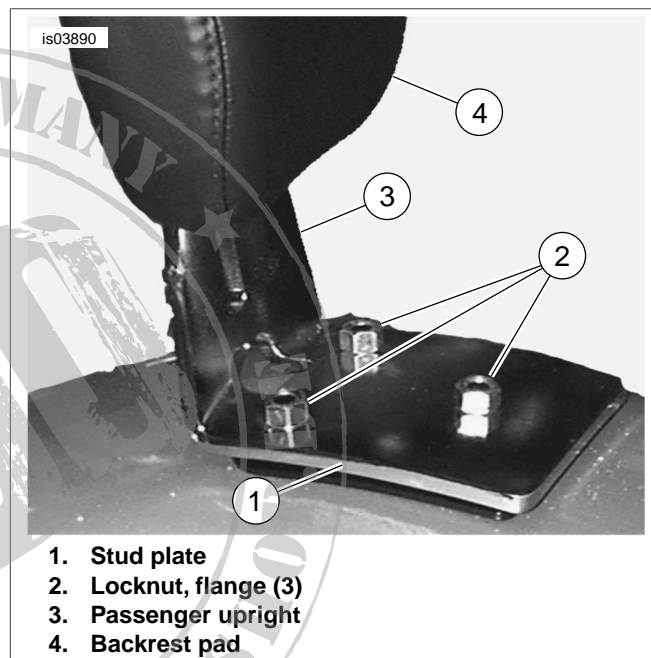

Figure 1. Passenger Upright, Backrest Pad and Luggage Rack Installation

NOTE

When temporarily removing the passenger upright, the mounting and backing plates may be left in place to simplify passenger-upright re-installation. Thread the flange nuts back onto studs to store the nuts.

WARNING

After installing seat, pull upward on seat to be sure it is locked in position. While riding, a loose seat can shift causing loss of control, which could result in death or serious injury. (00070b)

Backrest Pad

See Figure 2. Fasten the backrest pad (7) to the passenger upright (1) using the button-head screw (6) as shown.

Luggage Rack

NOTE

See Figure 2. Fasten the luggage rack (8) to the backrest with the backrest pad (7) removed from the studplate (2).

Fasten the luggage rack (8) to the passenger upright (1) using the luggage-rack mounting plate (11), button-head screw (12),

washer (10), and locknut (9) as shown.

SERVICE PARTS

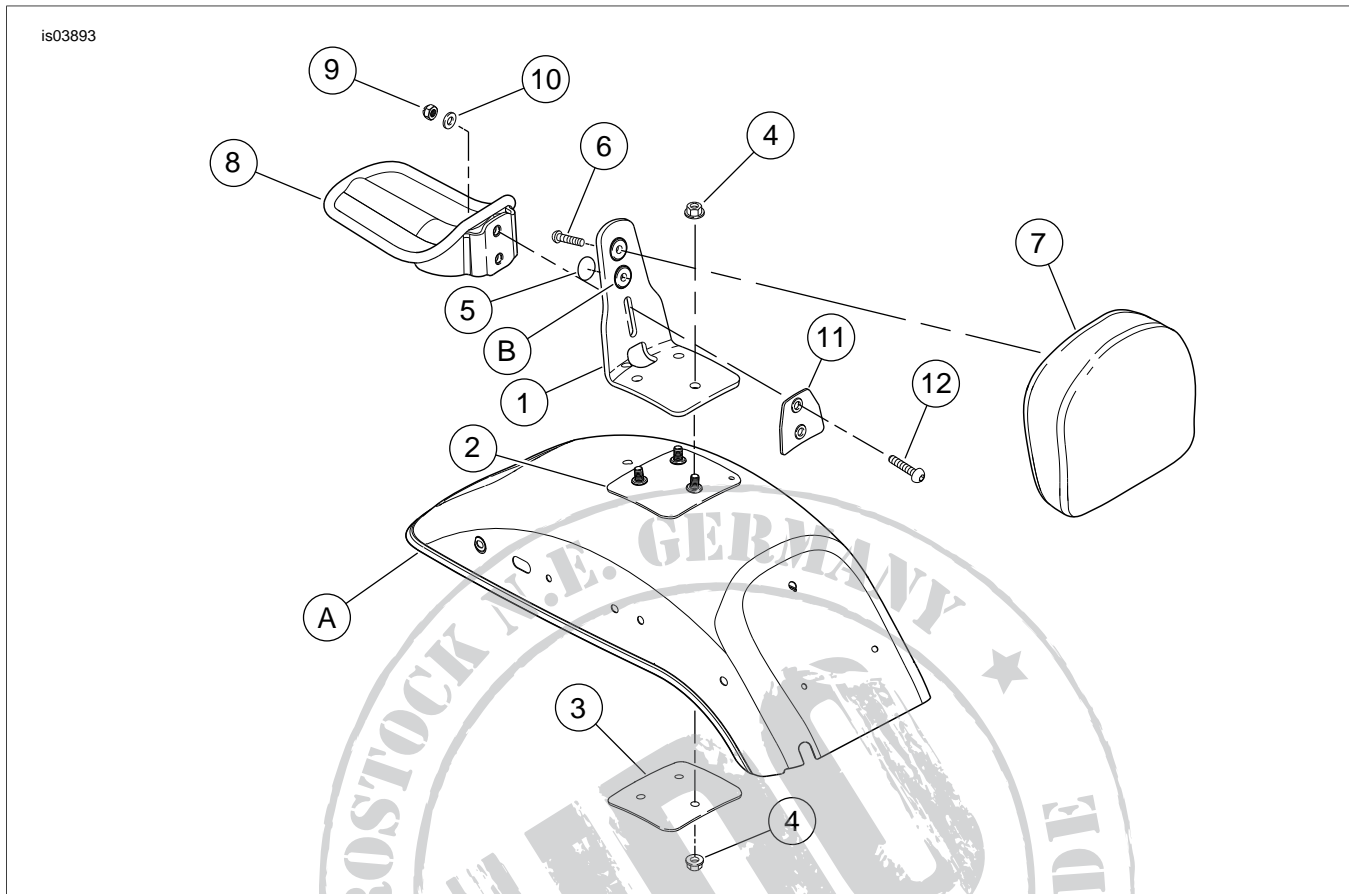

Figure 2. Service Parts: FXSTD Backrest and Luggage Rack

Table 1. Service Parts Table

Kit	Item	Description (Quantity)	Part Number
Kit 51114-00 and 51144-02	1	Passenger upright	Not sold separately
	2	Stud plate	Not sold separately
	3	Backing plate	Not sold separately
	4	Flange locknut (6)	7601
	5	Emblem (kit 51144-02 only)	14448-94
Kit 51534-00, 52549-00 and 52050-00	6	Screw, button head, 5/16-18 x 3/4 inch	94393-92T
	7	Backrest pad	Not sold separately
Kit 53806-00	8	Luggage rack	Not sold separately
	9	Locknut (2)	7778
	10	Washer (2)	6701
	11	Luggage rack mounting plate	53808-00
	12	Screw, button head (2)	4098
Items mentioned in text, but not included in kit:			
	A	Rear fender	
	B	Note: Lower hole found only in kit 51144-02	