



INSTRUCTIONS

-J02157

REV. 2006-12-01

SISSY BAR UPRIGHT KITS (MINI OR LOW)

GENERAL

Kit Number

51124-01A, 51126-01A, 51145-04, 51150-04A, 51177-06, 51162-06, 51313-07

Kit Contents

See Figure 2, Figure 3 and Table 2.

Additional Parts Required

In addition to the kit components, separate purchase of fender baseplates is required. See Table 1 for information on the correct base plate kit requirements. Base plate kits are available from a Harley-Davidson dealer.

Table 1. Required Fender Baseplate

Kit Number	Base Plate
51124-01A (chrome, mini)	51120-01A (chrome) 51140-04A (gloss black)
51126-01A (chrome, low)	51120-01A (chrome) 51140-04A (gloss black)
51145-04A (gloss black, low)	51120-01A (chrome) 51140-04A (gloss black)
51150-04A (gloss black, mini)	51120-01A (chrome) 51140-04A (gloss black)
51162-06 (chrome, low)	51098-06 (chrome) 51156-06 (chrome) 51120-07 (chrome) 51138-07 (chrome) 51220-07 (gloss black)
51177-06 (chrome, mini)	51098-06 (chrome) 51156-06 (chrome) 51120-07 (chrome) 51138-07 (chrome) 51220-07 (gloss black)
51313-07 (gloss black, low)	51098-06 (chrome) 51156-06 (chrome) 51120-07 (chrome) 51138-07 (chrome) 51220-07 (gloss black)

INSTALLATION

NOTE

It is not necessary to remove the seat or pillion to install these sissy bar upright kits.

1. If necessary, install Baseplate Kit following instructions included with kit.

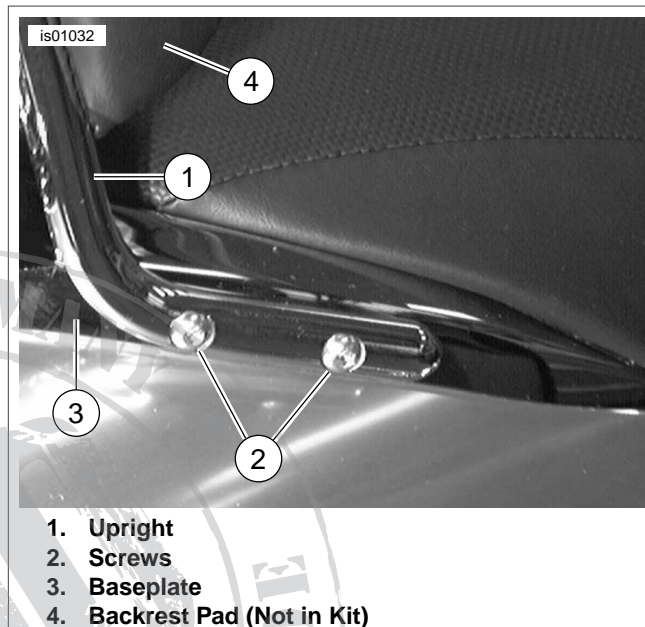

Figure 1. Install Upright to Baseplate (Right Side of Low Upright Shown)

2. See Figure 1. Obtain the four button head cap screws (2) and the upright (1).
3. Using screws from kit, attach the left and right sides of the upright to the left and right sides of the baseplate.
4. Tighten screws to 10 Nm (7.4 ft-lbs).

SERVICE PARTS

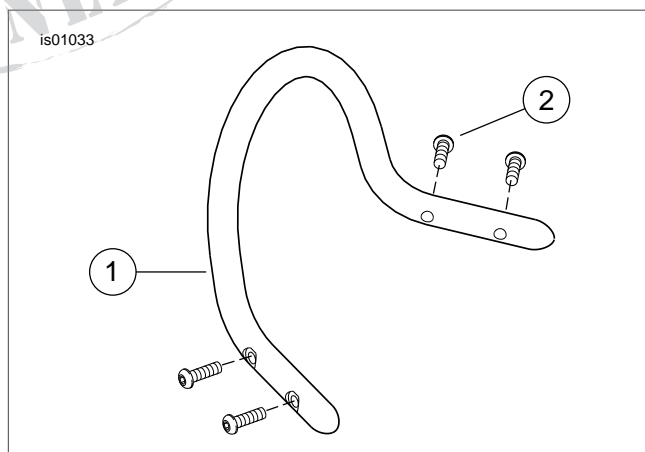

Figure 2. Service Parts: Upright Kit (Mini shown)

is01035

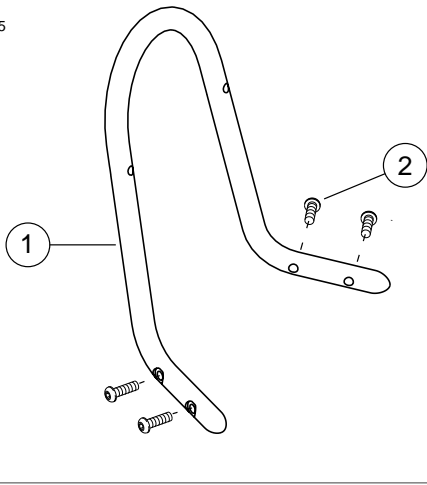

Table 2. Service Parts: All Models

Item	Description (Quantity)	Part Number
1	Upright	Not Sold Separately
2	Screw, M6-1 x 25 mm (4)	4474M

Figure 3. Service Parts: Upright Kit (Low upright shown)

