



INSTRUCTIONS

-J05741

2013-05-30

PASSENGER FOOTPEG KIT

GENERAL

Kit Number

50500270

Models

For model fitment information, see the P&A Retail Catalog or the Parts and Accessories section of www.harley-davidson.com (English only).

Kit Contents

See Figure 1 and Table 1.

INSTALLATION

Right Side

1. See the Service Parts illustration. Remove and discard the black plastic hole plugs in the frame.
2. See the service manual. Remove the rear master cylinder. Remove and discard bracket. Save screws for installation of new bracket.
3. Obtain the right-side passenger support bracket (6) and one screw (1) from the kit. Install the bracket to the frame and tighten the three screws to 61–68 N·m (45–50 ft-lbs).

NOTE

The spring clip goes between the jaws of the passenger support bracket along with the mounting end of the footpeg.

NOTE

Footpegs must be installed in the bracket with the rounded side of the mounting end inboard. When footpegs are properly installed, footpegs will fold upward at a 45° angle toward the rear of the motorcycle.

4. See the service manual. Install the rear master cylinder.

▲ WARNING

Footrests must fold up and toward rear of motorcycle if struck. Failure to set footrests to fold up and back could result in death or serious injury. (00366a)

5. Install a passenger footpeg (2) on the passenger support bracket as shown using a clevis pin (4), spring clip (5), and retaining ring (3) from the kit.

Left Side

1. Remove and discard the screw retaining the double-tube rear brake line clamp. Remove and discard the black plastic hole plug in the lower hole.
2. Obtain the left-side passenger support bracket and two new screws (1) from the kit. Install the bracket over the rear brake line clamp. Tighten the two screws to 61–68 N·m (45–50 ft-lbs).
3. Repeat step 3 for left-side footpeg.

SERVICE PARTS

See Figure 1 and Table 1.

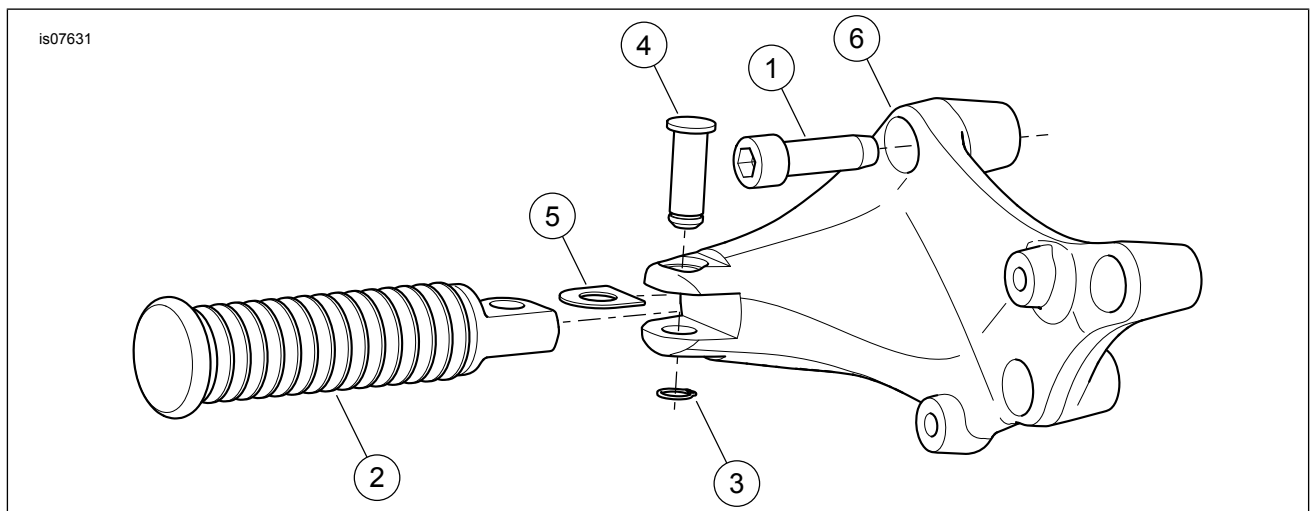

Figure 1. Service Parts: Passenger Footpeg Mounting Kit



Table 1. Service Parts Table

Item	Description (Quantity)	Part Number
1	Screw (3)	3214
2	Passenger peg assembly (2)	33048-72
3	Retaining ring (2)	11304
4	Clevis (2)	45041-0A
5	Spring clip (2)	50912-72
6	Passenger support bracket, right side (shown)	50500233
	Passenger support bracket, left side (not shown)	49315-04