



INSTRUCTIONS

-J04207

REV. 2007-05-15

STREAMLINER FOOTPEG KIT

GENERAL

Kit Number

50211-04

Models

For model fitment information, please see the P&A Retail Catalog or the Parts and Accessories section of www.harley-davidson.com (English only).

Kit Contents

See Figure 2 and Table 1.

INSTALLATION

1. Remove the hardware fastening the stock footpeg to the motorcycle footpeg support. Save the hardware for installation.
2. Remove the stock footpeg and spring washer from the motorcycle footpeg support. Note the orientation of, and save, the spring washer for installation.

NOTE

See Figure 2. When installing the footpeg-support mount (1) on the motorcycle footpeg support, the rounded edge of the footpeg-support mount must be positioned upward.

When installing the spring washer, position the spring washer with the square edge toward the inside of the footpeg support.

3. Slide a new footpeg mount and stock spring washer into the footpeg support.
4. Install the new footpeg mount in reverse order of stock footpeg mount removal. On vehicles with a nut and bolt on the footpeg support, tighten the fastener to 19 ft-lbs (26 Nm).

NOTE

See Figure 2. When replacing the footpeg support mount (1), either replace the screw (4), or apply Loctite 243 (blue) to the threads on the removed screws before re-installing the screws.

5. Assemble footpeg (2) and footpeg pad (3) onto footpeg mount (1). Install the adjusting screw through the peg and into the mount. Rotate the footpeg assembly to the desired position.
6. Tighten the adjusting screw to 21 ft-lbs (29 Nm).
7. Repeat Steps 1 through 6 for the other footpeg.

WARNING

Footrests must fold up and toward rear of motorcycle if struck. Failure to set footrests to fold up and back could result in death or serious injury. (00366a)

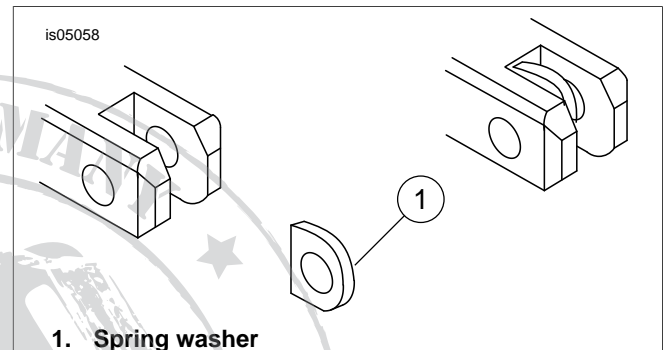

Figure 1. Footpeg Spring Washer Installation

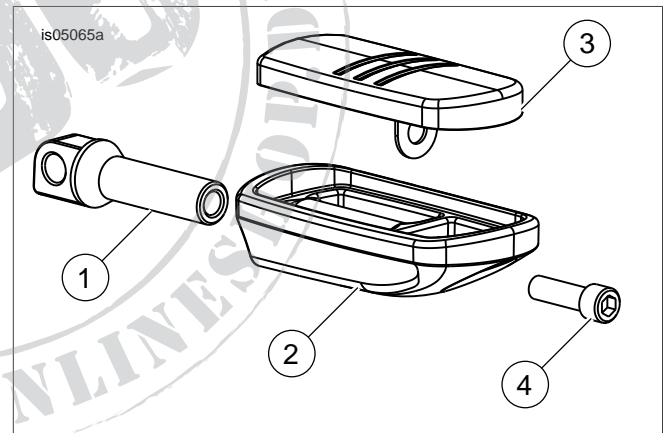

Figure 2. Service Parts: Streamliner Footpeg Kit

Table 1. Service Parts Table

Item	Description (Quantity)	Part Number
1	Mount, footpeg support (2)	50208-04
2	Passenger footpeg (2)	50345-04
3	Pad, passenger footpeg (2)	50350-04
4	Screw, hex socket head cap (2)	2708A