



INSTRUCTIONS

-J05162

REV. 2010-06-07

JIFFY STAND EXTENSION KIT

GENERAL

Kit Number

50000008

Models

For model fitment information, see the P&A Retail Catalog or the Parts and Accessories section of www.harley-davidson.com (English only).

Additional Parts Required

Proper installation of this kit requires the use of a drill and various drill bits.

Kit Contents

See Figure 1 and Table 1.

INSTALLATION

1. See Figure 1. Align extension (3) on top of the jiffy stand toe bracket (A). Mark the center of the hole location.

WARNING

Wear safety glasses or goggles while drilling. Flying debris could result in serious eye injury. (00565b)

2. Drill jiffy stand extension mounting hole into the toe bracket of the jiffy stand as follows:
 - a. Use a center punch to create a drill point at the marked location.
 - b. Use a 1/8-inch (3.0 mm) drill bit and drill a pilot hole at the marked location.
 - c. Use an 9/32-inch (7.0 mm) drill bit to drill through the pilot hole and enlarge the hole.
 - d. Remove any burrs left on the drilled hole.

3. See Figure 1. Place extension (3) over jiffy stand toe bracket (A). Fasten extension to the toe bracket with screw (1), washers (2) and nut (4) as shown. Tighten to 6-8 ft-lbs (8.1-10.8 Nm).

SERVICE PARTS

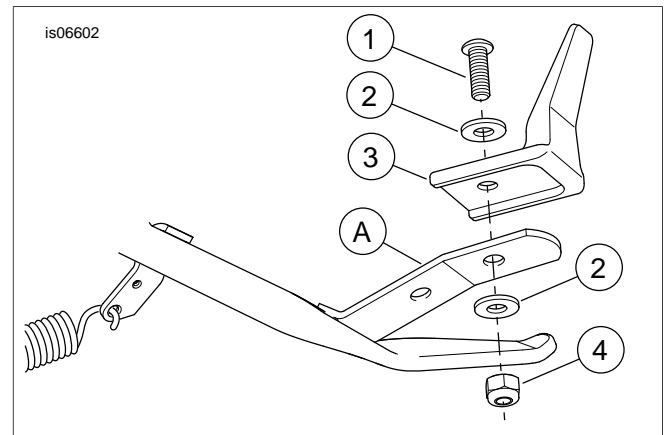

Figure 1. Service Parts: Jiffy Stand Extension

Table 1. Service Parts

Item	Description (Quantity)	Part Number
1	Screw	94386-92T
2	Washer, chrome (2)	94065-90T
3	Extension	Not Sold Separately
4	Locknut	94026-92T
Items mentioned in text, but not included in kit.		
A	Jiffy stand toe bracket	