



# INSTRUCTIONS

-J01538

REV. 2011-08-19

## ENGINE GUARD KITS

### GENERAL

#### Kit Number

49024-02, 49078-04, 49200-07A

#### Models

For model fitment information, see the P&A Retail Catalog or the Parts and Accessories section of [www.harley-davidson.com](http://www.harley-davidson.com) (English only).

#### NOTE

*These kits will not fit models equipped with Oil Cooler Part Number 26136-05.*

#### Kit Contents

See Figure 6 and Table 1.

### WARNING

The front and/or rear guard(s) can provide limited leg and cosmetic vehicle protection under unique circumstances. (Fall over while stopped, very slow speed slide.) It is not made or intended to provide protection from bodily injury in a collision with another vehicle or any other object. (00022a)

### INSTALLATION

#### FXSTD models only:

- See Figure 5. Remove the clutch cable (2) from the clamp (1) on the downtube.
- Position the engine guard between the front of the downtubes and behind the clutch cable.

#### All Models

1. See Figure 1. Check the position of the clutch cable clip (4). The clip should extend outboard. If it does not, rotate the clip 180 degrees as follows:
  - a. Open clutch cable clip (4) on left downtube (2) and remove the clutch cable (5) from the clip.
  - b. Loosen the screw holding the clutch cable clip.
  - c. Rotate the clip 180 degrees.
  - d. Tighten the clutch cable clip screw.
  - e. Install clutch cable back into the clutch cable clip.

#### NOTE

*See Figure 1. When installing engine guard on models with ABS brakes, route the brake line (1) outboard of the frame tube and behind the engine guard (3) as shown. Rotate the brake line retaining clips (6) as shown to allow proper brake line routing.*

2. See Figure 2 and Figure 3. Align the top center mounting plate with the frame cross brace, located between the front downtubes.

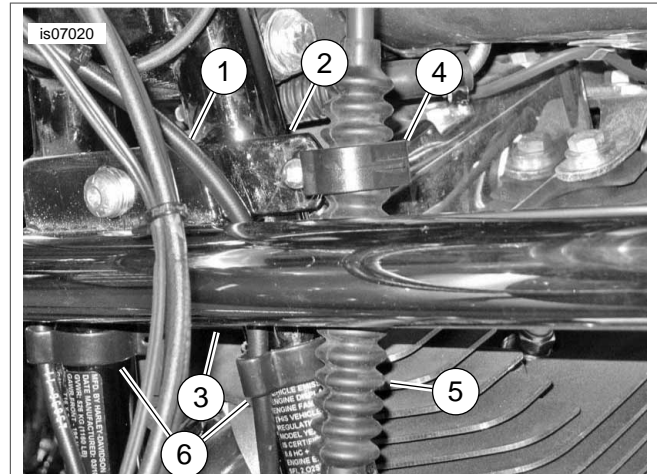

1. ABS brake line
2. Down tube
3. Engine guard
4. Clutch cable clip
5. Clutch cable
6. Brake line clip

Figure 1. Brake Line and Clutch Cable Routing



Figure 2. Engine Guard Installed

3. Fasten the mounting plate to the cross brace with screw (3), washer (2), and hex nut (1) as shown. Do not tighten.

- See Figure 6. Install the left side engine guard (1) with a screw (7), washer (6), and locknut (5). Do not tighten.

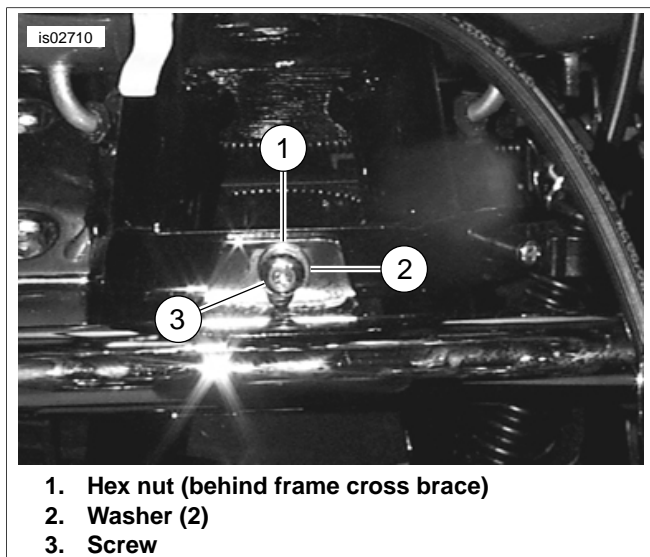

Figure 3. Engine Guard Mounting Plate (Top Center)

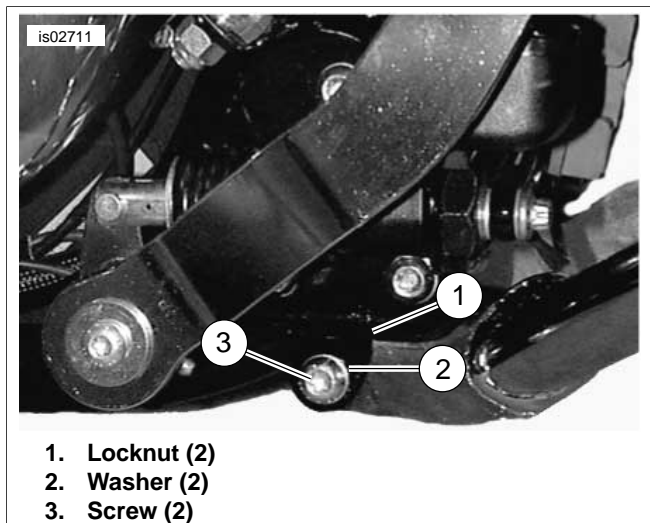

Figure 4. Engine Guard Lower Mounting (Right Side View)

- See Figure 4. Repeat Step 4 for the right side.
- Tighten the right side screw to 33 ft-lbs (44 Nm). Repeat for the left side.
- Tighten the engine guard top center mounting hardware to 19 ft-lbs (25 Nm).
- FXSTD models only:** See Figure 5. Remove and discard stock clamp (1). Fasten the clutch cable (2) to the down-tube and engine guard with the two cable straps (3) from the kit.

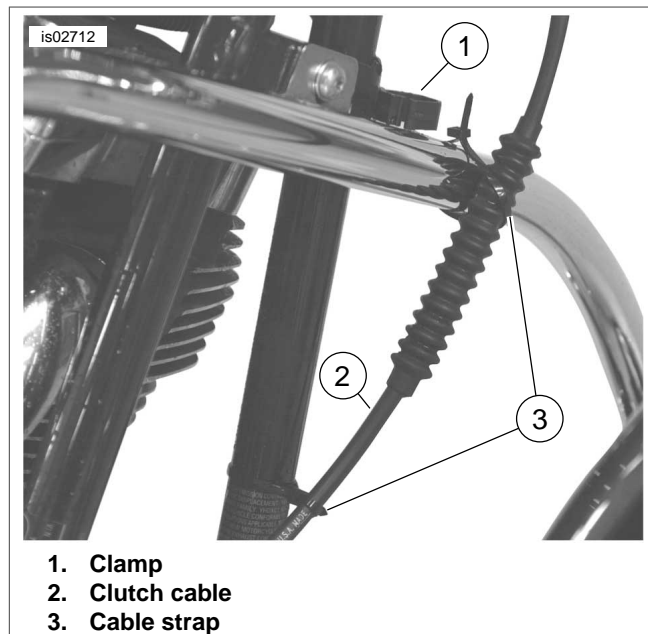
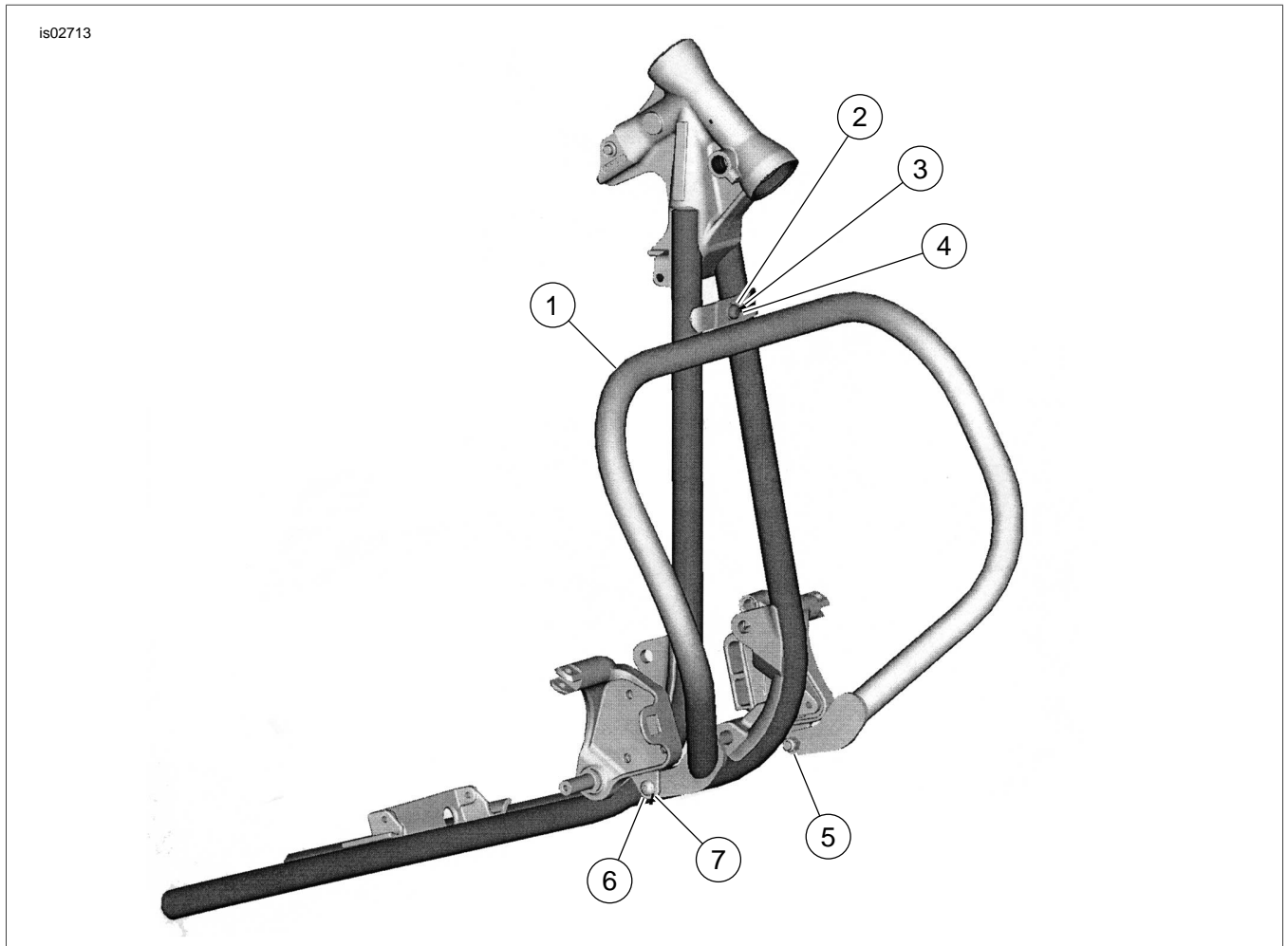

Figure 5. FXSTD Clutch Cable and Cable Strap



# SERVICE PARTS

is02713



**Figure 6. Service Parts: Engine Guard**

**Table 1. Service Parts: Engine Guard**

Item	Description (Quantity)	Part Number
1	Engine guard	Not Sold Separately
2	Hex nut, 5/16 inch	7748W
3	Washer, 5/16 inch (2)	6702
4	Screw, pan head	3655A
5	Locknut, nylon, 3/8-16 (2)	7778
6	Washer, 3/8 inch (2)	6812
7	Screw, buttonhead (2)	4188
	Screw, buttonhead (2) (Kit 49078-04 only)	4459
8	Cable strap (2), (FXSTD only) (not shown)	10081