



INSTRUCTIONS

-J00178

REV. 5-1-95

Kit Number 49149-84A

O-RING SHIFTER PEDAL

General

This kit is designed for all Harley-Davidson model motorcycles.

Kit contents:	ITEM	QTY	DESCRIPTION
	1	1	Cap
	2	1	Bolt, 5/16 - 24 x 1-3/4
	3	1	Bolt, 5/16 - 24 x 2
	4	1	Washer, large
	5	1	Spacer
	6	1	Peg, shifter pedal
	7	4	O-ring

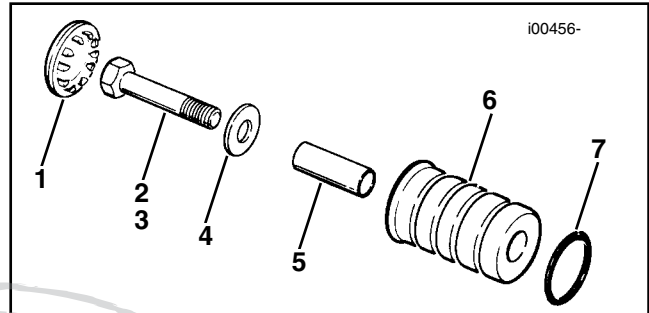

Figure 1. Exploded view

Installation Procedure

1. Remove old shifter pedal from shift lever.
2. Apply a light coating of grease on the outside surface of spacer (5). See Figure 1.
3. Assemble bolt (2) or (3), large washer (4), and spacer (5) into shifter pedal peg (6). See Figure 1.

NOTE

Shorter bolt (2) is used for lever with tapped hole. Longer bolt (3) is used for lever with thru hole. Reinstall lockwasher and nut to secure bolt.

4. Install peg assembly on shift lever. Tighten securely.
5. Install cap (1) on shifter pedal peg.



INSTRUCTIONS

-J00178

REV. 5-1-95

Kit Number 49149-84A

O-RING SHIFTER PEDAL

General

This kit is designed for all Harley-Davidson model motorcycles.

Kit contents:	ITEM	QTY	DESCRIPTION
	1	1	Cap
	2	1	Bolt, 5/16 - 24 x 1-3/4
	3	1	Bolt, 5/16 - 24 x 2
	4	1	Washer, large
	5	1	Spacer
	6	1	Peg, shifter pedal
	7	4	O-ring

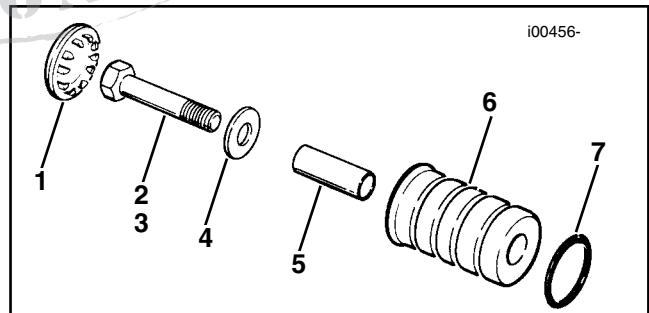

Figure 1. Exploded view

Installation Procedure

1. Remove old shifter pedal from shift lever.
2. Apply a light coating of grease on the outside surface of spacer (5). See Figure 1.
3. Assemble bolt (2) or (3), large washer (4), and spacer (5) into shifter pedal peg (6). See Figure 1.

NOTE

Shorter bolt (2) is used for lever with tapped hole. Longer bolt (3) is used for lever with thru hole. Reinstall lockwasher and nut to secure bolt.

4. Install peg assembly on shift lever. Tighten securely.
5. Install cap (1) on shifter pedal peg.