



# INSTRUCTIONS

-J02339

2011-08-19

## BLACK ENGINE GUARD KIT

### GENERAL

#### Kit Number

49023-02A

#### Models

For model fitment information, see the P&A Retail Catalog or the Parts and Accessories section of [www.harley-davidson.com](http://www.harley-davidson.com) (English only).

#### ▲ WARNING

Front and/or rear guard(s) can provide limited leg and cosmetic vehicle protection under unique circumstances. (Fall over while stopped, very slow speed slide.) It is not made or intended to provide protection from bodily injury in a collision with another vehicle or any other object. (00022b)

#### Kit Contents

See Figure 4 and Table 1.

### INSTALLATION

1. See Figure 1. Check the position of the clutch cable clip (4). The clip should extend outboard. If it does not, rotate the clip 180 degrees as follows:
  - a. Open clutch cable clip (4) on left downtube (2) and remove the clutch cable (5) from the clip.
  - b. Loosen the screw holding the clutch cable clip.
  - c. Rotate the clip 180 degrees.
  - d. Tighten the clutch cable clip screw.

#### NOTE

See Figure 1. When installing engine guard on models with ABS brakes, route the brake line (1) outboard of the frame tube and behind the engine guard (3) as shown. Rotate the brake line retaining clips (6) as shown to allow proper brake line routing.

- e. Install clutch cable back into the clutch cable clip.
2. See Figure 2. Hold the engine guard (1) in place, lining up the hole in the top center mounting flange of the guard with the hole in the cross brace located between the front downtubes just below the steering head.

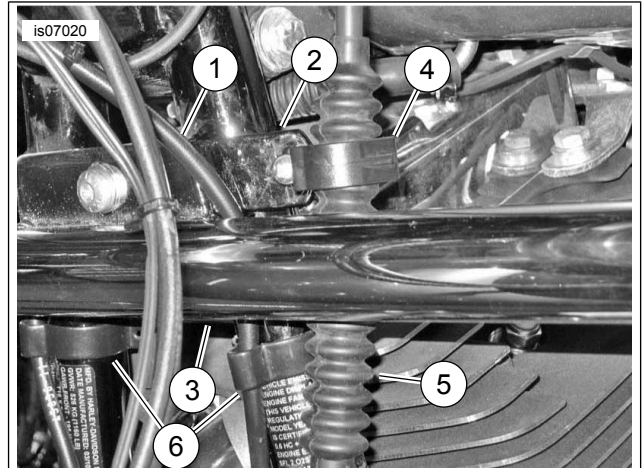

1. ABS brake line
2. Down tube
3. Engine guard
4. Clutch cable clip
5. Clutch cable
6. Brake line clip

Figure 1. Brake Line and Clutch Cable Routing

3. Install a flat washer (3) onto the screw threads and insert the screw (4) through the holes from the front. Install the second flat washer over the screw threads and thread the hex nut (2) onto the screw. Tighten finger-tight.
4. See Figure 3. On right side of the bike, attach the engine guard (1) with a screw (6), washers (5) and locknut (4). Tighten finger-tight.
5. Repeat Step 4 on left side. Tighten screw to 44 N·m (33 ft-lbs).
6. Tighten right side screw to 44 N·m (33 ft-lbs).
7. Tighten engine guard top mounting hardware to 25 N·m (19 ft-lbs).



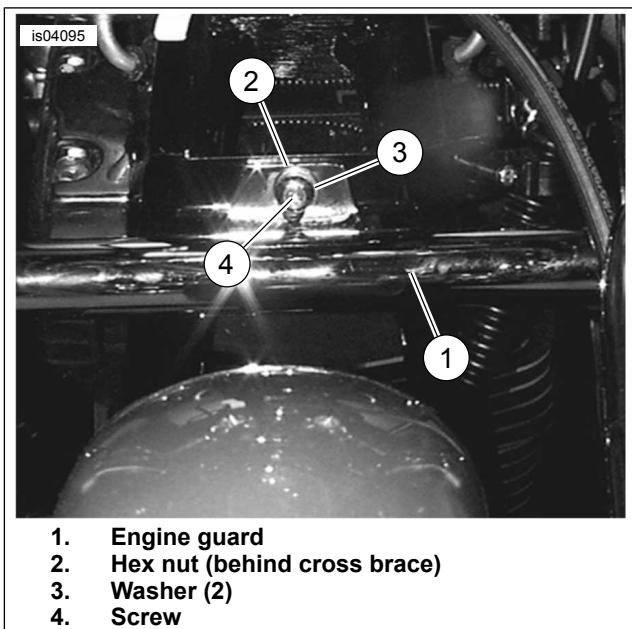

1. Engine guard
2. Hex nut (behind cross brace)
3. Washer (2)
4. Screw

Figure 2. Engine Guard Mounting Flange (Top Center)

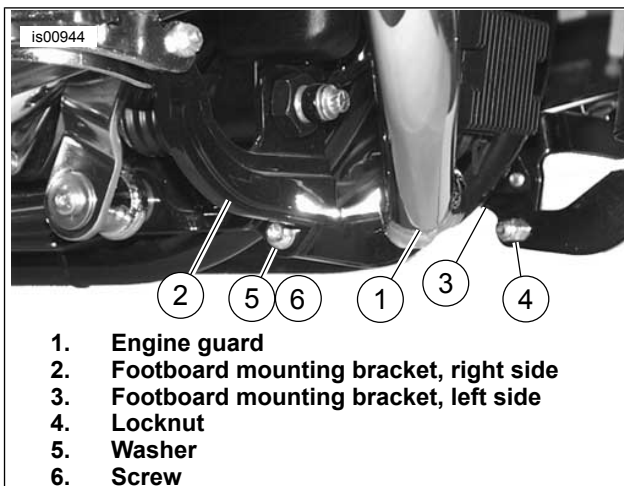

1. Engine guard
2. Footboard mounting bracket, right side
3. Footboard mounting bracket, left side
4. Locknut
5. Washer
6. Screw

Figure 3. Engine Guard Lower Mounting (Right Side View)

## SERVICE PARTS

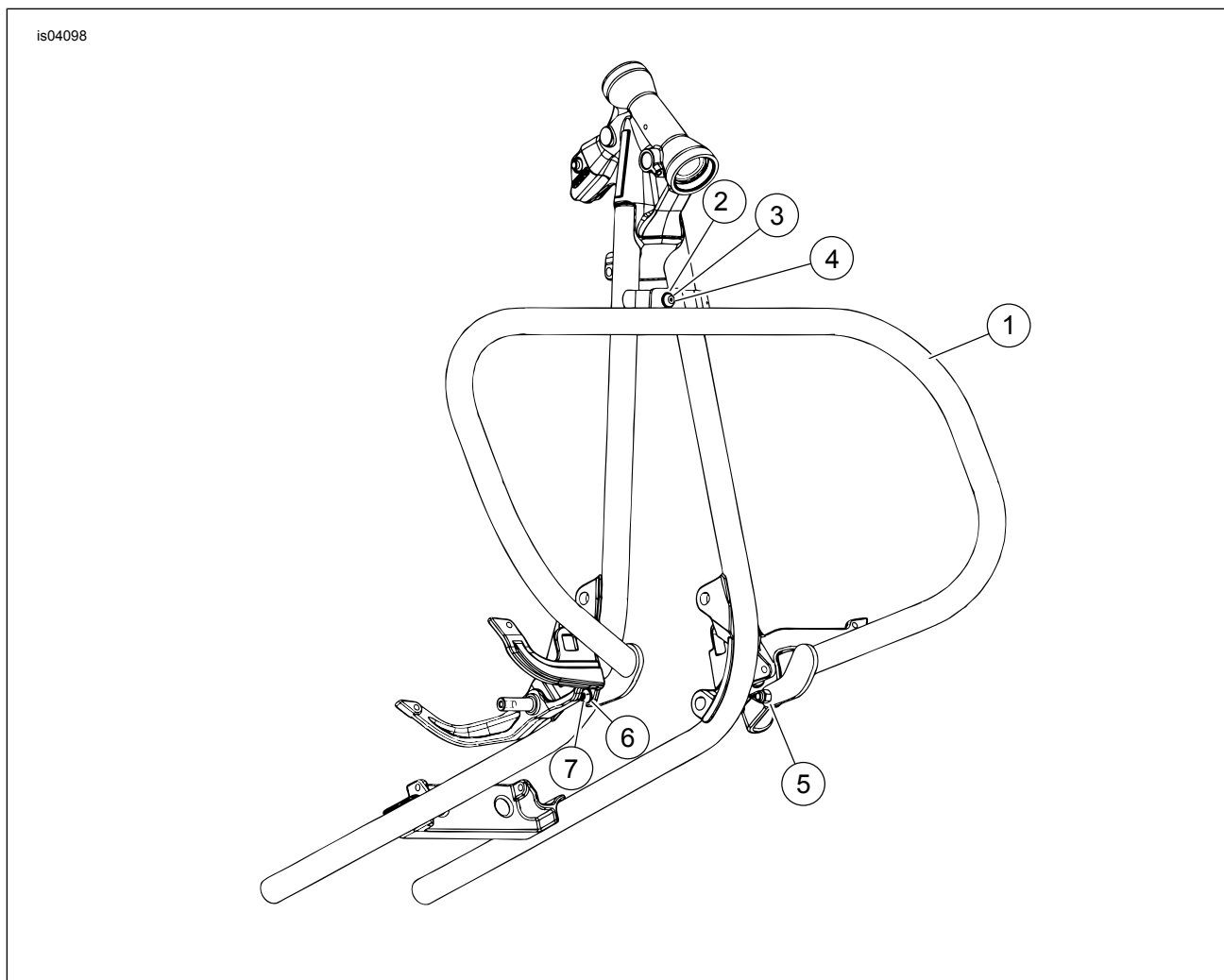

Figure 4. Service Parts: Black Engine Guard Kit

Table 1. Service Parts Table

Item	Description (Quantity)	Part Number
1	Engine guard	Not Sold Separately
2	Hex nut, 5/16 inch	7748W
3	Washer, 5/16 inch (2)	6702

**Table 1. Service Parts Table**

<b>Item</b>	<b>Description (Quantity)</b>	<b>Part Number</b>
4	Screw, panhead	3655A
5	Locknut, nylon, 3/8-16 (2)	7778
6	Washer, 3/8 inch (2)	6812
7	Screw, buttonhead (2)	4188