



INSTRUCTIONS

-J07071

2015-08-24

HANDLEBAR GUARD

GENERAL

Kit Number

49000132

Models

For model fitment information, see the P&A retail catalog or the Parts and Accessories section of www.harley-davidson.com (English only).

Installation Requirements

Installation of this kit requires the use of Loctite® 243 Threadlocker and Sealant - Blue.

⚠ WARNING

The rider's safety depends upon the correct installation of this kit. If the procedure is not within your capabilities or you do not have the correct tools, have a Harley-Davidson dealer perform the installation. Improper installation of this kit could result in death or serious injury. (00308a)

Kit Contents

See Figure 1 and Figure 2. Each handlebar guard is available as service kit (Part No. 49000119 (left side), Part No. 49000120 (right side)).

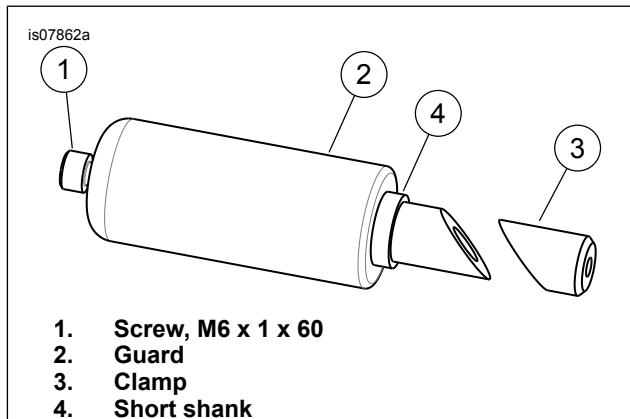

Figure 1. Handlebar Guard Kit, left, short shank

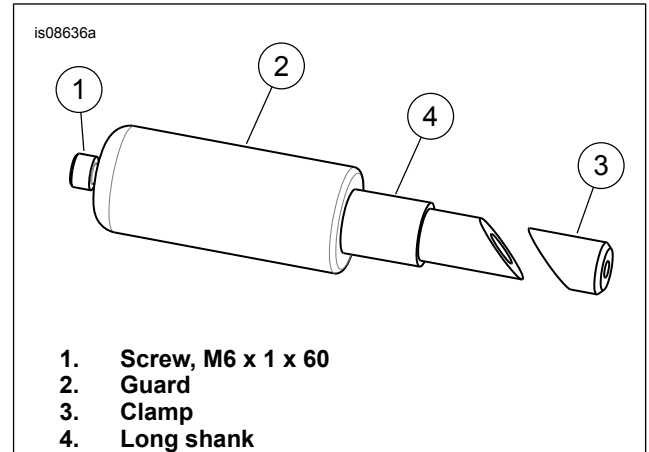

Figure 2. Handlebar Guard Kit, right, long shank

INSTALLATION

NOTE

Verify to cut the right grip large enough to prevent contact with the guard.

1. See Figure 3. Carefully cut the end of the grip.
 - a. **Left grip:** Cut to the size of the inner diameter of the handlebar.
 - b. **Right grip:** Cut to the size of the twist grip inner sleeve.
2. Assemble guard components:
 - a. **Left grip uses short shank:** See Figure 1. Apply a small amount Loctite 243 (blue) to screw (1). Insert screw through guard (2) and start in the clamp (3).
 - b. **Right grip uses long shank:** See Figure 2. Apply a small amount Loctite 243 (blue) to screw (1). Insert screw through guard (2) and start in the clamp (3).
3. See Figure 4. Insert assembly into the end of the handlebar until the shoulder (2) contacts the handlebar.
4. Tighten screw. Tighten to 21.7 N·m (16 ft-lbs).

⚠ WARNING

Before starting engine, be sure throttle control will snap back to idle position when released. A throttle control that prevents engine from automatically returning to idle can lead to loss of control, which could result in death or serious injury. (00390a)

-J07071



Many Harley-Davidson® Parts & Accessories are made of plastics and metals which can be recycled. Please dispose of materials responsibly.

1 / 2

NOTE

To remove, loosen screw. Tap on end of screw with hammer and punch to loosen clamp.

5. Verify that throttle control does not bind and operates freely.

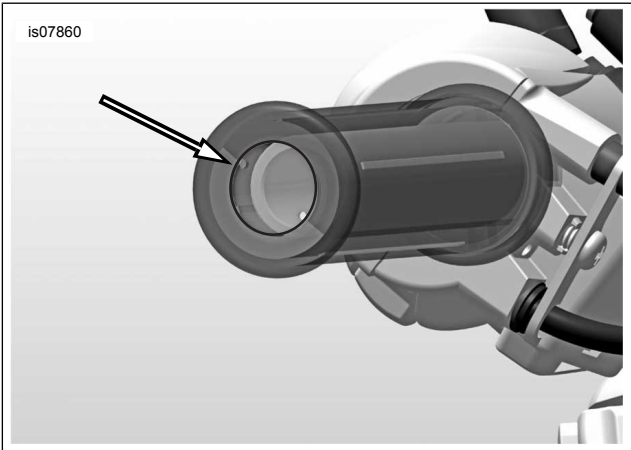

Figure 3. Cut End of Grip

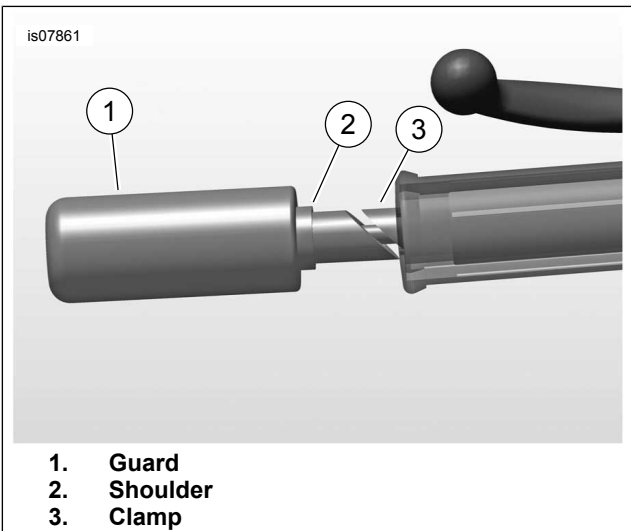

Figure 4. Install Guard