



# INSTRUCTIONS

-J01715

REV. 2007-09-11

## SOFTAIL REAR AXLE COVER KIT

### GENERAL

#### Kit Number

48056-97B

#### Models

For model fitment information, please see the P&A Retail Catalog or the Parts and Accessories section of [www.harley-davidson.com](http://www.harley-davidson.com) (English only).

#### Kit Contents

Table 1. Kit Contents

Description (Quantity)	Part Number
Cover cap, left rear axle	Not Sold Separately
Cover cap, right rear axle	Not Sold Separately
Rear axle cover base (2)	Not Sold Separately
Screw, flat head (4)*	Not Sold Separately*
Screw, axle adjuster, 2-1/2 inch long (2) (May be required if original axle adjuster screws are too long. See procedure in this instruction sheet.)	Not Sold Separately
Washer, 3/8 inch (2)	34075-89
Set screw, #8-32 (2)	3206B
Wrench, hex 5/64 inch	Not Sold Separately
Retainer clip (2)	48474-00

\* For a replacement screw, use part number 924224-00 with an application of LOCTITE<sup>®</sup> 243 Threadlocker and Sealant - Blue.

### INSTALLATION

#### NOTE

Do **not** remove the cotter pin or spring clip from the rear axle castle nut. It is not necessary to loosen the rear axle nut to install this kit.

1. See Figure 1. On the left side of the motorcycle, loosen axle adjuster screw (1) and jamnut (2) just enough to be able to remove jamnut.
2. On each side, place retainer clip (4) and washer (3) from kit over axle adjuster screw and replace jamnut (2). Turn in axle adjuster screw (1) until it is in its original position against axle spacer, but leave jamnut loose.

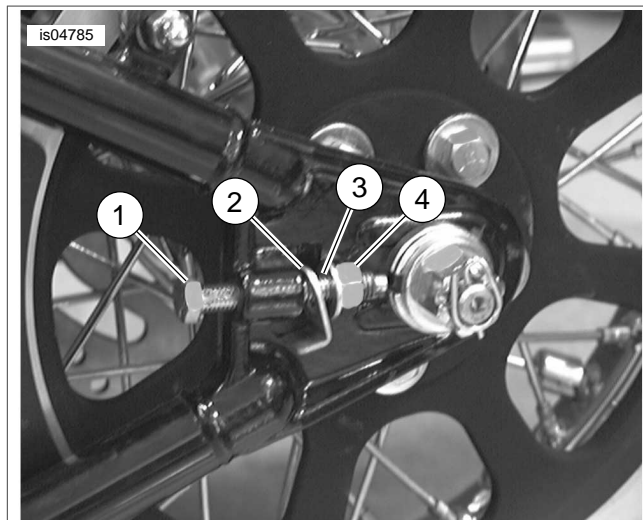

1. Axle adjuster screw
2. Jamnut
3. Washer (from kit)
4. Retainer clip

Figure 1. Installing Jamnut, Washer and Retainer Clip

3. See Figure 2. Slide axle cover base over the rear of the swingarm. Locate retainer clip (1) and tighten jamnut (3). Keep pressure on axle cover base with hand while tightening the jamnut to keep the base close to the down tubes.

#### NOTES

**On most models:** The exhaust must be loosened and/or removed for assembly of the axle cover base on the right side. Follow instructions in the applicable Service Manual for removal and assembly of exhaust system.

If the cover will not fit over the axle adjuster screw, the original screw may be too long. If this is the case, replace the original axle adjuster screw with the shorter axle adjuster screw supplied in this kit.

It is possible that in some cases on 1987-1992 Softails, the original adjuster screw and the adjuster screw provided in this kit may both be too long. If this is the case, a 3/8-16 x 2-1/4 inch Grade 5 hex head capscrew should be used. The bolt must be fully threaded.

4. **1999 and earlier models:** See Figure 3. If the axle adjuster screw needs to be replaced, it will be necessary to remove the caliper. On the right side (brake caliper side), use a T40 TORX drive to remove the two pin bolts (2) from caliper. Remove caliper by gently rocking caliper back and forth to compress caliper piston then carefully slide caliper off brake disc.
5. Tighten jamnut to secure axle cover base.

**NOTE**

To avoid over-tightening screw use only the hex wrench provided in kit.

6. Use hex wrench provided in kit to install set screw in rear hole of axle cover base until screw contacts swingarm and holds base in place.
7. See Figure 4. Install axle cover cap with flat head screws from kit.

**⚠ WARNING**

After servicing brakes and before moving motorcycle, pump brakes to build brake system pressure. Insufficient pressure can adversely affect brake performance, which could result in death or serious injury. (00279a)

8. Carefully replace brake caliper on right side of motorcycle. Tighten pin bolts to 15-20 ft-lbs (20-27 Nm).

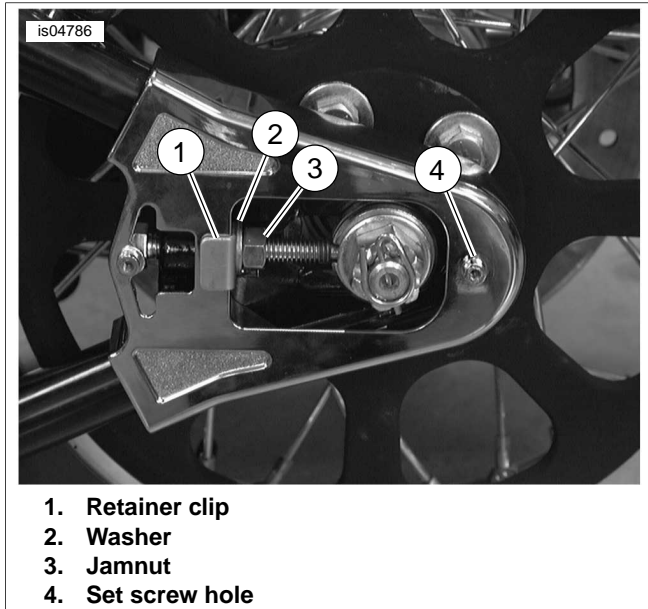

Figure 2. Installing Axle Cover Base

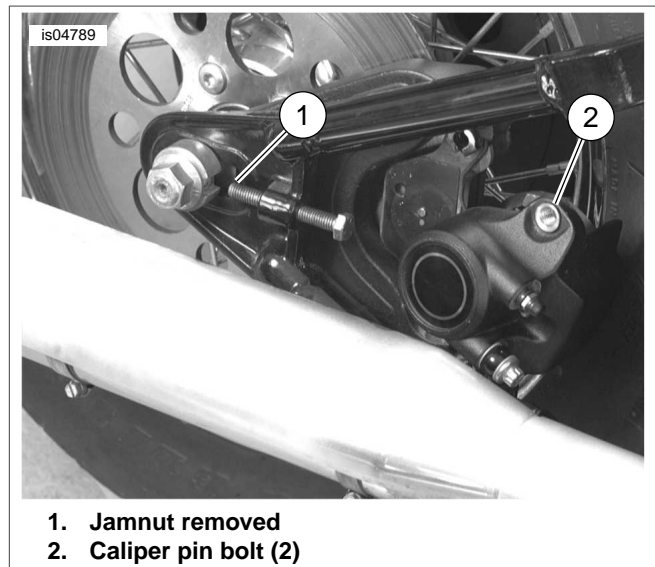

Figure 3. Removing Brake Caliper and Jamnut

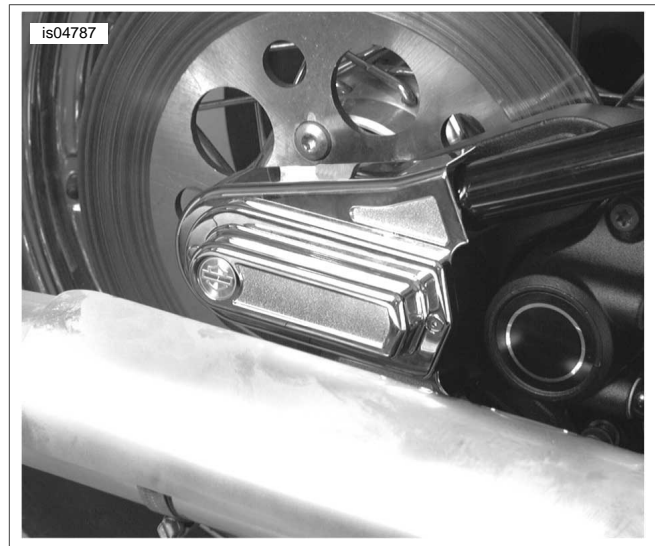

Figure 4. Installing Axle Cover Cap

