



# INSTRUCTIONS

-J04070

REV. 2006-04-14

## IRONSIDE BRAKE PEDAL PAD

### GENERAL

#### Kit Number

46959-07

#### Models

This kit fits 1980 and later Touring® and 1986 and later FL Softail® model motorcycles.

#### NOTE

*A Service Manual for your model motorcycle is available from a Harley-Davidson Dealer.*

#### Kit Contents

See Figure 1 and Table 1.

### INSTALLATION

1. Remove the previously installed brake pedal cover from the foot brake lever.
2. See Figure 1. Obtain the mounting plate (7) from kit. Position the mounting plate over the brake pedal (A)

aligning raised area under plate with oval hole in brake pedal.

3. Obtain the offset washer (2) from kit. Position washer under brake pedal and align the "offset" area of the washer so that it covers oval hole in brake pedal.
4. From top of mounting plate, install 5/16 inch flathead screw (1) through mounting plate (7), brake pedal (A) and offset washer (2).
5. From under brake pedal, install acorn nut (3) to secure mounting plate and offset washer to brake pedal. Tighten acorn nut to 25-29 ft-lbs (33-39 Nm).
6. Obtain brake pedal cover (5) and pedal tread (6) from kit. Align and insert tread (6) into the brake pedal cover.
7. From the side, slide the brake pedal cover assembly over the mounting plate (and pedal) and align the two holes in bottom of cover with two holes in mounting plate.
8. Obtain the two 10-24 screws (4) from kit. From under brake pedal (A), install screws through holes in mounting plate (7) and into pedal cover (5). Tighten screws to 20-22 **in-lbs** (2.2-2.5 Nm).

# SERVICE PARTS

is02702

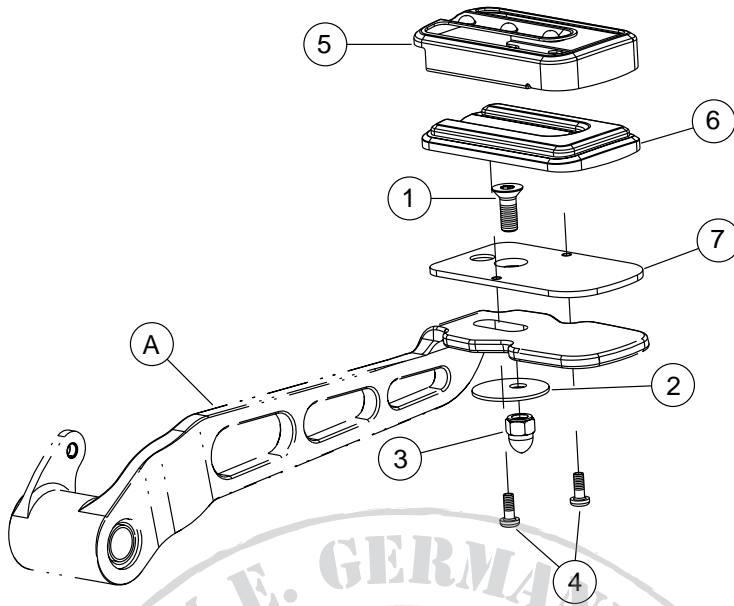

**Figure 1. Service Parts: Brake Pedal Pad Kit**

**Table 1. Service Parts Table**

Item	Description (Quantity)	Part Number
1	Screw, 5/16-18 x 7/8 inch w/lock patch, zinc plated	1783C
2	Washer, offset, chrome plated	6421
3	Acorn nut, 5/16-18, chrome plated	94006-90T
4	Screw, 10-24 x 1/2 inch w/lock patch, zinc plated	2903
5	Cover, brake pedal pad	42147-07
6	Tread	42146-07
7	Mounting plate	44437-04
<b>Items mentioned in text, but not included in kit:</b>		
A	Brake pedal	