



INSTRUCTIONS

-J04182

2006-06-14

FRONT AXLE-NUT COVER KIT

GENERAL

Kit Numbers

44109-07, 44114-07, 44115-07, 44116-07, 44117-07, and 44148-07.

Models

These Kits fit 2007 Softail® (except Springer and FXSTD) and 2002-later VRSCA, VRSCB, VRSCD, and VRSCX model motorcycles.

Kit Contents

See Figure 1 and Table 1.

INSTALLATION

NOTE

It is not necessary to loosen the axle nut when installing these covers.

The axle-nut covers set screws are side-specific.

Installing the Right-Side Cover

1. See Figure 1. Select a cover and the **shorter** set screw (2) from the kit.
2. Thread the set screw half way into the hole from the outside, and then position the cover over the end of the axle.
3. Using the hex key (Allen wrench) from the kit, tighten the set screw securely.

NOTE

Make certain that the set screw is securely fastened to the axle end, and that the set screw has not gone into the hole on the side of the axle.

Installing the Left-Side Cover

1. See Figure 1. Select the remaining cover and the **longer** set screw (3) from the kit.
2. Thread the set screw half way into the hole from the outside, and then position the cover over the axle nut.
3. Using the hex key from the kit tighten the set screw securely.

NOTE

Make certain that the set screw is making contact to a flat surface of the nut.

SERVICE PARTS

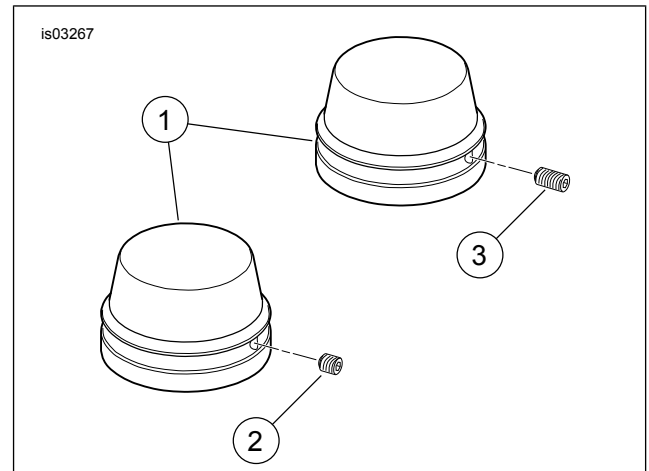

Figure 1. Front Axle Nut Covers

Table 1. Service Parts

Item	Description (Quantity)	Part Number
1	Cover, front axle nut (2)	Not sold separately
2	Set screw, short, right side	Not sold separately
3	Set screw, long, left side	Not sold separately
4	Allen wrench	Not sold separately

