



# INSTRUCTIONS

-J04579

REV. 2008-06-23

## REAR AXLE NUT COVER KIT

### GENERAL

#### Kit Number

43132-08, 43422-09

#### Models

For model fitment information, see the P&A Retail Catalog or the Parts and Accessories section of [www.harley-davidson.com](http://www.harley-davidson.com) (English only).

#### Additional Parts Required

Proper installation of this kit requires Loctite® 243 Threadlocker and Sealant - Blue (part number 99642-97)

### ⚠ WARNING

The rider's safety depends upon the correct installation of this kit. Use the appropriate service manual procedures. If the procedure is not within your capabilities or you do not have the correct tools, have a Harley-Davidson dealer perform the installation. Improper installation of this kit could result in death or serious injury. (00333a)

#### NOTE

This instruction sheet references service manual information. A service manual for your model motorcycle is required for this installation and is available from a Harley-Davidson dealer.

#### Kit Contents

See Figure 1 and Table 1.

### INSTALLATION

#### NOTES

The **shorter** axle nut cover mounts on the right side of the vehicle, and the **longer** cover on the left.

On a motorcycle that has been previously serviced, verify that the axle has not been removed and installed from the left side (with the castle nut on the right side of the wheel).

If it has, the axle **MUST** be installed from the right side of the motorcycle. See the service manual for procedure.

1. See Figure 1. Partially install a set screw (3) into the threaded hole in each axle nut cover (1, 2).
2. Adjust the position of the exhaust system as necessary to provide axle nut clearance.
3. Tighten the axle nut-cover set screws (3) to 70 **in-lbs** (8 Nm).

#### NOTE

The set screws in this kit are treated with a thread locking compound. When replacing or re-installing the set screws, apply Loctite 243 (blue) to the set screw threads.

### SERVICE PARTS

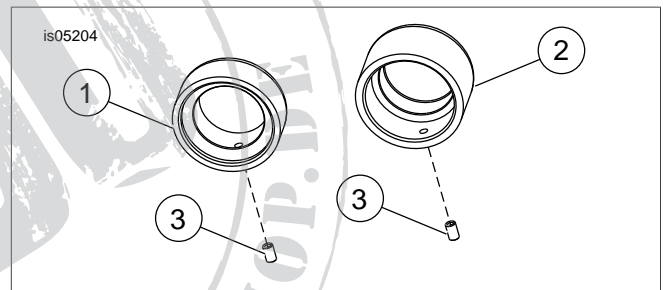

Figure 1. Rear Axle Nut Cover Kit

Table 1. Service Parts: Rear Axle Nut Cover Kit

Item	Description (Quantity)	Part Number
1	Axle nut cover, right side	Not Sold Separately
2	Axle nut cover, left side	Not Sold Separately
3	Set screw, #10-24 x 1/4 inch (2)	Not Sold Separately