



INSTRUCTIONS

-J04674

REV. 2008-07-09

FANG REAR WHEEL KIT

GENERAL

Kit Number

43268-09

Models

For model fitment information, see the P&A Catalog or the Parts and Accessories section of www.harley-davidson.com.

Additional Parts Required

This kit includes the custom wheel only.

Proper installation of this kit requires the separate purchase of the following parts which are available at a Harley-Davidson dealer:

- Wheel Bearing Remover and Installer (HD-44060-A)
- Wheel Installation Kit (See Service Parts Tables for part number)

The following Harley-Davidson Genuine Motor Accessories are recommended for proper maintenance and cleaning:

- Harley® Bright™ Chrome Cleaner (94683-99)
- Harley® Glaze™ Polish and Sealant (99701-84)
- Harley® Wheel and Spoke Brush (43078-99)
- Harley-Davidson® Wheel and Tire Cleaner (94658-98)

WARNING

The rider's safety depends upon the correct installation of this kit. Use the appropriate service manual procedures. If the procedure is not within your capabilities or you do not have the correct tools, have a Harley-Davidson dealer perform the installation. Improper installation of this kit could result in death or serious injury. (00333a)

NOTE

This instruction sheet references service manual information. A service manual for your model motorcycle is required for this installation and is available from a Harley-Davidson Dealer.

Kit Contents

See the Service Parts section for kit contents.

INSTALLATION

1. Remove existing rear wheel assembly. Save axle, axle nut, brake disc and wheel spacers for kit installation. Refer to the service manual.

NOTE

Prior to removing or installing the wheel, the rear brake caliper must be removed.

The cotter pin or spring clip for the axle nut must be replaced. They are available for purchase from your dealer. See your dealer for the correct part number for your model motorcycle.

CAUTION

Do not re-use brake disc screws. Re-using disc screws can result in torque loss and damage to rotor and/or brake assembly. (00319b)

CAUTION

Do not re-use sprocket mounting screws. Re-using sprocket mounting screws can result in torque loss and damage to the sprocket and/or belt assembly. (00480b)

2. See Figure 1. Install valve stem assembly (E) on wheel. Refer to service manual.
3. Assemble wheel installation kit components, stock brake disc and sprocket to wheel, using the appropriate service parts table. Refer to service manual.
4. Install primary bearing first following the instructions in the service manual and using a WHEEL BEARING REMOVER/INSTALLER.

NOTE

The groove machined in the hub face indicates the primary bearing side.

5. Install rear wheel (1), stock axle, sprocket and stock spacers to motorcycle. See service manual.

MAINTENANCE AND CLEANING

Chrome parts must be maintained regularly to be sure that they keep their original shine and luster.

1. Clean heavily-soiled wheel surfaces using Harley-Davidson Wheel and Tire Cleaner applied with the Harley Wheel and Spoke Brush.
2. Thoroughly clean chrome with a good quality chrome cleaner, such as Harley Bright Chrome Cleaner.
3. After cleaning and polishing, seal the finish with a good quality sealer, such as Harley Glaze Polish and Sealant.

SERVICE PARTS

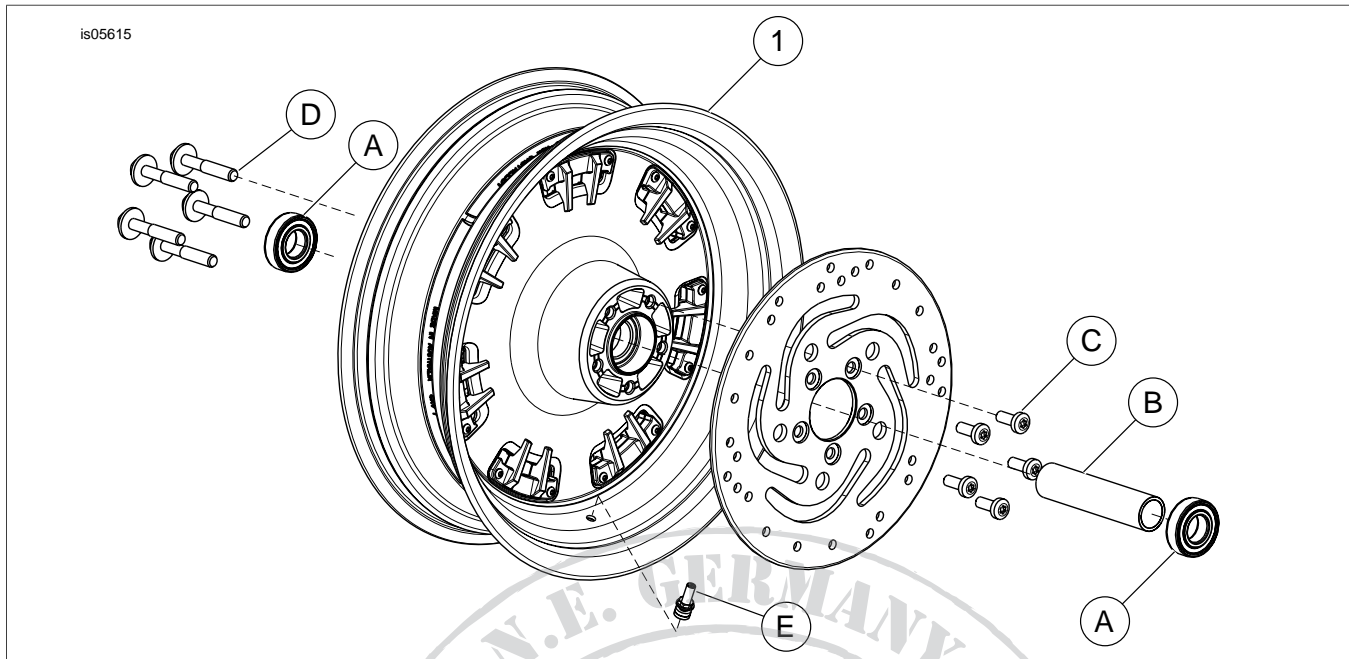

Figure 1. Service Parts: Rear Fang Wheel

Table 1. Service Parts Table

Kit	Installation Kit	Item	Description (Quantity)	Part Number
43268-09		1	Wheel	Not sold separately
		Items requiring separate purchase:		
2008-later FXDF	41451-08 Rear 16x5 Fitment	A	Bearing (2)	9276
		B	Sleeve, bearing spacer	43905-08
		C	Disc screws (5)	43567-92
		D	Sprocket screws (5)	3109
		E	Valve stem (long)	43206-01
		Discard the following components which are provided with this installation kit but are not required for this fitment.		
			Shim, bearing (install under primary bearing)	43904-08
			Valve stem (short)	43157-83A