



INSTRUCTIONS

-J04579

2016-03-10

REAR AXLE NUT COVER KIT

GENERAL

Kit Numbers

43132-08, 43422-09, 43000018, 43000022

Models

For model fitment information, see the P&A retail catalog or the Parts and Accessories section of www.harley-davidson.com (English only).

Installation Requirements

Loctite® 243 Medium Strength Threadlocker and Sealant - Blue (Part No. 99642-97) is required for proper installation of this kit.

▲ WARNING

The rider's safety depends upon the correct installation of this kit. Use the appropriate service manual procedures. If the procedure is not within your capabilities or you do not have the correct tools, have a Harley-Davidson dealer perform the installation. Improper installation of this kit could result in death or serious injury. (00333a)

NOTE

This instruction sheet refers to service manual information. A service manual for this year/model motorcycle is required for this installation. One is available from a Harley-Davidson dealer.

Kit Contents

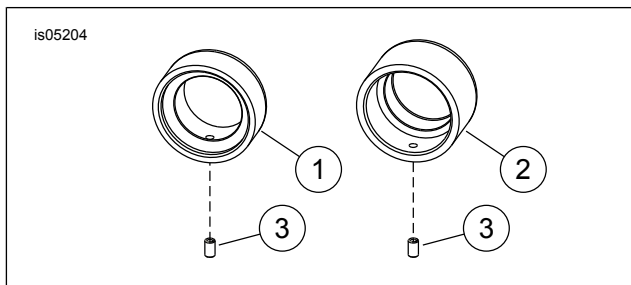

Figure 1. Rear Axle Nut Cover Kit

Table 1. Kit Contents

Item	Description/Quantity
1	Axle nut cover, right
2	Axle nut cover, left
3	Set screw (2)

There are no service parts available for these kits.

INSTALLATION

NOTE

- The **shorter** axle nut cover mounts on the axle bolt head. The **longer** axle nut cover mounts on the axle nut.

- Verify that the axle has not been installed from the left side (with the castle nut on the right side) during previous service. The axle **MUST** be installed from the right side. See the service manual.

- See Figure 1. Partially install a set screw (3) into the threaded hole in each axle nut cover (1, 2).
- Adjust the position of the exhaust system as necessary to provide axle nut clearance.
- Tighten the axle nut-cover set screws (3) securely .

NOTE

The set screws in this kit are treated with a thread locking agent. When replacing or reinstalling the set screws,

- Thoroughly remove all existing threadlocking agent from fastener and mounting hole threads before applying new threadlocking agent.
- apply Loctite 243 (blue) to the set screw threads.

