



INSTRUCTIONS

-J02577

REV. 11-6-02

Kit Number 42841-03

FLAMES BRAKE PEDAL PAD KIT

General

This kit is designed for installation on 1984 and later FX Softails and 1993 and later FXDWG model motorcycles.

See Service Parts Illustration for kit contents.

Installation

NOTE

A Service Manual for your motorcycle is available at your Harley-Davidson Dealer.

1. Remove the previously installed brake pedal cover from the foot brake lever. Discard pedal cover.

NOTE

Brake Pedal will be fastened to cover with three screws.

2. Align the assembly over the foot brake pedal and insert the threaded stud through the hole in the pedal.

3. Obtain the washer (3) and locknut (2) from the kit and secure the pedal pad assembly to the footbrake pedal.

4. Tighten the locknut to 33 in-lbs (2.5 Nm).

WARNING

Whenever the motorcycle brake components are serviced, always test it on dry, clean pavement at slow speeds before putting the vehicle into regular service. Failure to test brakes may lead to an accident which could result in death or serious injury.



Service Parts

Part Number 42841-03

Date 11/02

Flames Brake Pedal Pad Kit

i05193

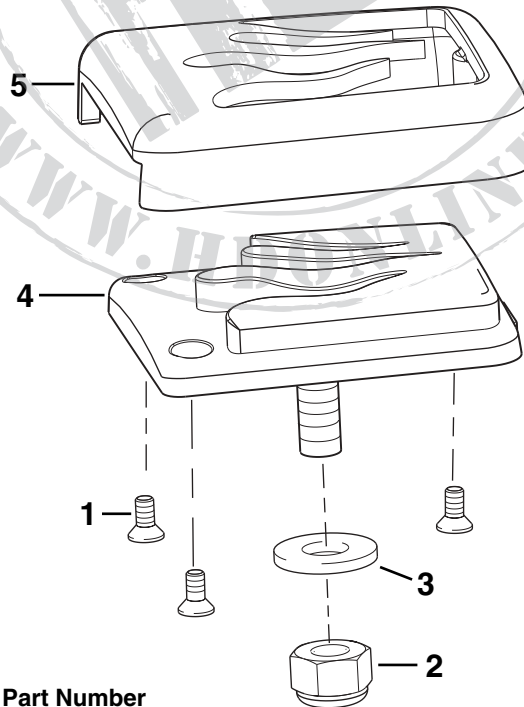

Item	Description(Quantity)	Part Number
1	Screw, 4-40x1/4 inch (3)	4277
2	Locknut	7686
3	Washer	6703
4	Tread, brake pedal pad	42843-03
5	Cover, brake pedal pad	not sold