



INSTRUCTIONS

-J02700

REV. 11-4-2002

Kit Number 42693-03

DIAMOND PLATE BRAKE PEDAL PAD KIT

General

This kit fits 1980 and later Touring models and 1986 and later FL Softail model motorcycles.

See the Service Parts Illustration below for a list of kit contents.

Installation

1. Remove and discard the previously installed brake pedal cover from the foot brake lever.
2. See the Service Parts Illustration. Obtain the pedal pad tread (2) and the pedal pad cover (1) from the kit. Align the pad tread to the cover and place the pad and cover assembly over the foot brake pedal as shown.

3. Assemble the plain washer (3) and screw (4), and thread the screw through the hole in the brake lever and into the back of the pad.
4. Tighten the screw to 19 ft-lbs (26 Nm).

WARNING

Whenever the motorcycle brake components are serviced, always test it on dry, clean pavement at slow speeds before putting the vehicle into regular service. Failure to test brakes may lead to an accident which could result in death or serious injury.



Service Parts

Part No. 42693-03

Date 11/02

Diamond Plate Brake Pedal Pad Kit

i05189

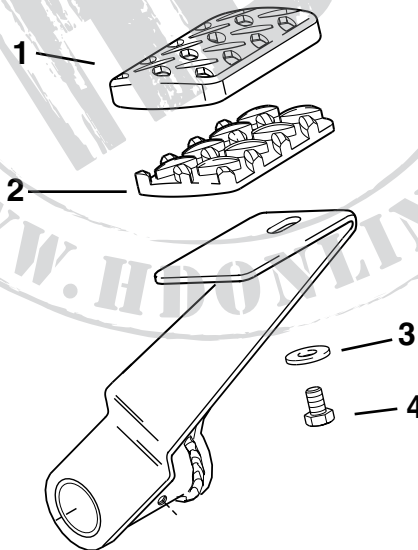

Item	Description	Part Number
1	Cover, brake pedal pad	Not sold
2	Tread, brake pedal pad	42695-03
3	Washer	6333
4	Screw, hex head	3484