



INSTRUCTIONS

-J02188

REV. 5-18-01

Kit Number 42679-01

POLISHED STAINLESS STEEL FOOTPEG MOUNTING PINS

General

This kit is designed for use on all Harley-Davidson "male mount" style footpegs.

NOTE

A Service Manual for your model motorcycle is available from your Harley-Davidson Dealer.

Installation

1. See Figure 1. For each footpeg, remove nut (1), screw (2), footpeg (3) and spring washer (4).
2. Install the footpeg inserting a new spring washer between the footpeg and the footpeg support (5).
3. Insert the new clevis pin (6) through the footpeg support and the footpeg. Notice that the new pin has two grooves. Position the retaining ring (7) in the groove that allows the least amount of free play for the clevis pin. The kit also contains a flat washer (8), which can be used to further reduce the amount of free play for the clevis pin. (Use of this washer is optional.)
4. Once the best combination is found, secure the retaining ring (7) onto the pin (6).

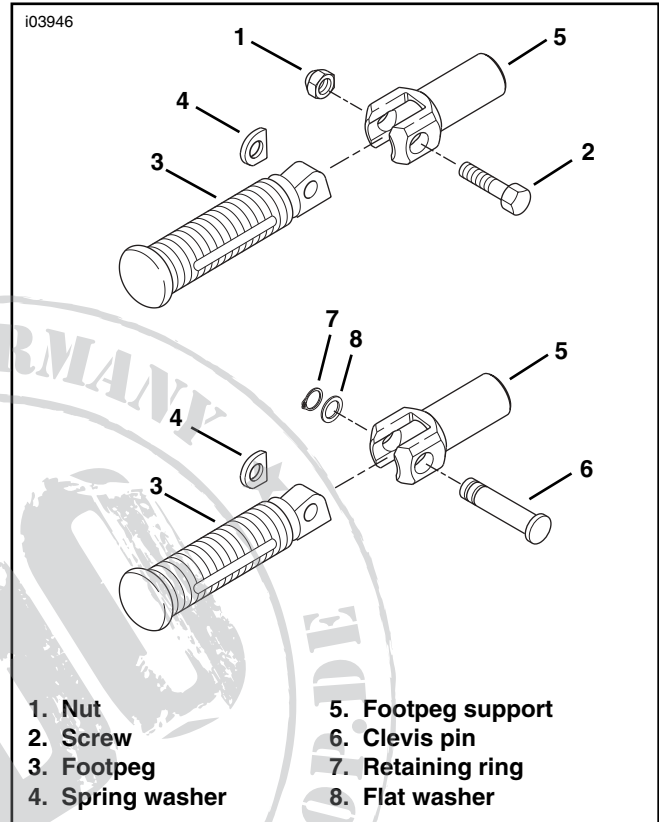

Figure 1. Footpeg Mounting Pins



Service Parts

Part No. 42679-01

Date 5/01

Polished Stainless Steel Footpeg Mounting Pins

Kit 42679-01

Kit Service Parts:

Clevis pin (2)
Spring washer (2)
Washer (2)
Retaining ring (2)

Part No.

42680-01
50912-72
6379W
11304