



# INSTRUCTIONS

-J02454

REV. 05-09-2002

Kit Number 42638-03

## BILLET STYLE REAR BRAKE LEVER

### General

This kit is designed for installation on 1997 and later Touring models FLHT, FLHTC/I, FLHTCUI, FLHR/I, FLHRC/I, FLHP/I, FLHTP/I, and FLTR/I.

Proper installation of this kit also requires installing a Brake Pedal Pad, sold separately. Refer to the appropriate Parts Catalog for a stock replacement rubber pad or see the current Harley-Davidson Genuine Motor Accessories and Parts catalog for a selection of brake pedal pads.

See the Service Parts illustration for a list of items contained in this kit.

#### NOTE

A Service Manual for your motorcycle is available from your Harley-Davidson dealer.

### Removing the Stock Brake Lever

1. See the Service Parts illustration. Remove the cotter pin and washer from the master cylinder clevis pin. Discard the cotter pin.

#### NOTE

The clevis pin has a slight interference fit. It may be necessary to use pliers to pull the clevis pin from the push rod. Be careful not to damage mating parts.

2. Remove the clevis pin from the brake rod. Thoroughly clean and examine parts for wear. Replace if necessary.
3. Remove the brake lever mounting nut and flat washer, and discard. Remove and discard the outer "O"-ring.
4. Remove the brake lever by rotating counter-clockwise and lifting the master-cylinder clevis if necessary. Pull the lever from the shaft. Remove and discard the inner "O"-ring.
5. Thoroughly clean the lever mounting shaft of grease and dirt.

### Installing the New Brake Lever

#### NOTE

This Billet-Style Brake Lever is equipped with self-lubricating bushings. However, on FLHT and FLTR models, apply a thin film of wheel bearing grease, part number 99856-92, to the mounting shaft and bushings prior to installation to prevent shaft corrosion.

1. See the Service Parts illustration. Insert the "O"-rings (4) on either side of the lever bushings. Install the new billet style brake lever (1) onto the shaft.
2. Align the holes in the lever and brake rod and insert the stock clevis pin.
3. Install the small saved flat washer onto the clevis pin and insert the new cotter pin (7).
4. Install the large flat washer (6) and locknut (5) from the kit. Tighten the locknut to 15-20 ft-lbs (20-27 Nm).
5. Install the brake pedal pad to the brake lever.

#### WARNING

Whenever the brake system is serviced, always test the brakes on dry, clean pavement at slow speeds before putting the motorcycle to regular use. Failure to comply may lead to an accident which could result in death or serious injury.

6. Check the brake lever for proper operation and clearance through its full travel.



# Service Parts

Part No. -42638-03

Date 05/02

Rear Brake Lever

i04822.eps

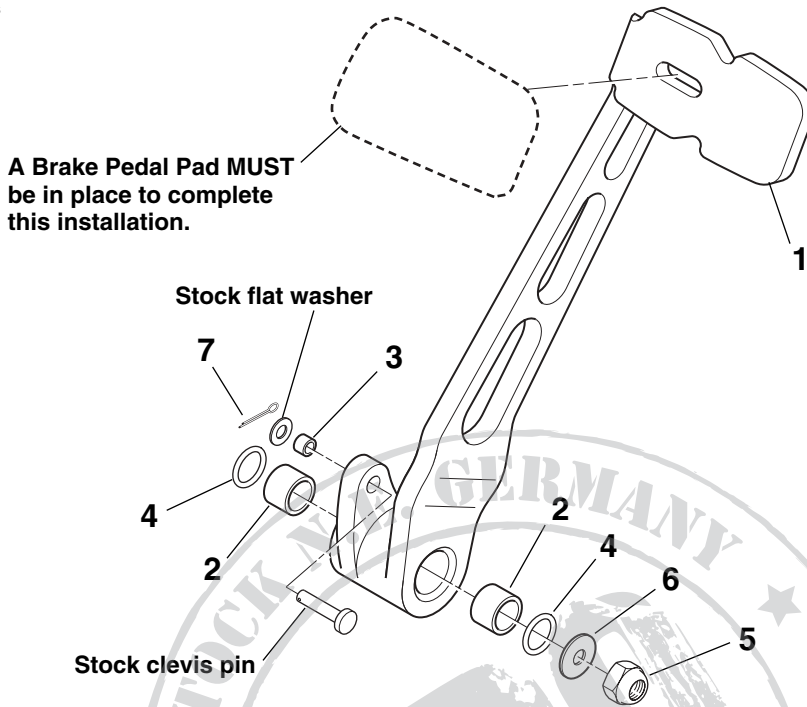

Item	Description	Part No.	Item	Description	Part No.
1	Rear brake lever assembly, billet-style (incl. bushings)	Not sold	4	"O"-Ring (2)	11364
2	Bushing, 0.62" ID x .75" (2)	57217-02	5	Lock nut, 7/16"-20	7825
3	Bushing, 0.25" ID x .177"	42644-00	6	Washer, flat, 7/16"	6334
			7	Cotter pin, 1/16" x 3/4"	515