



INSTRUCTIONS

-J03188

REV. 2005-04-05

HOG® FL BRAKE PEDAL PAD

GENERAL

Kit Number

42488-04

Models

This kit fits 1980 and later Touring models and 1986 and later FL Softail model motorcycles.

Kit Contents

See Figure 1 and Table 1.

INSTALLATION

1. Remove and discard the previously installed brake pedal cover from the foot brake lever.
2. Slide the pad assembly over the foot brake pedal as shown. Install the screw through the hole in the back of the pad.
3. Tighten the screw to 10 ft-lbs (13.5 Nm).

WARNING

After repairing the brake system, test brakes at low speed. If brakes are not operating properly, testing at high speeds can cause loss of control, which could result in death or serious injury. (00289a)

SERVICE PARTS

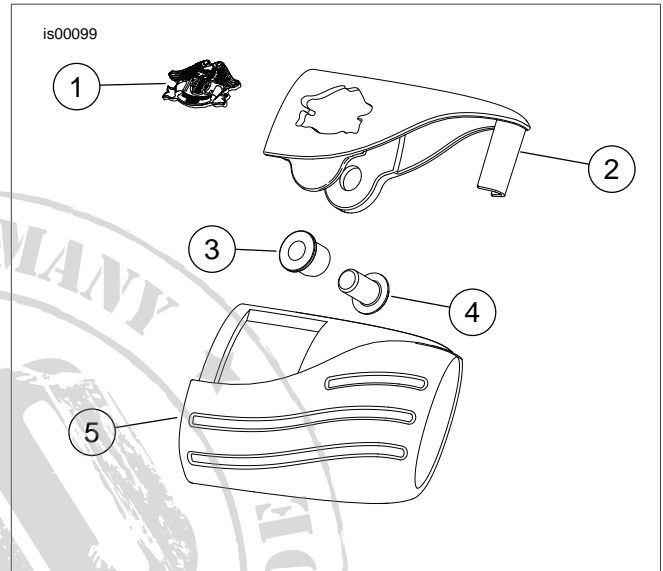

Figure 1. Service Parts

Table 1. Service Parts Table

Item	Description (Quantity)	Part Number
1	HOG® emblem	95743-04
2	Brake pedal pad cover	Not Sold Separately
3	T-Nut, 3/8 in.	42721-04
4	Screw, button head, 3/8-16 x 5/8 in.	1073
5	Brake pedal pad tread	42603-04