



INSTRUCTIONS

-J00102

REV. 10-16-2002

Kit Number 42476-95 and 42482-95

THREE-SLOT CHROME BRAKE PEDAL PAD AND COVER KIT

General

These kits fit all **1984 and later** FX Softail models (except FXSTDSE), and **1993 and later** FXDWG models.

Installation

1. Remove the locknut that secures the original equipment (OE) brake pedal pad. Discard the pad and locknut.
2. See the Service Parts Illustration. Align and place the new brake pedal cover (4) over the rubber tread (5).
3. Insert bolt (3), with the rubber H-D logo properly aligned, through the cover and tread, and into the hole in the brake pedal.
4. Position flat washer (1) onto the exposed bolt threads. Thread acorn nut (2) onto the bolt threads. Tighten the nut to 9-10 ft-lbs (12.2-13.6 Nm).

⚠ WARNING

Whenever the motorcycle brake components are serviced, always test it on dry, clean pavement at slow speeds before putting the vehicle into regular service. Failure to test brakes may lead to an accident which could result in death or serious injury.

sp42476

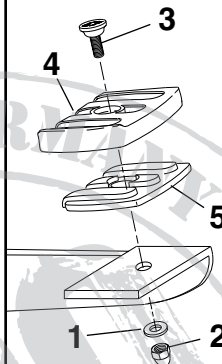

Kit 42476-95 (Horizontal slots):

Item	Description	Part No.
1	Flat washer	6423
2	Acorn nut	7949
3	Bolt (with logo)	42559-95
4	Brake pedal cover	44230-95
5	Rubber tread	44231-95

Kit 42482-95 (Vertical slots-shown):

Item	Description	Part No.
1	Flat washer	6423
2	Acorn nut	7949
3	Bolt (with logo)	44225-95
4	Brake pedal cover	44223-95
5	Rubber tread	44224-95

Figure 1. Kit Contents



INSTRUCTIONS

-J00102

REV. 10-16-2002

Kit Number 42476-95 and 42482-95

THREE-SLOT CHROME BRAKE PEDAL PAD AND COVER KIT

General

These kits fit all **1984 and later** FX Softail models (except FXSTDSE), and **1993 and later** FXDWG models.

Installation

1. Remove the locknut that secures the original equipment (OE) brake pedal pad. Discard the pad and locknut.
2. See the Service Parts Illustration. Align and place the new brake pedal cover (4) over the rubber tread (5).
3. Insert bolt (3), with the rubber H-D logo properly aligned, through the cover and tread, and into the hole in the brake pedal.
4. Position flat washer (1) onto the exposed bolt threads. Thread acorn nut (2) onto the bolt threads. Tighten the nut to 9-10 ft-lbs (12.2-13.6 Nm).

⚠ WARNING

Whenever the motorcycle brake components are serviced, always test it on dry, clean pavement at slow speeds before putting the vehicle into regular service. Failure to test brakes may lead to an accident which could result in death or serious injury.

sp42476

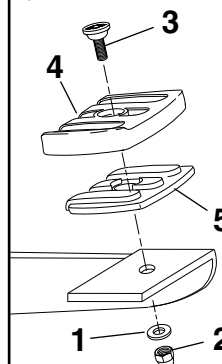

Kit 42476-95 (Horizontal slots):

Item	Description	Part No.
1	Flat washer	6423
2	Acorn nut	7949
3	Bolt (with logo)	42559-95
4	Brake pedal cover	44230-95
5	Rubber tread	44231-95

Kit 42482-95 (Vertical slots-shown):

Item	Description	Part No.
1	Flat washer	6423
2	Acorn nut	7949
3	Bolt (with logo)	44225-95
4	Brake pedal cover	44223-95
5	Rubber tread	44224-95

Figure 1. Kit Contents