



# INSTRUCTIONS

-J04052

2012-10-18

## FRONT REAPER WHEEL KITS

### GENERAL

#### ▲ WARNING

Install only wheels and installation kits approved for your model motorcycle. Contact a Harley-Davidson dealer to verify fitment. Mismatching wheels and installation kits or installing wheels not approved for your model can cause loss of control, which could result in death or serious injury. (00610c)

### Kit Numbers

40778-08, 40790-09, 40779-08, 41983-08, 43300198

### Models

For model fitment information, see the P&A Catalog or the Parts and Accessories section of [www.harley-davidson.com](http://www.harley-davidson.com) (English only).

#### NOTE

Accessory hub caps are not compatible with this wheel.

### Kit Contents

See the Service Parts section for kit contents.

### Additional Parts Required

These kits include the custom wheel only. Some kits also include a hub cap. The wheel installation kit must be purchased separately from a Harley-Davidson dealer. Refer to the Service Parts page for a complete description and part numbers for these items.

Proper installation of this kit requires the separate purchase of the following parts which are available at a Harley-Davidson dealer:

- Wheel Installation Kit (See Table 3 through Table 8 to determine required installation kit.)
- Brake Disc Screws (See Figure 1 and Table 1.)
- Wheel Bearing Remover and Installer (94134-09A)
- For Kit 40790-09 on 2004-2008 Touring models, separate purchase of tire 43371-07 is required. For 2009 and later models, tire 44026-09A is required.
- For Kit 40790-09 on 2004-2007 models, separate purchase of two brake rotors (44343-01) is required. For 2008-later models the separate purchase of two stock brake rotors (44553-06A) or two polished brake rotors (41500012) is required.
- For Kit 41983-08 and 43300198 on 2006 and Later Dyna models (except FXDWG and FXDF), separate purchase of stock brake disc (44553-06A) or polished brake rotor (41500012) is required.

### Recommended Parts

It is recommended that a floating brake rotor for kit 40779-08 be purchased separately if objectionable brake noise is experienced from the brake rotor. Refer to the P&A Catalog or the Parts and Accessories section of [www.harley-davidson.com](http://www.harley-davidson.com) for part numbers.

The following Harley-Davidson Genuine Motor Accessories are recommended for proper maintenance and cleaning:

- Harley® Bright™ Chrome Cleaner (94683-99) (Not for use on kit 43300198)
- Harley® Glaze™ Polish and Sealant (99701-84)
- Harley® Wheel and Spoke Brush (43078-99)
- Harley-Davidson® Wheel and Tire Cleaner (94658-98)
- Harley® Preserve™ Bare Aluminum Protectant (99845-07)

#### ▲ WARNING

The rider's safety depends upon the correct installation of this kit. Use the appropriate service manual procedures. If the procedure is not within your capabilities or you do not have the correct tools, have a Harley-Davidson dealer perform the installation. Improper installation of this kit could result in death or serious injury. (00333a)

#### NOTE

This instruction sheet references service manual information. A service manual for your model motorcycle is required for this installation and is available from a Harley-Davidson dealer.

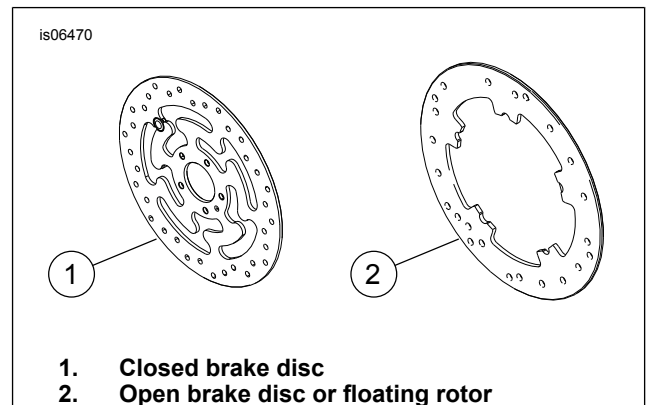

Figure 1. Front Brake Disc Styles

Table 1. Front Disc Hardware Fitment

Brake Disc	Hardware
Closed disc	5 Stock disc screws (3655A)
	Chrome screw kit (46646-05) includes 5 screws

**Table 1. Front Disc Hardware Fitment**

Brake Disc	Hardware
Open disc	5 Stock disc screws (3762M) and 5 disc washers (6966M)
NOTE: Models equipped with dual front brakes and models being equipped with a wheel with dual brake mounting surfaces require twice as many screws/washers (10 total screws or 2 chrome screw kits if available).	

## INSTALLATION

### NOTE

Use plastic protectors on tire mounting tools and rim clamps when mounting a tire to a painted wheel.

When mounting tires, liberally use tire lube on the wheel and tire.

For tire removal, use plastic inserts between the rim and tire after breaking the bead to create a large enough gap for the rim clamps to get into.

### NOTE

- Install short valve stem (43157-83A) included in the installation kit. Discard all other valve stems.

1. Remove existing front wheel assembly. Save axle, axle nut, brake disc and wheel spacers for kit installation. **For FXSTD Models:** Discard tapered spacer. Refer to FRONT WHEEL in service manual.

### NOTE

Install the primary bearing first using appropriate service manual and WHEEL BEARING REMOVER/INSTALLER.

#### For Kit 40778-08:

- **For 2006 and later FXDWG Models:** When correctly installed, the tire will be 2–5 mm (0.08–0.2 in) off of center, compared to the fender.
- The right side of the wheel has DOT markings.
- **For 2006 and earlier FX Softail Models and 2007 and earlier FXDWG Models:** The right side of the wheel is the primary bearing side.
- **For 2007 and later FX Softail Models and 2008 and later FXDWG Models:** The left side of the wheel is the primary bearing side.
- **For FXSTS models:** The right side is the brake disc side.
- **For all other models:** The left side is the brake disc side.

#### For Kit 40779-08:

- The left side of the wheel has cast-in markings in the hub pockets to identify it as the disc side and primary bearing side for installation.

#### For Kit 40790-09:

- **For 2008 and later Touring Models:** Install bearing shim (43903-08) from installation kit under the primary bearing during wheel assembly.
- The left side of the wheel has cast-in markings in the hub pockets to identify it as the disc side and primary bearing side for installation.

#### For Kit 41983-08 and 43300198:

- The left side of the wheel with the brake disc mounting tower and cast-in markings is the primary bearing side of the wheel.
- For 2008 and later Dyna models, install shim 41450-08 under the primary bearing.

2. See Figure 2. Install valve stem assembly (L ) on wheel. Refer to TIRES in service manual.

### NOTICE

**Do not re-use brake disc/rotor screws. Re-using these screws can result in torque loss and damage to brake components. (00319c)**

3. Assemble wheel installation kit components and brake disc(s) to wheel, using the appropriate service parts table. Refer to FRONT WHEEL in service manual.
4. **For FXSTD Models:** Install wheel kit and wheel spacer provided in installation kit in place of the tapered right side spacer discarded in Step 1. Refer to FRONT WHEEL in service manual. **For FXSTS Models:** Install the spacer provided in the installation kit between the stock left side spacer and the left fork. **For all other models:** Install previously removed wheel spacers. Refer to FRONT WHEEL in service manual.
5. Install front wheel (1), stock axle and stock axle nut. Refer to FRONT WHEEL in service manual.

## MAINTENANCE AND CLEANING

### NOTE

Some wheel assemblies include plugs that have been installed in the openings between the brake disc mounting holes on one side of the wheel. Missing or damaged plugs can be replaced using the Wheel Plug Kit (44459-04).

Chrome parts must be maintained regularly to keep their original shine and luster.

1. Clean heavily-soiled wheel surfaces using Harley-Davidson Wheel and Tire Cleaner, applied with the Harley Wheel and Spoke Brush.
2. Thoroughly clean chrome with a good quality chrome cleaner, such as Harley Bright Chrome Cleaner.
3. After cleaning and polishing, seal the finish with a good quality sealer, such as Harley Glaze Polish and Sealant.

## SERVICE PARTS

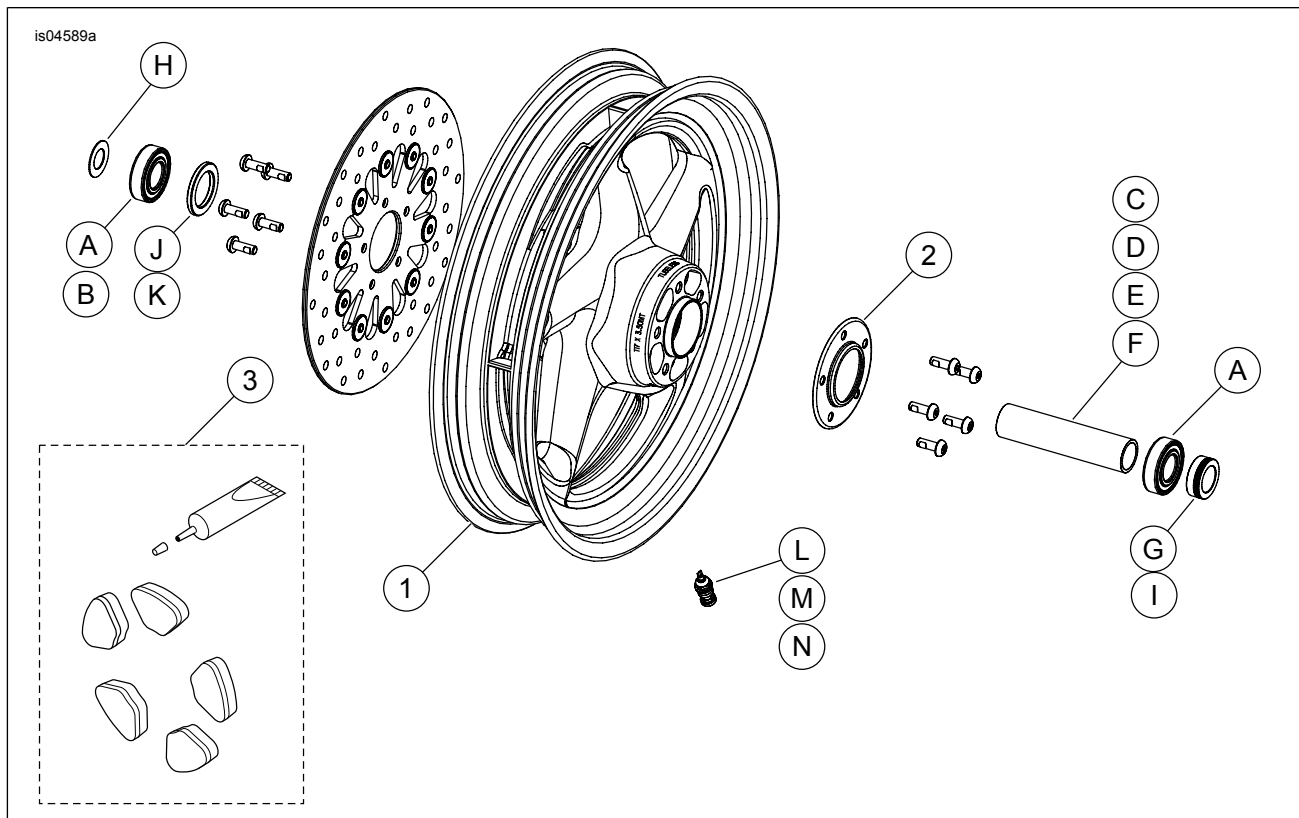

Figure 2. Front Reaper Wheel (21-inch wheel shown)

Table 2. Service Parts and Wheel Kit Contents

Kit	Item	Description (Quantity)	Part Number
40790-09, 41983-09, 43300198	1	Wheel	Not Sold Separately
40779-08, 40778-08	1	Wheel	Not Sold Separately
	2	Hub cap	43986-00
	3	Plug service kit (not included in kit)	44459-04

Table 3. FRONT 3/4 Inch Bearing Wheel Installation Kit (43833-07A)

FRONT 3/4 Inch Bearing Wheel Installation Kit (43833-07A)		ITEM (Quantity Used and Description)									
Fitment	Wheel Size	A	C	D	E	G	H	I	L	M	
2000-2006 FLST and FLSTF (except 2006 FLSTFSE2)	16 x 3.0 in	2	0	1	0	0	0	0	*	*	
2000-2006 FLSTC and FLSTN	16 x 3.0 in	2	0	1	0	0	0	0	1	*	
2006 FLSTFSEI	17 x 3.5 in	2	0	1	0	0	0	1	*	*	
2008-later FLSTSB	18 x 3.5 in	2	0	***	0	***	0	0	*	*	
2000-2007 XL; 2000-2003 Dyna (except FXDWG)	19 x 2.5 in	2	0	0	1	0	0	0	*	*	
2000-2007 XL; 2000-2003 Dyna (except FXDWG)	21 x 2.15 in	2	0	0	1	0	0	0	*	*	
2000-2006 FXST/B/C; 2000-2005 FXDWG**	21 x 2.15 in	2	1	0	0	0	0	0	*	*	
2000-2006 FXSTS**	21 x 2.15 in	2	1	0	0	0	1	0	*	*	
2000-2006 FXSTD (Except FXSTDSE)**	21 x 2.15 in	2	1	0	0	1	0	0	*	*	
Installation kits are designed to work with many different wheel styles and fitments. Contact a Harley-Davidson dealer to verify that the wheel and installation kits are both designed and approved for the motorcycle they are being installed on.		A	Bearing, regular (2)					9267			
NOTES:		C	Axle sleeve					43536-00			
* See <b>NOTE</b> above valve installation step in INSTALLATION to determine which valve stem to use for your particular kit. Discard other valve stem(s).		D	Axle sleeve					43608-00			
** The right side of the wheel is the primary bearing side for this fitment.		E	Axle sleeve					43613-00			
*** See INSTALLATION section for separate hardware kit to be used for FLSTSB models.		G	Spacer, axle					40910-00A			
		H	Spacer, axle					43313-98			
		I	Spacer, wheel					43617-00A			
		L	Valve stem, short					43157-83A			
		M	Valve stem, long					43206-01			

Table 4. FRONT 1 Inch Bearing Wheel Installation Kit (43848-08A)

FRONT 1 Inch Bearing Wheel Installation Kit (43848-08A)		ITEM (Quantity Used and Description)								
Fitment	Wheel Size	A	C	D	E	F	L	M		
2000-2007 Touring	16 x 3.0 in	2	1	0	0	0	*	*		
2004-2007 Touring	18 x 3.5 in	2	1	0	0	0	*	*		
2004-2005 Dyna (except FXDWG)	19 x 2.5 in	2	0	0	0	1	*	*		
2006-2007 Dyna (except FXDWG)	19 x 2.5 in	2	0	0	1	0	*	*		

**Table 4. FRONT 1 Inch Bearing Wheel Installation Kit (43848-08A)**

FRONT 1 Inch Bearing Wheel Installation Kit (43848-08A)		ITEM (Quantity Used and Description)						
Fitment	Wheel Size	A	C	D	E	F	L	M
2002-2007 VRSC	19 x 3.0 in	2	0	0	1	0	*	*
2006-2007 FXDWG**	21 x 2.15 in	2	0	1	0	0	*	*
2004-2005 Dyna (except FXDWG)	21 x 2.15 in	2	0	0	0	1	*	*
Installation kits are designed to work with many different wheel styles and fitments. Contact a Harley-Davidson dealer to verify that the wheel and installation kits are both designed and approved for the motorcycle they are being installed on. NOTES: * See <b>NOTE</b> above valve installation step in INSTALLATION to determine which valve stem to use for your particular kit. Discard other valve stem(s). ** The right side of the wheel is the primary bearing side for this fitment.		A	Bearing, regular (2)				9247	
		C	Axle sleeve				43517-00	
		D	Axle sleeve				43633-06	
		E	Axle sleeve				43641-01	
		F	Axle sleeve				43755-04	
		L	Valve stem, short				43157-83A	
		M	Valve stem, long				43206-01	

**Table 5. FRONT 25 mm Bearing Wheel Installation Kit (41455-08C)**

FRONT 25 mm Bearing Wheel Installation Kit (41455-08C)		ITEM (Quantity Used and Description)							
Fitment	Wheel Size	A	C	D	J	K	L	M	N
2008 Touring; 2009 and later FLHRC (non-ABS) and Trike (non-ABS)	16 x 3.0 in	2	0	1	0	1	*	*	*
2009 and later Touring (non-ABS)	17 x 3.0 in	2	0	1	0	0	*	*	*
2008 and later Touring (non-ABS)	18 x 3.5 in	2	0	1	0	**	*	*	*
2008 and later Dyna (except FLD, FXDWG and FXDF)	19 x 2.5 in	2	1	0	**	0	*	*	0
2008 and later VRSCAW, VRSCD, VRSCF and VRSCDX (non-ABS)	19 x 3.0 in	2	1	0	**	0	*	*	0
2009 and later Touring (non-ABS)	19 x 3.5 in	2	0	1	0	0	*	*	*
Installation kits are designed to work with many different wheel styles and fitments. Contact a Harley-Davidson dealer to verify that the wheel and installation kits are both designed and approved for the motorcycle they are being installed on. NOTES: * See <b>NOTE</b> above valve installation step in INSTALLATION to determine which valve stem to use for your particular kit. Discard other valve stem(s). ** See <b>NOTES</b> for your wheel kit above the wheel assembly step in INSTALLATION to determine if bearing shim is used for your particular wheel kit and fitment. *** Bearing shim installed under the primary bearing.		A	Bearing, regular (2)				9276		
		C	Axle sleeve				41748-08		
		D	Axle sleeve				41900-08		
		J	Bearing shim***				41450-08		
		K	Bearing shim***				43903-08		
		L	Valve stem, short				43157-83A		
		M	Valve stem, long				43206-01		
	N	Valve stem, pull thru				40999-87			

**Table 6. FRONT 25 mm Bearing Wheel Installation Kit (43851-11A)**

FRONT 25 mm Bearing Wheel Installation Kit (43851-11A)		ITEM (Quantity Used and Description)							
Fitment	Wheel Size	A	C	G	H	J	L	M	N
2007 and later FLSTC, FLSTN and FLS (non-ABS)	16 x 3.0 in	2	1	0	1	1	*	*	*
2008 and later FXDF	16 x 3.0 in	2	1	0	0	0	*	*	*
2007 and later FLSTF and FLSTFB (non-ABS)	17 x 3.5 in	2	1	0	0	0	*	*	*
2008 and later FLSTF and FLSTFB (non-ABS)	18 x 3.5 in	2	1	0	0	0	*	*	*
2008 and later FXDF; 2012 and later FLD	18 x 3.5 in	2	1	0	0	0	*	*	*
2007 and later FXS, FXST/B/C (non-ABS); 2008 and later FXDWG***	21 x 2.15 in	2	1	0	0	1	*	*	*
2007 FXSTD***	21 x 2.15 in	2	1	1	0	1	*	*	*
Installation kits are designed to work with many different wheel styles and fitments. Contact a Harley-Davidson dealer to verify that the wheel and installation kits are both designed and approved for the motorcycle they are being installed on. NOTES: * See <b>NOTE</b> above valve installation step in INSTALLATION to determine which valve stem to use for your particular kit. Discard other valve stem(s). ** Bearing shim installed under the primary bearing. *** The left side of the wheel is the primary bearing side for this fitment.		A	Bearing, regular (2)				9276		
		C	Axle sleeve				41349-07		
		G	Spacer, axle				41504-07		
		H	Spacer, axle				41695-07		
		J	Bearing shim**				43315-07		
		L	Valve stem, short				43157-83A		
		M	Valve stem, long				43206-01		
	N	Valve stem, pull-thru				40999-87			

**Table 7. FRONT 25 mm Bearing ABS Wheel Installation Kit (41454-08B)**

FRONT 25 mm Bearing ABS Wheel Installation Kit (41454-08B)		ITEM (Quantity Used and Description)								
Fitment	Wheel Size	A	B	C	D	J	K	L	M	N
2008 Touring and 2009 and later FLHRC with ABS	16 x 3.0 in	1	1	0	1	0	1	*	*	0
2009 and later Touring with ABS	17 x 3.0 in	1	1	0	1	0	0	*	*	*
2008 and later Touring with ABS	18 x 3.5 in	1	1	0	1	**	**	*	*	*
2012 and later Dyna with ABS (Except FLD, FXDWG and FXDF)	19 x 2.5 in	1	1	1	0	**	**	*	*	0
2008 and later VRSCAW, VRSCD, VRSCF and VRSCDX with ABS	19 x 3.0 in	1	1	1	0	**	**	*	*	0
2009 and later Touring with ABS	19 x 3.5 in	1	1	0	1	0	0	*	*	*

**Table 7. FRONT 25 mm Bearing ABS Wheel Installation Kit (41454-08B)**

FRONT 25 mm Bearing ABS Wheel Installation Kit (41454-08B)		ITEM (Quantity Used and Description)									
Fitment	Wheel Size	A	B	C	D	J	K	L	M	N	
Installation kits are designed to work with many different wheel styles and fitments. Contact a Harley-Davidson dealer to verify that the wheel and installation kits are both designed and approved for the motorcycle they are being installed on. NOTES: * See <b>NOTE</b> above valve installation step in INSTALLATION to determine which valve stem to use for your particular kit. Discard other valve stem(s). ** See <b>NOTES</b> for your wheel kit above the wheel assembly step in INSTALLATION to determine which bearing shim to use for your particular wheel kit and fitment. *** Red side of bearing must be installed toward the wheel. The ABS bearing is primary. **** Bearing shim installed under the primary bearing.		A	Bearing, regular					9276			
		B	Bearing, ABS***					9252			
		C	Axle sleeve					41748-08			
		D	Axle sleeve					41900-08			
		J	Bearing shim****					41450-08			
		K	Bearing shim****					43903-08			
		L	Valve stem, short					43157-83A			
		M	Valve stem, long					43206-01			
		N	Valve stem, pull thru					40999-87			

**Table 8. FRONT 25 mm Bearing ABS Wheel Installation Kit (42400010)**

FRONT 25 mm Bearing ABS Wheel Installation Kit (42400010)		ITEM (Quantity Used and Description)									
Fitment	Wheel Size	A	B	C	G	J	K	L	M	N	
2011 and later FLSTC, FLSTN and FLS with ABS	16 x 3.0 in	1	1	1	1	0	1	*	*	*	
2012 and later FXDF with ABS	16 x 3.0 in	1	1	1	0	0	0	*	*	*	
2011 and later FLSTF and FLSTFB with ABS	17 x 3.5 in	1	1	1	0	0	0	*	*	*	
2011 and later FLSTF and FLSTFB with ABS	18 x 3.5 in	1	1	1	0	0	0	*	*	*	
2012 and later FXDF and FLD with ABS	18 x 3.5 in	1	1	1	0	0	0	*	*	*	
2011 and later FXS, FXST and 2012 and later FXDWG with ABS	21 x 2.15 in	1	1	1	0	0	1	*	*	*	
Installation kits are designed to work with many different wheel styles and fitments. Contact a Harley-Davidson dealer to verify that the wheel and installation kits are both designed and approved for the motorcycle they are being installed on. NOTES: * See <b>NOTE</b> above valve installation step in INSTALLATION to determine which valve stem to use for your particular kit. Discard other valve stem(s). ** Red side of bearing must be installed toward the wheel. The ABS bearing is the primary bearing. *** Bearing shim installed under the primary bearing.		A	Bearing, regular					9276A			
		B	Bearing, ABS**					9252			
		C	Axle sleeve					41349-07			
		G	Spacer					41695-07			
		J	Bearing shim***					41448-08			
		K	Bearing shim***					43315-07			
		L	Valve stem, short					43157-83A			
		M	Valve stem, long					43206-01			
	N	Valve stem, pull-thru					40999-87				