



INSTRUCTIONS

-J04688

REV. 2008-02-12

REAR AXLE-NUT COVER KIT

GENERAL

Kit Number

41704-09, 41705-09, 41706-09

Models

For model fitment information, please see the P&A Retail Catalog or the Parts and Accessories section of www.harley-davidson.com (English only).

Additional Parts Required

WARNING

The rider's safety depends upon the correct installation of this kit. Use the appropriate service manual procedures. If the procedure is not within your capabilities or you do not have the correct tools, have a Harley-Davidson dealer perform the installation. Improper installation of this kit could result in death or serious injury. (00333a)

NOTE

This instruction sheet references Service Manual information. A Service Manual for your model motorcycle is required for this installation and is available from a Harley-Davidson Dealer.

Kit Contents

See Figure 1 and Table 1.

INSTALLATION

NOTES

The shorter axle-nut cover mounts to the right side of the motorcycle.

Axles that have been removed for service, replacement or repair may have been assembled in reverse orientation from their stock design. Axle-nut covers may not fit properly on reversed axles. Refer to the appropriate Service Manual for correct axle orientation.

1. Adjust the position of the exhaust system (if necessary) to provide axle-nut clearance.
2. Position each axle-nut cover over the appropriate axle nut.
3. The skull version nut covers have two set screws per cover. Position the logo and snug up one set screw to hold in place and the other to prevent rotation.
4. Tighten the axle-nut cover set screws to 70 in-lb (7.9 Nm).

NOTE

The set screws in this kit are treated with a thread-locking compound. When replacing or re-installing the set screws (2), apply Loctite® 243 (Blue) Threadlocker and Sealant (Harley-Davidson Part Number 99642-97) to the set screw threads.

SERVICE PARTS

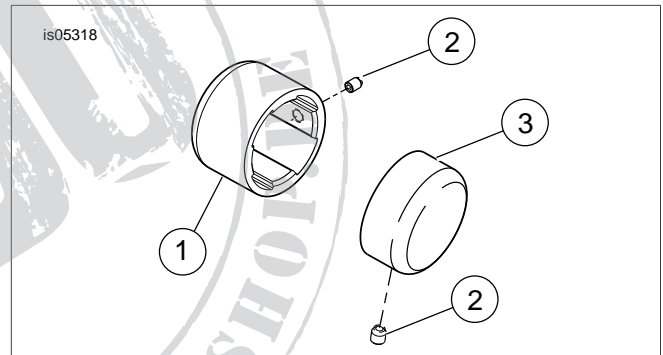

Figure 1. Service Parts: Rear Axle-Nut Cover Kit

Table 1. Service Parts: Rear Axle-Nut Cover Kit

Item	Description (Quantity)	Part Number
1	Axle-nut cover, left side	Not Sold Separately
2	Set screw, 10-24 x 1/4 inch (2)	Not Sold Separately
3	Axle-nut cover, right side	Not Sold Separately