



INSTRUCTIONS

-J05658

2015-06-26

BILLET BRAKE LEVER KITS

GENERAL

Kit Numbers

41600079, 41600082, 41600146, 41600208

Models

For model fitment information, see the P&A retail catalog or the Parts and Accessories section of www.harley-davidson.com (English only).

Installation Requirements

Separate purchase of Wheel Bearing Grease (Part No. 99856-92) is required for proper installation of this kit. See a Harley-Davidson dealer.

Proper installation of this kit also requires installing a brake pedal pad, sold separately. Refer to the appropriate parts catalog for an original equipment (OE) replacement rubber pad. See the P&A retail catalog for a selection of accessory brake pedal pads.

▲ WARNING

The rider's safety depends upon the correct installation of this kit. If the procedure is not within your capabilities or you do not have the correct tools, have a Harley-Davidson dealer perform the installation. Improper installation of this kit could result in death or serious injury. (00308a)

Kit Contents

See Figure 1 and Table 1.

REMOVAL

1. See Figure 1. Remove the cotter pin and washer (A) from the master cylinder clevis pin. Discard the cotter pin.

NOTE

The clevis pin has a slight interference fit. Use pliers to pull the clevis pin from the pushrod. Do not damage mating parts.

2. Remove the clevis pin (B) from the brake rod. Save for installation. Thoroughly clean and examine parts for wear. Replace if necessary.
3. Remove the brake lever mounting nut and flat washer and discard. Remove and discard the outer O-ring.
4. Remove the brake lever by rotating counterclockwise. Lift the master cylinder clevis if necessary. Pull the lever from the shaft. Remove and discard the inner O-ring (C).
5. Thoroughly clean the lever mounting shaft of grease and dirt.

INSTALLATION

NOTE

This Billet-Style Brake Lever has self-lubricating bushings. However, on FLHT and FLTR models, apply a thin film of wheel bearing grease (Part No. 99856-92, purchased separately) to the mounting shaft and bushings before installation.

1. See Figure 1. Insert new O-rings (3) on either side of the lever bushings. Install the new billet style brake lever (1) onto the shaft.
2. Align the holes in the lever and brake rod and insert the stock clevis pin (B).
3. Install the small saved flat washer onto the clevis pin. Insert the new cotter pin (2).
4. Install the large flat washer (4) and locknut (5) from the kit. Tighten the locknut to 20–27 N·m (15–20 ft-lbs).
5. Install the brake pedal pad to the brake lever.

▲ WARNING

After repairing the brake system, test brakes at low speed. If brakes are not operating properly, testing at high speeds can cause loss of control, which could result in death or serious injury. (00289a)

6. Check the brake lever for proper operation and clearance through its full travel.

SERVICE PARTS

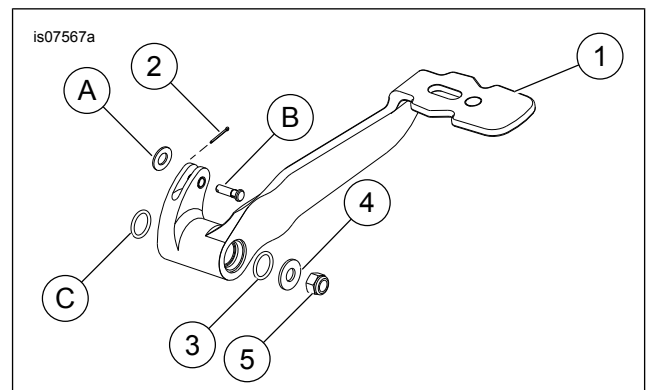

Figure 1. Service Parts: Rear Brake Lever (Typical Shown)

Table 1. Service Parts

Item	Description (Quantity)	Part Number
1	Brake lever assembly	Not Sold Separately
2	Cotter pin	515
3	O-ring (2)	11900021
4	Washer, 7/16 inch	6416

-J05658



Many Harley-Davidson® Parts & Accessories are made of plastics and metals which can be recycled. Please dispose of materials responsibly.

1 / 2

Table 1. Service Parts

Item	Description (Quantity)	Part Number
5	Locknut, 7/16 inch	7825
Items mentioned in text, but not included in kit.		
A	Washer	
B	Clevis pin	
C	Inner O-ring	