



INSTRUCTIONS

-J04963

REV. 2009-06-03

FRONT STINGER WHEELS

GENERAL

Kit Numbers

47831-10, 41503-10

Models

For model fitment information, see the P&A Retail Catalog or the Parts and Accessories section of www.harley-davidson.com (English only).

Additional Parts Required

Accessory hub caps are not compatible with this wheel.

This kit includes the custom wheel only.

Proper installation of this kit requires the separate purchase of a tire (41999-07A).

Proper installation of this kit requires the separate purchase of the following parts which are available at a Harley-Davidson dealer:

- Wheel Bearing Remover and Installer (HD-44060-A)
- A Wheel Installation Kit (see Service Parts Tables for part number)

For FLSTSB Models: Separate purchase of Hardware Kit (41533-10) is required for proper installation of this kit.

WARNING

The rider's safety depends upon the correct installation of this kit. Use the appropriate service manual procedures. If the procedure is not within your capabilities or you do not have the correct tools, have a Harley-Davidson dealer perform the installation. Improper installation of this kit could result in death or serious injury. (00333a)

NOTE

This instruction sheet references service manual information. A service manual for your model motorcycle is required for this installation and is available from a Harley-Davidson Dealer.

Recommended Additional Parts

The following Harley-Davidson Genuine Motor Accessories are recommended for proper maintenance and cleaning:

- Harley® Bright™ Chrome Cleaner (94683-99)
- Harley® Glaze™ Polish and Sealant (99701-84)
- Harley® Wheel and Spoke Brush (43078-99)
- Harley-Davidson® Wheel and Tire Cleaner (94658-98)

Kit Contents

See Figure 1 and the Service Parts Tables.

INSTALLATION

1. Remove existing front wheel assembly. Save axle, axle nut, brake disc and wheel spacers for kit installation. See the service manual.

CAUTION

Do not re-use brake disc/rotor screws. Re-using these screws can result in torque loss and damage to brake components. (00319c)

2. See Figure 1. Install valve stem assembly (D) on wheel. See the service manual.
3. Assemble wheel installation kit components and brake disc(s) to wheel, using the appropriate service parts table. See the service manual.

If Installing Kit 41503-10 on a FLSTSB Model: Install sleeve from hardware kit (41533-10).

NOTE

For FLSTSB Models: The primary bearing will protrude from the bearing bore slightly when fully seated.

4. Install primary bearing with a Wheel Bearing Remover and Installer. See the service manual. The primary side of the wheel is the brake disc side.

For Kit 47831-10: The primary side of the wheel is indicated by the single groove machined into the rotor mounting face.

For Kit 41503-10: The brake rotor mounting face indicates the primary bearing side.

NOTE

Only install the required (separately purchased) tire.

5. Install separately purchased tire (41999-07A). See the service manual.
6. Install spacers (previously removed).

If Installing Kit 41503-10 on a FLSTSB Model: Discard the axle spacer between the fork and left side of the wheel and use the axle spacer from the Hardware Kit (41533-10, purchased separately).

7. Install front wheel (1) and stock axle. See the service manual.

MAINTENANCE AND CLEANING

Chrome parts must be maintained regularly so they keep their original shine and luster.

1. Clean heavily-soiled wheel surfaces using Harley-Davidson Wheel and Tire Cleaner, applied with Harley Wheel and Spoke Brush.
2. Thoroughly clean chrome with a good quality chrome cleaner, such as Harley Bright Chrome Cleaner.
3. After cleaning and polishing, seal the finish with a good quality sealer, such as Harley Glaze Polish and Sealant.



SERVICE PARTS

is06190

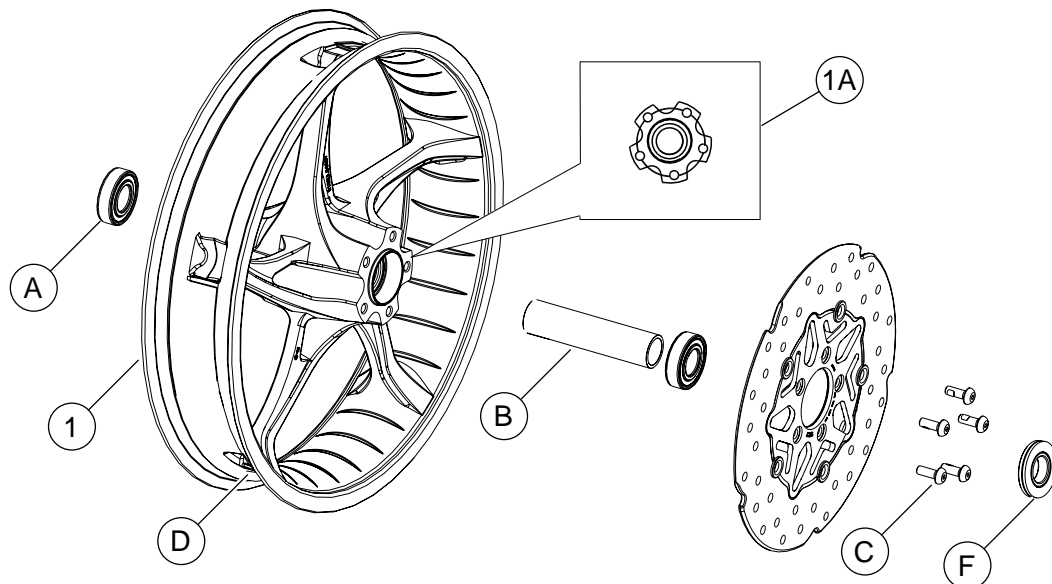

Figure 1. Service Parts: Front Stinger Wheel

Table 1. Service Parts Table

Kit	Installation Kit	Item	Description (Quantity)	Part Number	
47831-10		1	Wheel	Not Sold Separately	
		1A	Machined groove	Not Sold Separately	
		Items requiring separate purchase:			
2008 and later FXDF	43851-08A Front 18x3.5 inch Fitment	A	Bearing (2)	9276	
		B	Sleeve, bearing spacer	41349-07	
		C	Screw (10)	3655A	
		D	Valve stem assembly (long)	43206-01	
		NOTE: Discard the following components which are provided with this installation kit, but are not required for this fitment.			
			Shim, bearing	43903-08	
			Valve stem assembly (short)	43157-83A	
			Valve stem assembly (short)	40999-87	
			Sleeve, bearing spacer	41900-08	
			Spacer, axle	41695-07	
	Spacer, axle	41504-07			
	Shim, bearing (install under primary bearing)	43315-07			

Table 2. Service Parts Table

Kit	Installation Kit	Item	Description (Quantity)	Part Number
41503-10		1	Wheel	Not Sold Separately
		1A	Machined groove	Not Sold Separately
		Items requiring separate purchase:		

Table 2. Service Parts Table

Kit	Installation Kit	Item	Description (Quantity)	Part Number	
2008 and later FLSTSB	43833-07 Front 18x3.5 inch Fitment	A	Bearing (2)	9267	
		C	Screw (5)	3655A	
		D	Valve stem assembly (short)	43157-83A	
		NOTE: Discard the following components which are provided with this installation kit, but are not required for this fitment.			
		Valve stem assembly			43206-01
		Spacer, axle			43313-98
		Spacer, axle			40910-00A
		Spacer, axle			43617-00A
		Sleeve, bearing spacer			43613-00
		Sleeve, bearing spacer			43536-00
		Sleeve, bearing spacer			43608-00
		Screw (5)			3655A
	41533-10 Front 18x3.5 inch Fitment	B	Sleeve, bearing spacer	11926	
		F	Spacer, axle	11925	
	2008 and later FLSTF, FLSTFB	43851-08A Front 18x3.5 inch Fitment	A	Bearing (2)	9276
B			Sleeve, bearing spacer	41349-07	
C			Screw (5)	3655A	
D			Valve stem assembly (short)	43157-83A	
NOTE: Discard the following components which are provided with this installation kit, but are not required for this fitment.					
Shim, bearing			43903-08		
Shim, bearing			43315-07		
Valve stem assembly (long)			43206-01		
Sleeve, bearing spacer			41900-08		
Spacer, axle			41695-07		
Spacer, axle			41504-07		
Screw (5)			3655A		
Valve stem assembly			40999-87		

