



INSTRUCTIONS

-J04058

REV. 2007-04-10

FRONT DISC WHEELS

GENERAL

Kit Numbers

41274-08, 41022-07, 41031-07, 41322-07 and 41271-07

Models

For model fitment information, please see the P&A Retail Catalog or the Parts and Accessories section of www.harley-davidson.com (English only).

NOTE

Accessory hub caps are not compatible with this wheel.

Additional Parts Required

These kits include the custom wheel and hub cap only, except for Kit 41274-08, which only includes a wheel. Refer to the Service Parts section for a complete description, and part numbers for these items.

Proper installation of this kit requires the separate purchase of the following parts which are available at a Harley-Davidson dealer:

- Wheel Bearing Remover and Installer (HD-44060)
- Wheel Installation Kit (See Service Parts Tables for part number)

The following Harley-Davidson Genuine Motor Accessories are recommended for proper maintenance and cleaning:

- Harley® Bright™ Chrome Cleaner (94683-99)
- Harley® Glaze™ Polish and Sealant (99701-84)
- Harley® Wheel and Spoke Brush (43078-99)
- Harley-Davidson® Wheel and Tire Cleaner (94658-98)

WARNING

The rider's safety depends upon the correct installation of this kit. Use the appropriate service manual procedures. If the procedure is not within your capabilities or you do not have the correct tools, have a Harley-Davidson dealer perform the installation. Improper installation of this kit could result in death or serious injury. (00333a)

NOTE

This instruction sheet references Service Manual information. A Service Manual for your model motorcycle is required for this installation and is available from a Harley-Davidson Dealer.

Kit Contents

See the Service Parts section for kit contents.

INSTALLATION

1. Remove existing front wheel assembly. Save axle, axle nut, brake disc, and wheel spacers for kit installation. Refer to FRONT WHEEL in Service Manual.

For FLSTC and FLSTN Models: Discard moon-style hub cap.

2. See Figure 1. Install valve stem assembly (D) on wheel. Refer to TIRES in Service Manual.

CAUTION

Do not re-use brake disc screws. Re-using disc screws can result in torque loss and damage to rotor and/or brake assembly. (00319b)

NOTES

Install the primary bearing first using appropriate Service Manual and WHEEL BEARING REMOVER/INSTALLER. The side opposite the valve stem is the primary bearing side.

The front wheel should be installed so that the valve stem is on the right side of the motorcycle.

3. Assemble wheel installation kit components and brake disc(s) to wheel, using the appropriate the service parts table. Refer to FRONT WHEEL in Service Manual.
4. **FLSTC and FLSTN models:** Install wheel kit and right hand wheel spacer provided in kit installation.
All other models: Install wheel spacers previously removed.
5. Install front wheel (1), stock axle, and stock axle nut. Refer to FRONT WHEEL in Service Manual.

MAINTENANCE AND CLEANING

Chrome parts must be maintained regularly to ensure that they keep their original shine and luster.

1. Clean heavily-soiled wheel surfaces using Harley-Davidson Wheel and Tire Cleaner, applied with Harley Wheel and Spoke Brush.
2. Thoroughly clean chrome with a good quality chrome cleaner, such as Harley Bright Chrome Cleaner.
3. After cleaning and polishing, seal the finish with a good quality sealer, such as Harley Glaze Polish and Sealant.

SERVICE PARTS

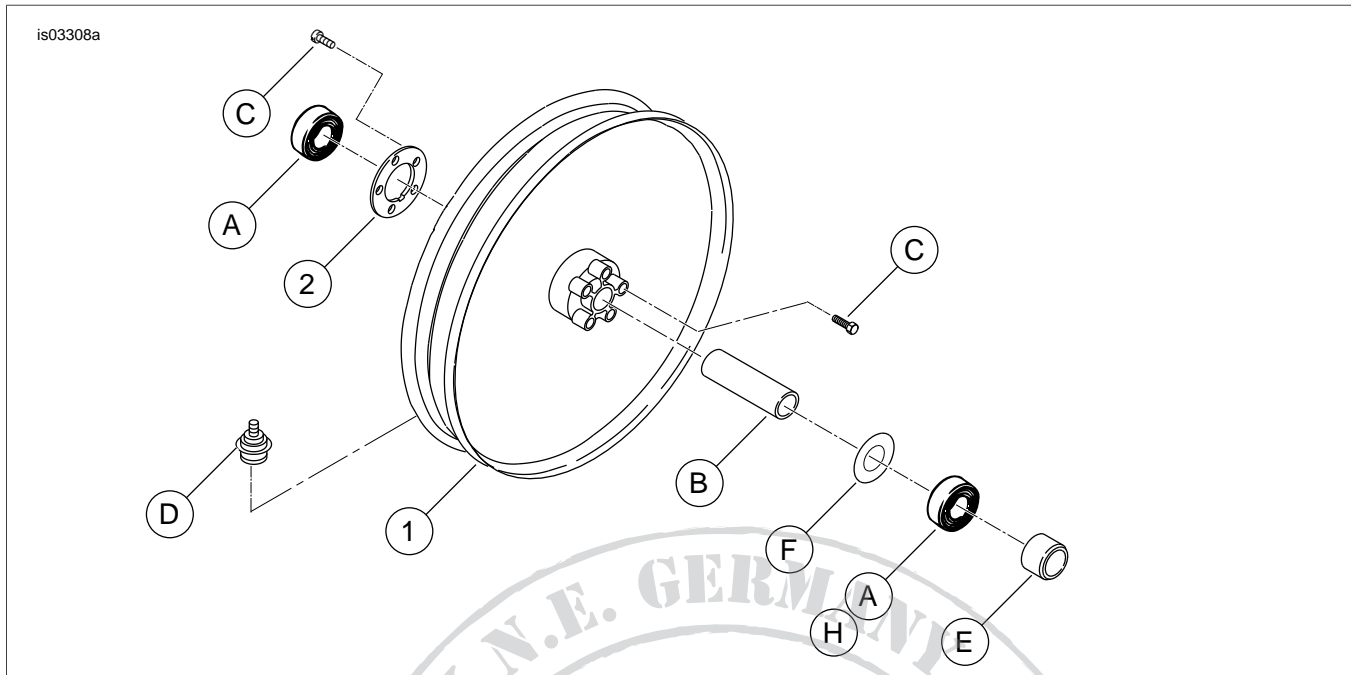

Figure 1. Service Parts: Front Disc Wheels

Table 1. Service Parts Table

| Kit | Installation Kit | Item | Description (Quantity) | Part Number | |
|--------------------------|-------------------------------------|---|------------------------|---------------------|--|
| 41274-08 | | 1 | Wheel | Not Sold Separately | |
| | | Items requiring separate purchase: | | | |
| 2000-2007 Touring Models | 43848-08 Front 16x3 inch Fitment | A | Bearing (2) | 9247 | |
| | | B | Sleeve, bearing spacer | 43517-00 | |
| | | C | Screws (10) | 3655A | |
| | | D | Valve stem | 43206-01 | |
| | | Discard the following components which are provided with this installation kit but are not required for this fitment. | | | |
| | | | Sleeve, bearing spacer | 43633-06 | |
| | | | Sleeve, bearing spacer | 43641-01 | |
| | | | Sleeve, bearing spacer | 43755-04 | |
| | | | Screw, TORX® (10) | 3762M | |
| | | | Washer (10) | 6966M | |
| | Valve stem | 43157-83A | | | |

Table 1. Service Parts Table

| Kit | Installation Kit | Item | Description (Quantity) | Part Number |
|---|--|--|--|-------------|
| 2008 and later Touring Models without ABS | 43851-08 Front 16x3 inch Fitment | A | Bearing (2) | 9276 |
| | | B | Sleeve, bearing spacer | 41900-08 |
| | | C | Screws (10) | 3655A |
| | | D | Valve stem | 43206-01 |
| | | F | Shim, bearing (install under primary bearing) | 43903-08 |
| | | Discard the following components which are provided with this installation kit, but are not required for this fitment. | | |
| | | Shim, bearing | | 43315-07 |
| | | Sleeve, bearing spacer | | 41349-07 |
| | | Spacer, axle | | 41695-07 |
| | | Spacer, axle | | 41504-07 |
| | | Valve stem | | 43157-83A |
| 2008 and later Touring Models with ABS | 41454-08 Front 16x3 inch Fitment | A | Bearing | 9276 |
| | | B | Sleeve, bearing spacer | 41900-08 |
| | | C | Screws (10) | 3655A |
| | | D | Valve stem | 43206-01 |
| | | F | Shim, bearing (install under primary bearing) | 43903-08 |
| | | H | Bearing, ABS (Red side must face inward) | 9252 |
| | Discard the following components which are provided with this installation kit, but are not required for this fitment. | | | |
| | | Shim, bearing | | 41450-08 |
| | | Sleeve, bearing spacer | | 41748-08 |
| | | Screw, TORX (10) | | 3762M |
| | | Washers (10) | | 6966M |
| | Valve stem | | 43157-83A | |

Table 2. Service Parts Table

| Kit | Installation Kit | Item | Description (Quantity) | Part Number |
|--|------------------|------------------------------------|------------------------|---------------------|
| 41322-07, 41022-07, 41031-07, 41271-07 | | 1 | Wheel | Not Sold Separately |
| | | 2 | Hub cap | 41025-00 |
| | | Items requiring separate purchase: | | |

Table 2. Service Parts Table

| Kit | Installation Kit | Item | Description (Quantity) | Part Number | |
|--|--------------------------------|--|---|-------------|-----------|
| 2000-2006 FLST, FLSTC, FLSTF and FLSTN (Not 2006 FLSTFSE2) <ul style="list-style-type: none"> For FLSTC and FLSTN Models: Wheel spacer (43617-00A) is included to replace the moon-style hub cap. | 43833-07 Front 16x3 Fitment | A | Bearing (2) | 9267 | |
| | | B | Sleeve, bearing spacer | 43608-00 | |
| | | C | Screws (10) | 3655A | |
| | | D | Valve stem | 43157-83A | |
| | | E | Spacer, axle (FLSTC and FLSTN only) | 43617-00A | |
| | | Discard the following components which are provided with this installation kit but are not required for this fitment. | | | |
| | | Sleeve, bearing spacer | | | 43536-00 |
| | | Sleeve, bearing spacer | | | 43613-00 |
| | | Valve stem | | | 43206-01 |
| | | Spacer, axle | | | 43313-98 |
| | | Spacer, axle | | | 40910-00A |
| 2007 and later FLSTC and FLSTN <ul style="list-style-type: none"> For FLSTC and FLSTN Models: Wheel spacer (41695-07) is included to replace the moon-style hub cap. | 43851-08 Front 16x3 Fitment | A | Bearing (2) | 9276 | |
| | | B | Sleeve, bearing spacer | 41349-07 | |
| | | C | Screws (10) | 3655A | |
| | | D | Valve stem | 43157-83A | |
| | | E | Spacer, axle (FLSTN and FLSTC only) | 41695-07 | |
| | | F | Shim, bearing (install under primary [left side] bearing) | 43315-07 | |
| | | Discard the following components which are provided with this installation kit, but are not required for this fitment. | | | |
| | | Shim, bearing | | | 43903-08 |
| | | Sleeve, bearing spacer | | | 41900-08 |
| | | Spacer, axle | | | 41504-07 |
| | | Valve stem | | | 43206-01 |

