



# INSTRUCTIONS

-J05728

2015-04-06

## SE PRO MANUAL PRIMARY CHAIN ADJUSTER

### GENERAL

#### Kit Number

36500020

#### Models

For model fitment information, see the P&A Retail Catalog or the Parts and Accessories section of [www.harley-davidson.com](http://www.harley-davidson.com) (English only).

#### Additional Parts Required

Proper installation of this kit requires the separate purchase of a primary cover gasket and other seals, that vary depending on the model. See your authorized Harley-Davidson dealer for the proper parts.

#### Kit Contents

See Figure 4 and Table 2.

### INSTALLATION

1. Refer to the appropriate service manual and remove seat.
2. Disconnect negative battery cable.
3. Refer to the appropriate service manual and remove primary cover.
4. See Figure 1. Remove two screws with the OE automatic tensioner from the primary case. Remove the tensioner. Save the two screws.

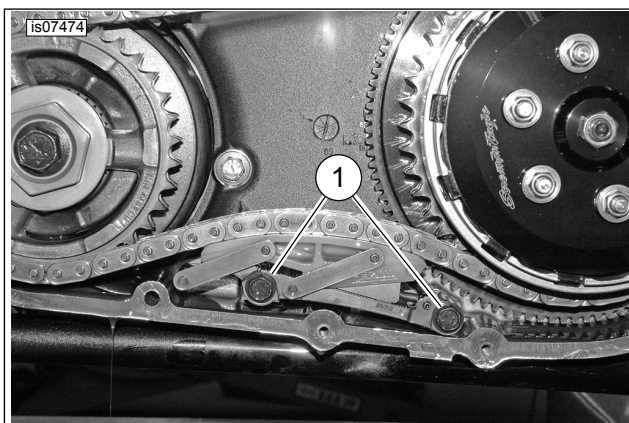
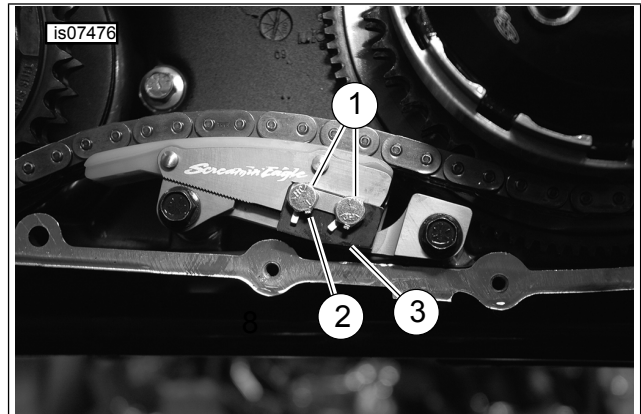

Figure 1. Remove Two Screws

5. Install the lower adjuster from the kit using two screws from previous tensioner. Tighten screws to 28.4–32.5 N·m (21–24 ft-lbs).



1. Screws (2)
2. Lock plate
3. Side plate

Figure 2. Install Cap Screws to Side Plate and Lock Plate

6. See Figure 2. Install the upper adjuster with shoe. Install the two hex cap screws (1) through the lock plate (2) and the side plate (3) and loosely assemble to upper adjuster.
7. Check the primary chain tension. Push on the upper strand to verify that it has free up and down movement midway between the engine compensating sprocket (front) and the clutch sprocket (rear).
8. Measure the free play to be sure that it falls within the range specified for a hot or cold engine. Refer to Table 1.

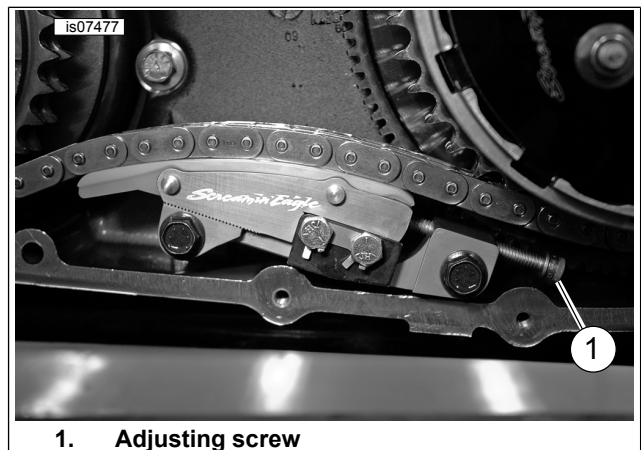

1. Adjusting screw

Figure 3. Adjusting the Chain

#### NOTICE

To prevent primary drive damage, remove adjustment screw from tensioner when adjustment is complete. (00625d)

-J05728

Many Harley-Davidson® Parts & Accessories are made of plastics and metals which can be recycled. Please dispose of materials responsibly.

1 / 2

9. See Figure 3 and Table 1. Using a ball end hex driver for the socket head cap screw adjust the chain tension to specifications.
10. Tighten side plate screws to 6.2–6.8 N·m (55–60 **in-lbs**). Bend a tab of the lock plate for each hex cap screw choosing a tab that is closest to a flat on head of the hex cap screw.

**NOTE**

As chains stretch and wear, they run tighter at one spot than another. Always adjust the free play at the tightest spot in the chain. Replace the primary chain if it is worn to the point where it cannot be properly adjusted.

Always keep the primary chain properly adjusted. Allowing the chain to run too tight or too loose will result in excessive chain and sprocket wear.

11. Remove the adjuster screw after tightening and save the screw to reuse.
12. Replace the primary cover and fill with lubricant as needed.
13. Connect negative cable to battery.
14. Refer to the appropriate service manual and install seat.

**Table 1. Primary Chain Adjustment**

FreePlay	Inches	Millimeters
Cold Engine	5/8-7/8 inch	15.9-22.2 mm
Hot Engine	3/8-5/8 inch	9.5-15.9 mm

**SERVICE PARTS**

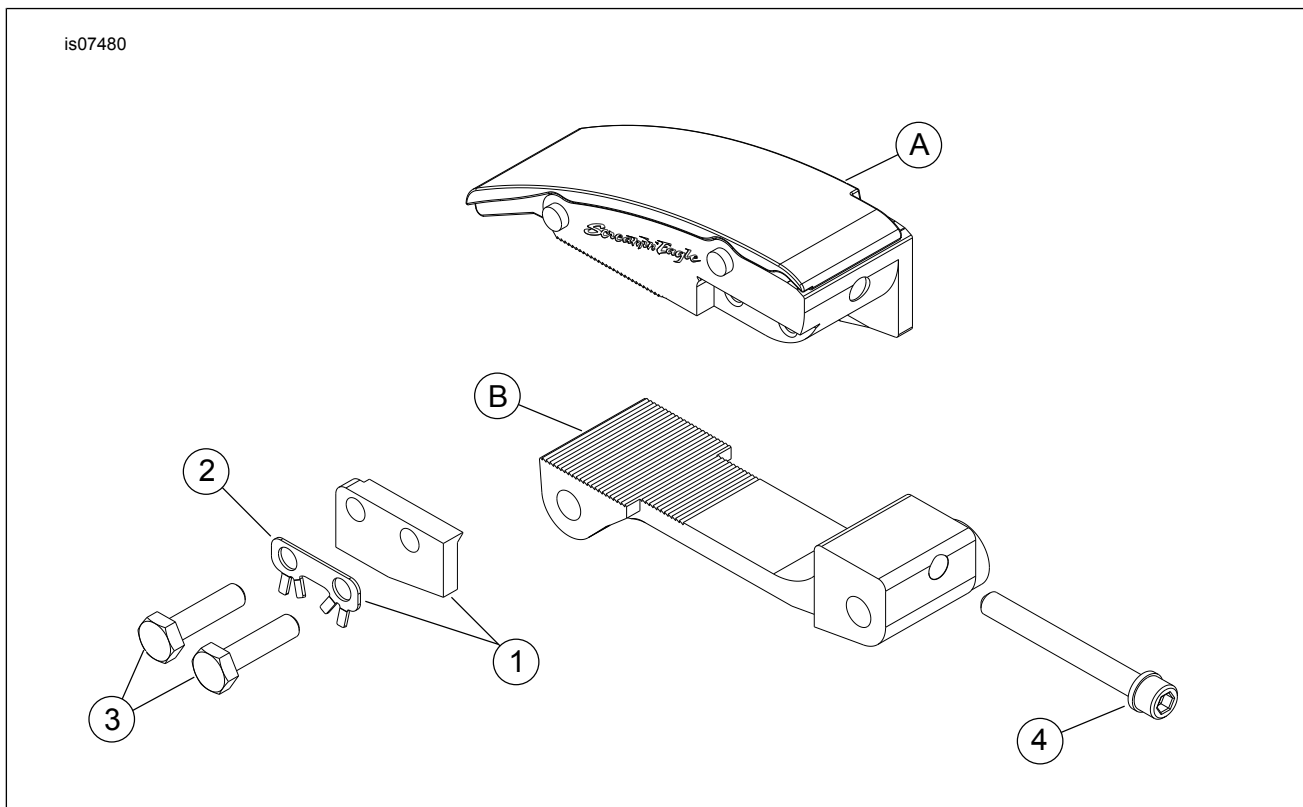

**Figure 4. SE Pro Manual Primary Chain Adjuster**

**Table 2. Service Parts Table**

Item	Description (Quantity)	Part Number
1	Kit, Side Plate and Lock Plate	36500050
2	Lock Plate	36500051
3	Hex Cap Screws (2)	2551W
4	Hex Socket Head Cap Screw	4717A
<b>Items mentioned in text, but not sold separately:</b>		
A	Upper Adjuster with Tensioner shoe	
B	Lower adjuster	