



INSTRUCTIONS

-J02704

REV. 2007-05-15

FLAME SHIFTER PEG/HEEL REST PAD KITS

GENERAL

Kit Number

34617-03 and 34680-03

Models

Shifter Peg Kit Part Number 34617-03 is designed for installation on all model motorcycles.

Heel Rest Pad Kit Part Number 34680-03 is designed for installation on all models equipped with Heel rest Kit Part Number 50227-01 or 50236-01.

Kit Contents

See Figure 1 for kit contents. The heel rest and shifter peg rubber treads and spacer tubes will be installed in their corresponding chrome castings.

INSTALLATION

NOTE

A Service Manual for your motorcycle is available at your Harley-Davidson Dealer. To enhance the flame pattern, orient the pegs as shown in Figure 1.

1. If replacing shifter peg, remove and discard existing shifter peg. If needed, apply heat with a heat gun to shift lever threads and threads on shifter peg to aid peg removal. If installing heel rest pads, proceed to Step 3.
2. See Figure 1. Using screw (6), attach shifter peg casting (1, 2) to shift lever. Tighten screw to 16.3-19 Nm (12-14 ft-lbs).

NOTE

Screw (6) has a lock patch to prevent loosening.

3. To install heel rest pads, perform Step 2 to attach the heel rest to the right or left heel rest lever.

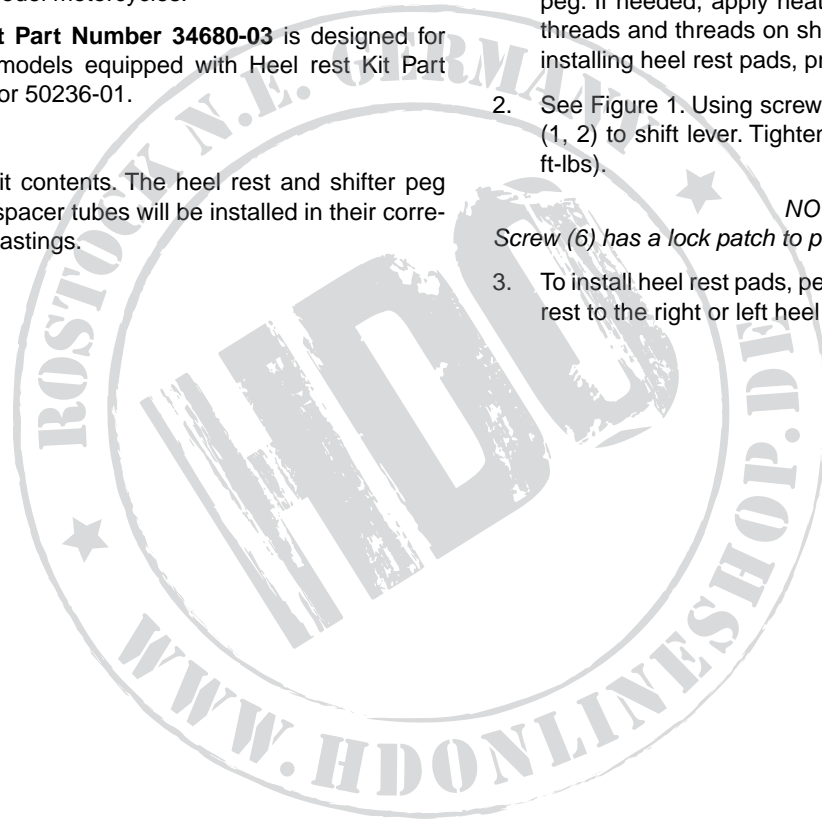

SERVICE PARTS

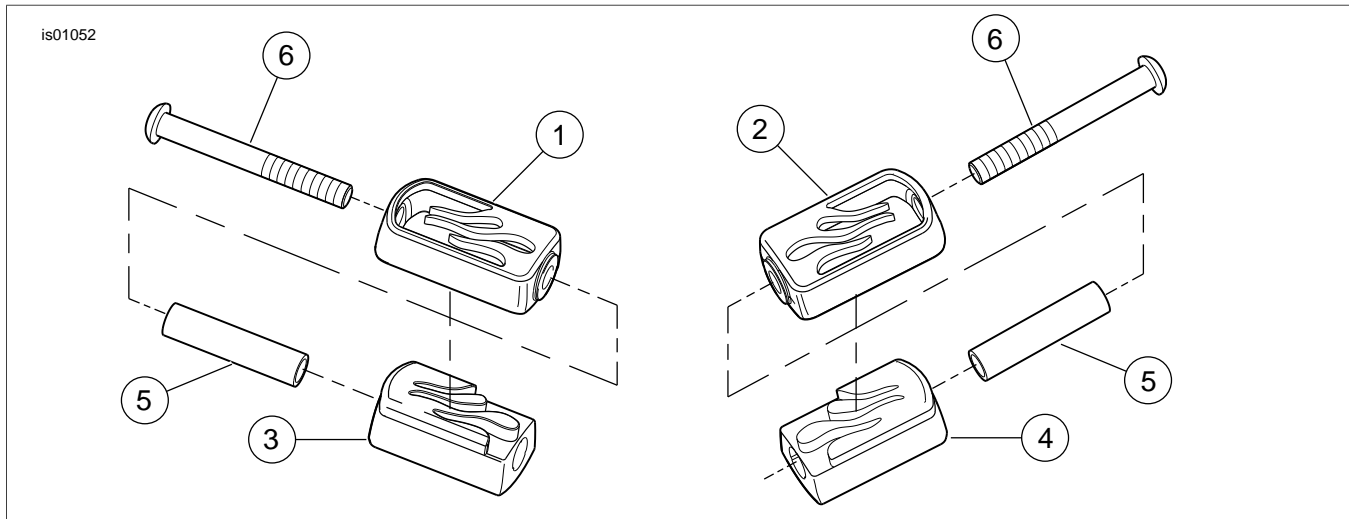

Figure 1. Service Parts: Flame Shifter Peg/Heel Rest Kit

Table 1. Service Parts Table

Item	Description (Quantity)	Part Number
Heel Rest Pad Kit (Part Number 34680-03)		
1	Casting shifter peg (heel rest left)	Not Sold Separately
2	Casting heel rest (right)	Not Sold Separately
3	Tread, shifter peg (heel rest left)	34679-03
4	Tread, heel rest (right)	34682-03
5	Spacer tube (2)	Not Sold Separately
6	Screw, hex socket, button head (2)	94545-03
Shifter Peg Kit (Part Number 34617-03)		
1	Casting shifter peg	Not Sold Separately
3	Tread, shifter peg	34679-03
5	Spacer tube	Not Sold Separately
6	Screw, hex socket, button head	94545-03