



INSTRUCTIONS

-J02077

REV. 2006-05-06

CYLINDER BASE COVER KIT

GENERAL

Kit Number

32753-01

Models

This kit fits 1999-2006 Touring models, 1999-2005 Dyna models with Forward Controls, and 2000-2006 Softail models. Will not fit with Engine Transmission Top Covers, Part Number's 66505-00, 66510-00, and 66513-00.

Additional Parts Required

LOCTITE® 243 (Blue) (Harley-Davidson Part Number 99642-97) is available from a Harley-Davidson Dealer.

Kit Contents

Table 1. Kit Contents

Description (Quantity)	Part Number
Cover, cylinder base	Not Sold Separately
Screw, 5/16-18x3-1/8 inch long	Not Sold Separately
Screw, cap (decorative)	Not Sold Separately
Pads, foam (installed) (2)	Not Sold Separately

There are no Service Parts available with this kit.

INSTALLATION

NOTE

When performing the following step, hold the 7/16 inch nut (between linkage and lever) in place while removing the nut securing the shifter rod to shift lever.

1. See Figure 1. Remove the nut (1) and lockwasher (2) to free the front end of the shift linkage (3) from the front shift lever (4). Save the nut and lockwasher for reinstallation.
2. Remove the 5/16 inch crankcase screw (5) centered between the cylinders as shown. Discard screw.
3. See Figure 2. Obtain the cylinder base cover (1) and new chrome crankcase screw (2) from kit. Position the cylinder base cover over the cylinders and align the mounting hole.
4. Install the **new** crankcase screw (5/16-18x3-1/8 inch long) and tighten to 15-19 ft-lbs (20.3-25.8 Nm).
5. Place the shift linkage (rod) into position. Apply a few drops of LOCTITE 243 (Blue) to the threads of the screw. Reinstall the lockwasher (3) and nut (4) and finger tighten.
6. While holding the 7/16 inch nut (5) in place, tighten the nut securing the front end of shift linkage to 20-24 ft-lbs (27-33 Nm).

7. Obtain the decorative cap (6) from kit and snap into the recess left after tightening crankcase screw.

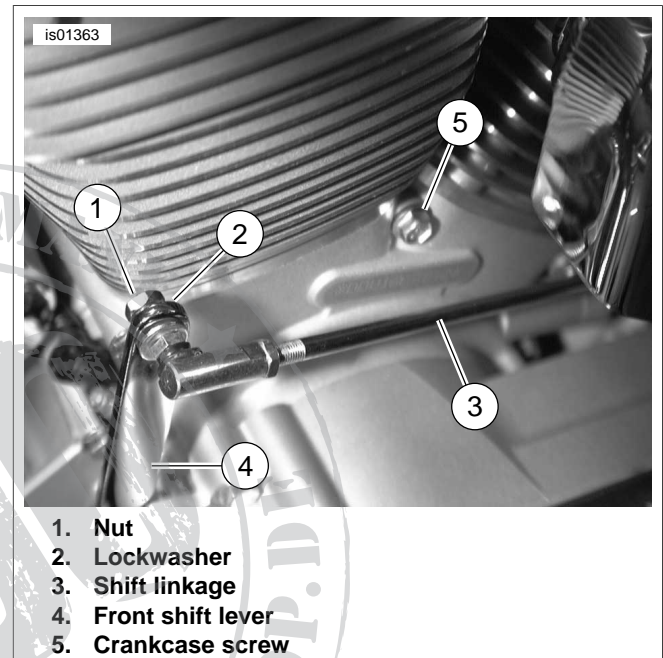

Figure 1. Remove Front of Shift Linkage and Center

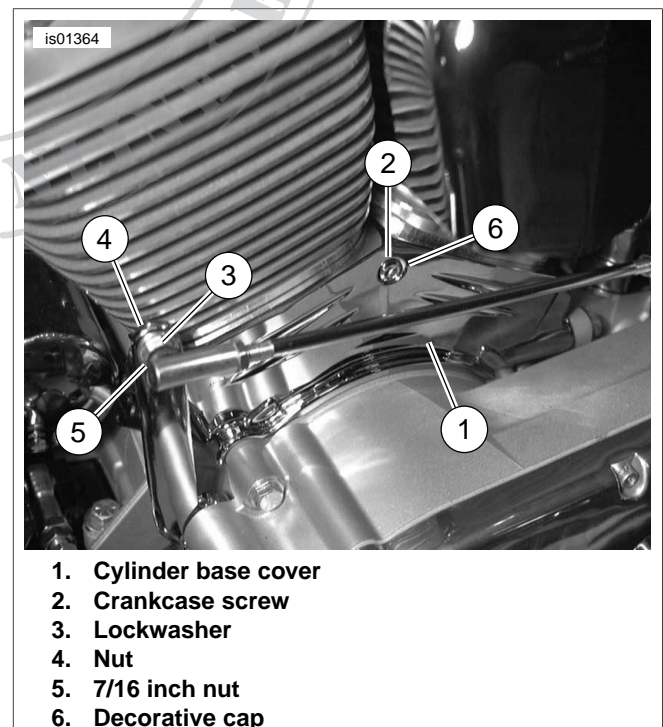

Figure 2. Cylinder Base Cover Installed