



INSTRUCTIONS

-J00059

REV. 11-11-96

Kit Number 29985-87

HIGH OUTPUT ALTERNATOR

General

This kit is designed for use on 1980 and later FLT and FLTC models, 1982 and later FXR, FXRS, and FXRT models and 1984 and later FXRD, FLHT, FLHTC, FXRDG, FXRS-SP, FXLR, FLHS and FXRC model vehicles.

This kit contains the following parts:

QTY	DESCRIPTION
4	Screw, sockethead torx
1	Ring terminal
6	Cable strap
1	Rotor assembly
1	Spacer, thick
1	Spacer, thin
1	Stator assembly
1	Regulator

Installation

1. Refer to applicable Service Manual for detailed removal and installation procedures.

CAUTION

Disconnect battery (negative cable first) before performing any electrical system servicing.

2. Observe the following guidelines to ensure proper operation.
 - A. Do not drop or pound on the new rotor assembly. Permanent damage can result.
 - B. Do not install a new style rotor with an old style rectifier. Permanent rectifier damage can result.

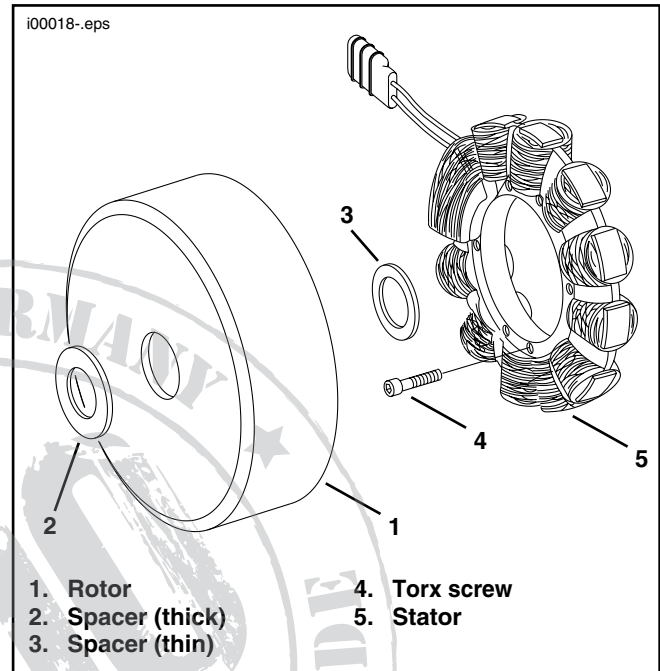

Figure 1. Alternator Installation

- C. Do not install a new style rectifier with an old style rotor. Permanent rectifier damage can result.
 - D. Route the black rectifier wire away from hot or moving parts. Secure it to the frame with cable straps. Trim excess wire length, crimp on ring terminal and attach to positive battery terminal.
3. See Figure 1. When installing rotor and stator use thin spacer inside and thick spacer outside of rotor.