



INSTRUCTIONS

-J00789

REV. 1-19-01

Kit Number 29769-01

AIR CLEANER COVER ADAPTER KIT

General

This kit is designed to fit all Twin Cam 88 models using Screamin' Eagle High Flow Air Cleaner Kit Part Number 29440-99, 29739-00, 28011-00 or 29441-99 in conjunction with Air Cleaner Cover Part Number 29598-00, 29599-00 or 29754-01.

See Service Parts illustration for kit contents.

⚠ WARNING

Installation of this kit and the matching air cleaner cover requires the use of 2-piece mounting studs (P/N 29447-99A.) If your Screamin' Eagle High Flow Air Cleaner Kit came with mounting studs of 1-piece design (P/N 29447-99), they must all be replaced with 2-piece studs (P/N 29447-99A.) Failure to replace studs may result in the Air Cleaner Assembly coming loose, leading to loss of control and death or serious injury. These studs are available at your Harley-Davidson Dealer.

Installation

1. Remove the existing air cleaner cover screw and cover.
2. Remove the two filter element mounting screws and the element. Inspect mounting studs.



Figure 1. Replace mounting studs if necessary

3. See Figure 1. If your Screamin' Eagle High Flow Air Cleaner is equipped with the 1-piece studs, remove the 1-piece studs and replace with new 2-piece studs (P/N 29447-99A). Torque studs to 3-5 ft-lbs (4.1-6.8 Nm).

4. Reposition the filter element over the mounting studs. Position the adapter plate (1) over the filter element in the approximate orientation shown on the Service Parts illustration. Attach the adapter plate and the filter element to the mounting studs using the two buttonhead screws (5) provided in the kit. Reuse the screw(s) removed in Step 2 to complete the filter element installation. Torque all screws to 3-5 ft-lbs (4.1-6.8 Nm).
5. Insert the oval-shaped boss on the rubber block (2) into the adapter plate (1). Flat edge of rubber block (2) faces rearward.
6. Remove the film from the adhesive-backed spacer (3).
7. Position the spacer (3) over the inside surface of the air cleaner cover (not included) and align the I.D. of the spacer (3) with the cover mounting hole.
8. Adhere the spacer (3) to the inside of the cover.
9. Install the cover using the screw (4) provided in air cleaner cover adapter kit. Tighten to 3-5 ft-lbs (4.1-6.8 Nm).



Service Parts

Part No. 29769-01

Date 1/01

Air Cleaner Cover Adapter Kit

i03397.eps

Air Cleaner Cover
P/N 29598-00, 29599-00
or 29754-01
(Purchased separately)

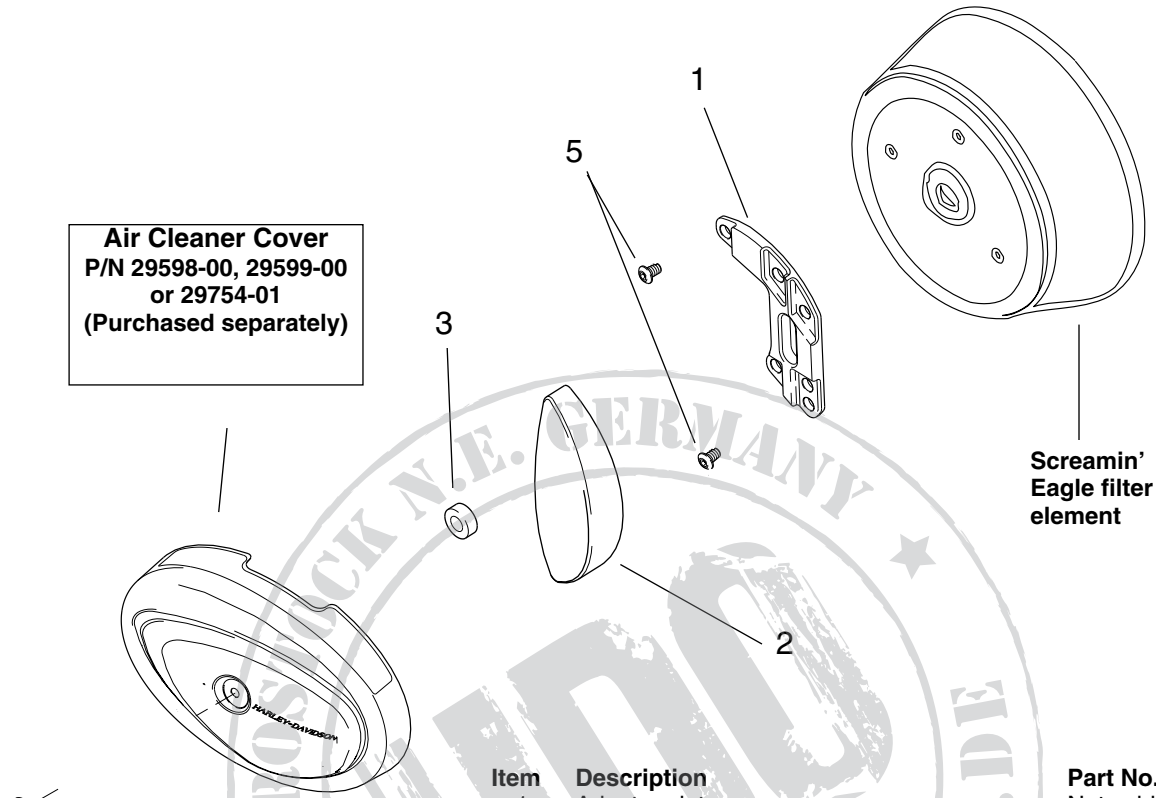

Screamin' Eagle filter element

Item	Description
1	Adapter plate
2	Rubber block
3	Spacer
4	Screw, special
5	Screw, 1/4-20 x .50, buttonhead (2)

Part No.
Not sold separately
Not sold separately
Not sold separately
29703-00
4365

i03420.eps