



INSTRUCTIONS

-J01978

REV. 08-04-2004

Kit Number 29745-00, 29745-00A

CHROME BILLET AIR CLEANER COVER KIT

General

These kits fit all Twin Cam engines and 1993-1999 carbureted Evolution® 1340 engines equipped with Screamin' Eagle High Flow Air Cleaner Kits (cone-shaped filter). See any Harley-Davidson Dealer for specific applications.

Kit 29745-00 will not fit with **later style** air cleaner backplate. See Figure 1.

Kit 29745-00A can be used with either earlier or later style air cleaner backplates.

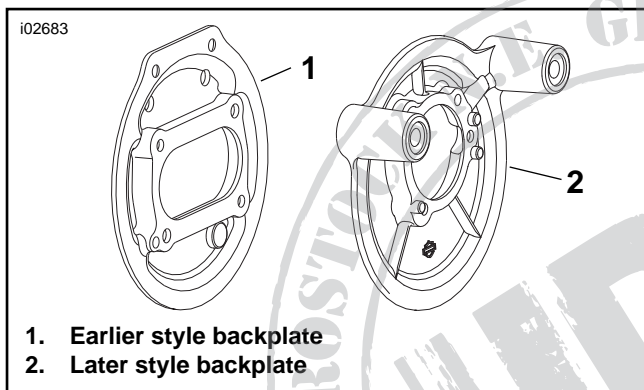

Figure 1. Air Cleaner Backplate Identification

See the Service Parts illustration for kit contents.

WARNING

Installation of this air cleaner cover requires the use of two-piece mounting studs. Failure to use two-piece studs can result in air cleaner assembly coming loose and loss of vehicle control, which could result in death or serious injury.

See Figure 2. If the Screamin' Eagle High Flow Air Cleaner Kit came with mounting studs of a one-piece design (Part Number 29447-99), they **must** all be replaced with **new** two-piece studs (Part Number 29447-99A). These studs are available from any Harley-Davidson Dealer.

Proper installation of this kit will also require the separate purchase of one of the following Billet Air Cleaner Medallion kits:

- Twin Cam 88, Part Number 29749-00A
- 95 Cubic Inch, Part Number 29748-00
- 103 Cubic Inch, Part Number 29795-02
- Evolution, Part Number 29753-00

These items are available separately from any Harley-Davidson dealer. Also available are the following Billet Air Cleaner Side Insert kits, which can be installed in place of the brushed aluminum side inserts provided in **this** kit:

- Black finish, Part Number 97005-02
- Plain (for color matching), Part Number 97002-02



1. One-piece stud 29447-99 (must be replaced)
2. Two-piece stud 29447-99A (must be used)

Figure 2. Two-Piece Studs MUST Be Used

1. Remove and discard the existing air cleaner cover screw and cover.

WARNING

Installation of this air cleaner cover requires the use of two-piece mounting studs. Failure to use two-piece studs can result in air cleaner assembly coming loose and loss of vehicle control, which could result in death or serious injury.

2. See Figure 2. If your Screamin' Eagle High Flow Air Cleaner came with one-piece studs, remove the filter element and studs. Replace with **new** two-piece studs, Part Number 29447-99A (available separately).

NOTE

See the Service Parts illustration inset. Earlier style backplates have two small mounting ears, which fit into shallow grooves (C) in the air cleaner cover from either kit. Later style backplates have two larger mounting bosses (B), which fit into notches found only in the cover from kit 29745-00A.

3. See Figure 3 and the Service Parts illustration.

For Twin Cam Engines: Obtain the air cleaner cover screw (2) from the kit. Insert the screw through the hole in the air cleaner cover (1), and secure the cover to the air cleaner. Tighten the screw to 3-5 ft-lbs (4-7 Nm).

For Evolution Engines: Obtain the air cleaner cover screw (2) and spacer (3) from the kit. Insert the screw through the center hole in the air cleaner cover (1). Install the spacer between the cover and air cleaner, and secure the cover to the air cleaner. Tighten the screw to 3-5 ft-lbs (4-7 Nm).

4. Install the air cleaner center medallion (A) as described in the instructions provided with **that** kit.

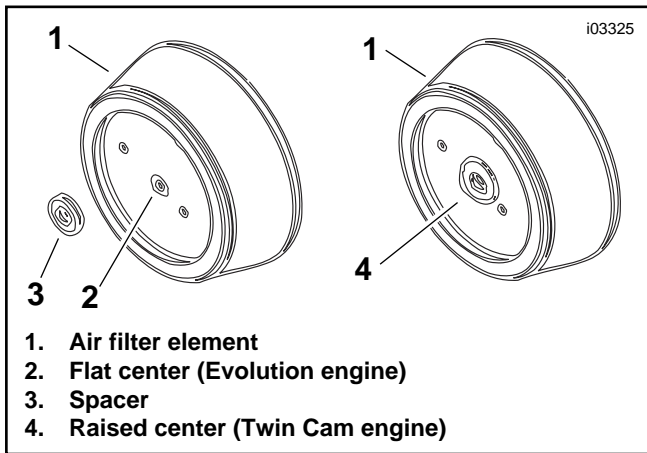

Figure 3. High-Flow Air Filter Elements

5. Use isopropyl alcohol to thoroughly clean the surfaces of the wing areas of the new air cleaner cover where the side inserts (4 and 5) will be installed, and the top surface of the cover where the label (6) will be affixed. Allow the cleaned areas to dry thoroughly.

6. Facing the air cleaner cover from the right side of the vehicle, remove the adhesive backing from the left-side insert (4) and carefully position it to the air cleaner cover. Apply pressure to the insert for one minute.

7. Repeat Step 6 with the right-side insert (5).

NOTE

Apply the warning label so the top is toward the motorcycle.

8. Remove the adhesive backing from the warning label (6), and apply to the top surface of the installed air cleaner cover.



Service Parts

Part No. 29745-00, 29745-00A | Date 08/04
Chrome Billet Air Cleaner Cover Kit

103326e

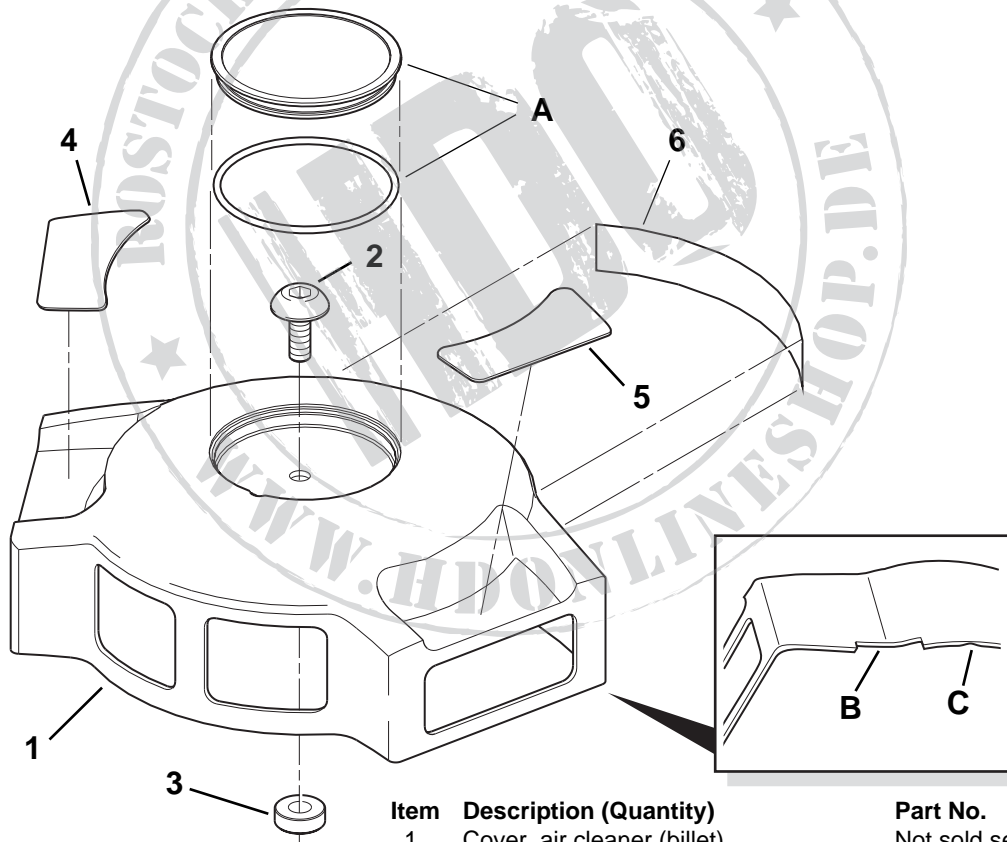

Item	Description (Quantity)	Part No.
1	Cover, air cleaner (billet)	Not sold separately
2	Hex socket screw, button head	29283-93
3	Spacer (for Evolution engines)	52103-31
4	Insert, brushed aluminum (left)	99696-00
5	Insert, brushed aluminum (right)	99697-00
6	Label, personal safety warning	29127-95A

Items identified in text:

- A Billet Air Cleaner Medallion Kit
- B Notch (2) for later backplate (found on kit 29745-00A cover only)
- C Groove (2) for earlier backplate (found on both kit covers)