

INSTALLATION INSTRUCTIONS

DRAG SPECIALTIES FOUR POINT DETACHABLE MOUNTING HARDWARE P/N 1510-0283/0284

ATTENTION INSTALLER (if other than owner): Please forward this Instruction Sheet to the purchaser of this product. These instructions contain valuable information necessary to the end user.

INTRODUCTION: These instructions describe the procedure for properly installing the four-point detachable mounting hardware kit for 2014-2016 FLHT, FLHR, FLHX, FLTR models

Review these instructions carefully before beginning, as they contain important information. Please retain for future reference.

Particularly important information is distinguished in these instructions by the following notations:

NOTE: A NOTE provides key information to make procedures easier or clearer.

CAUTION: A CAUTION indicates special procedures that must be followed to avoid damage to the motorcycle and/or accessories.

WARNING!: A WARNING indicates special procedures that must be followed to avoid injury to a motorcycle operator or person inspecting or repairing the motorcycle.

PROCEDURE:

INSTALLATION

1. See Figure 2. Remove two screws (**B**) from the saddlebag support on each side of the motorcycle. Lift the slot cover inserts (**A**) from the slots in the supports.

NOTE: The docking plates are side-specific. The longer pin (**C**) mounts toward the front of the vehicle.

2. Insert each docking plate assembly (**1 or 2**) into the slot in the correct-side saddlebag support.

3. Place a washer (**8**) over the threads of each of the $\frac{5}{16}$ -18 x 1" screws (**7**) from the kit. Apply 2 or 3 drops of Red Thread Adhesive to the screw threads.

4. Install the screws through the docking plates (**1 or 2**) and saddlebag supports and into the threaded holes in the frame extensions on each side of the vehicle. Tighten to 20 ft-lbs.

NOTE: See Figure 1. Install the docking points to the docking plates (**2**) with the chamfer (**1**) facing the plate (flat side facing out).

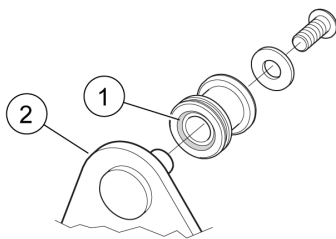

1. Docking point chamfer (bevel)
2. Mounting plate

Figure 1.

5. See Figure 2. Slide a spacer (**3**) onto the longer pin (**C**) of each docking plate. Slide a docking point (**4**), chamfer end first, onto each docking plate pin.

Install a chrome washer (**5**) onto each of the $\frac{1}{4}$ -20 x $\frac{1}{2}$ " screws (**6**) from the kit. Apply 2 or 3 drops of Blue Thread Adhesive to the threads of each screw.

6. Install the screws into the docking plate pins. Tighten to 10.5 ft-lbs.

WARNING!: Before operating motorcycle, be sure all hardware is tight.

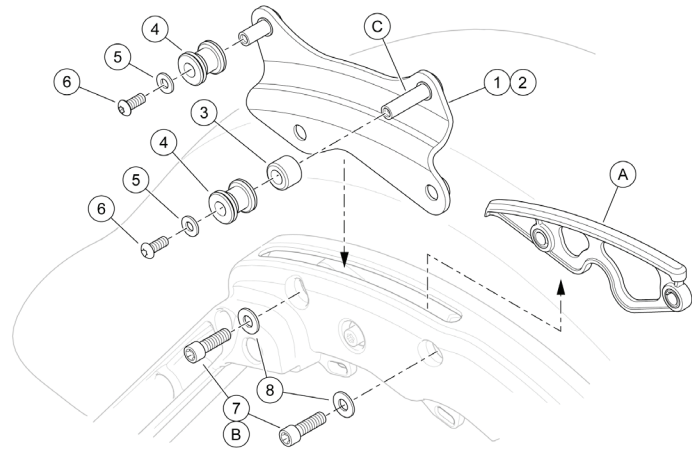

Figure 2.

Item	Description (Quantity)
1	Docking plate assembly (right side, shown)
2	Docking plate assembly (left side, not shown)
3	Spacer, docking point (2)
4	Docking point (4)
5	Plain washer, chrome (4)
6	SS flat head socket cap screw $\frac{1}{4}$ -20 x $\frac{1}{2}$ " (4)
7	Socket head flat screw $\frac{5}{16}$ -18 x 1" (4)
8	Plain washer, zinc finish (4)
Items mentioned but not included	
A	OE slot cover insert (2)
B	Slot cover insert attaching screw (4)
C	Long docking plate pin (2)

