

BAHN

1095

BAHN SHIFT LEVER — TUXEDO

INFORMATION AND SUPPORT

INFO@BAHNPRODUCTS.COM

866 294 2827

⚠ WARNING

THIS INDICATION ALERTS YOU TO THE FACT THAT IGNORING THE CONTENTS DESCRIBED HEREIN CAN RESULT IN POTENTIAL DEATH OR SERIOUS INJURY.

CAUTION

THIS INDICATION ALERTS YOU TO THE FACT THAT IGNORING THE CONTENTS DESCRIBED HEREIN CAN RESULT IN MINOR OR MODERATE POTENTIAL INJURY.

NOTICE

This indication alerts you to the fact that ignoring the contents described herein may negatively affect product performance and functionality or damage the product itself or the product to which it is being attached.

MAKE SURE THE FOLLOWING PARTS HAVE BEEN INCLUDED IN THE KIT:

- 1 BAHN Shift Lever — Tuxedo
- 1 Hardware Kit containing:
 - 1 BAHN Shift Peg
 - 1 5/16"-24 X 2.5" Socket Head Cap Screw
 - 1 Washer
 - 1 5/16"-24 X .875" Socket Head Cap Screw
- 1 Installation Instructions

YOU WILL ALSO NEED:

Set of combination wrenches, set of hex wrenches, non-permanent marker, (242 Medium Strength) Blue Loctite

NOTICE

These installation instructions contain important information. Ensure that the end user receives this copy and is aware of its importance for future reference.

⚠ WARNING

THE END USER'S SAFETY DEPENDS UPON PROPER INSTALLATION OF THIS PRODUCT. IF A STEP IN THESE INSTRUCTIONS IS NOT WITHIN YOUR CAPABILITIES OR YOU DO NOT HAVE THE CORRECT TOOLS, HAVE YOUR DEALER PERFORM THE PROCEDURE. IMPROPER INSTALLATION OF THIS PRODUCT COULD RESULT IN DEATH OR SERIOUS INJURY.

ACCIDENTAL VEHICLE START-UP COULD CAUSE DEATH OR SERIOUS INJURY, REMOVE THE MAIN FUSE BEFORE PROCEEDING.

1095

BAHN SHIFT LEVER — TUXEDO

INFORMATION AND SUPPORT

INFO@BAHNPRODUCTS.COM

866 294 2827

STEP 1 Read and understand all **STEPS** in the instructions before starting the installation. Park the motorcycle on a hard, level surface and turn **IGN OFF**. Allow the engine and exhaust system to cool. Remove the main fuse

STEP 2 Refer to **PIC 1**. Measure between the shift pegs and the top plane of the board. Use a non-permanent marker to mark the angle of the existing shift levers on the end of the shift shaft.

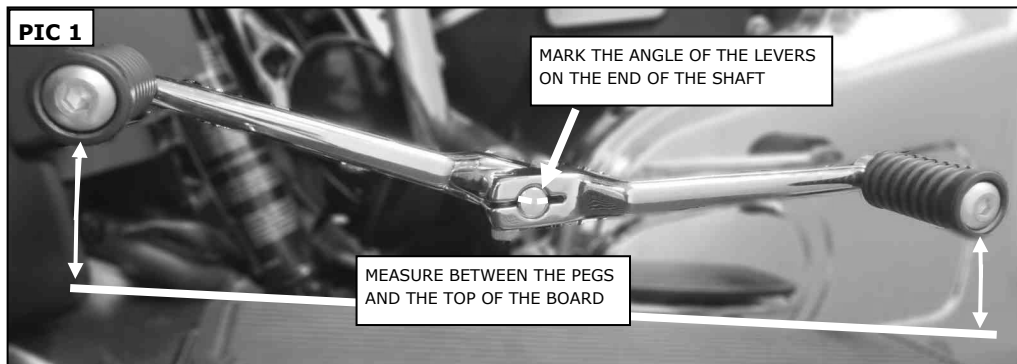

STEP 3 Refer to **PIC 2**. Remove the existing pinch screws from the shift levers; set them aside, they will not be reused. Slide the existing shift levers off of the shift shaft; set them aside, they will not be reused.

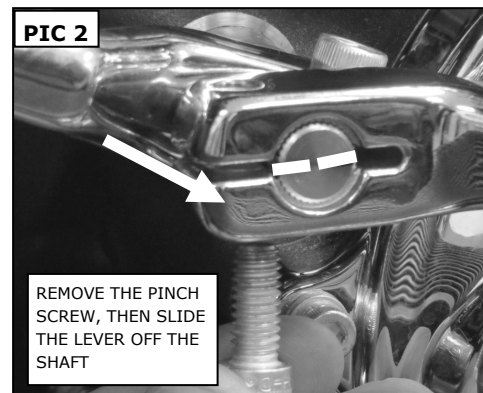

NOTE: Shift lever/peg height is the end user's preference. Use the marks and measurements as a starting point when adjusting the position of the levers on the shift shaft. During installation, ensure proper clearance between the shifting mechanism and the boards.

STEP 4 Refer to **PIC 3**. Align the BAHN Shift Lever(s) with the marks and slide them onto the shift shaft. Measure the distance to the top plane of the board; remove the levers from the splined shaft if any adjustments are necessary.

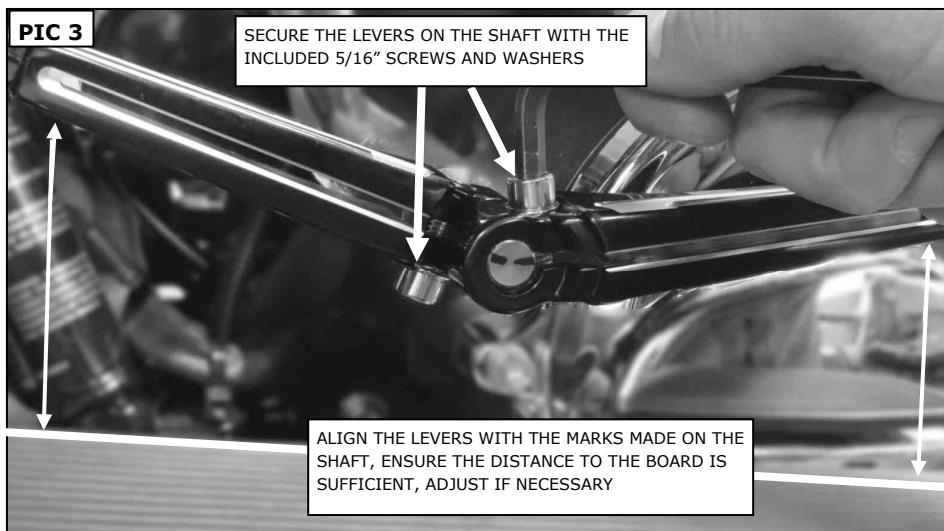

1095

BAHN SHIFT LEVER — TUXEDO

INFORMATION AND SUPPORT

INFO@BAHNPRODUCTS.COM

866 294 2827

STEP 5 Secure the BAHN Shift Lever(s) on the shaft with the included 5/16"-24 X .875" Socket Head Cap Screws and Washers.

NOTE: Prepare the included 5/16"-24 X 2.5" Socket Head Cap Screws according to the thread locker manufacturer's recommendations.

STEP 6 Insert the included 5/16"-24 X 2.5" Socket Head Cap Screws through the BAHN Pegs. Apply blue Loctite (242 Medium Strength) to the exposed screw threads. Thread the screws into the Shift Levers; tighten the screws.

STEP 7 Ensure that the bike is in neutral BEFORE starting the bike. Ensure proper function of the shifting mechanism BEFORE operating the bike.

TIPS FOR PROPER CARE:

Your new BAHN product is made out of anodized aluminum. Anodized aluminum requires special attention when cleaning. Some cleaning products or procedures can actually remove the anodized treatment which will lead to pitting in the aluminum.

Thoroughly clean the BAHN product often with a soft cloth, mild soap and water. Regular cleaning keeps contaminants from building up.

Rinse thoroughly with FRESH water.

Use only metal protection products that are formulated for anodized aluminum.

DO NOT USE bleach or chlorides to clean the BAHN product.

DO NOT USE products containing abrasives to clean the BAHN product. **Never** use steel or brass wool, wire brushes, polishing wheels, rubbing or polishing compounds on the BAHN product.

DO NOT USE concentrated alkaline based solutions to clean the BAHN product. Many detergents are alkaline based.

NOTICE

It is the end user's responsibility to ensure that all of the fasteners (including pre-assembled) are tightened before operation of the motorcycle. Küryakyn will not provide warranty coverage on products or components lost due to improper installation or lack of maintenance. Periodic inspection and maintenance are required on all fasteners.

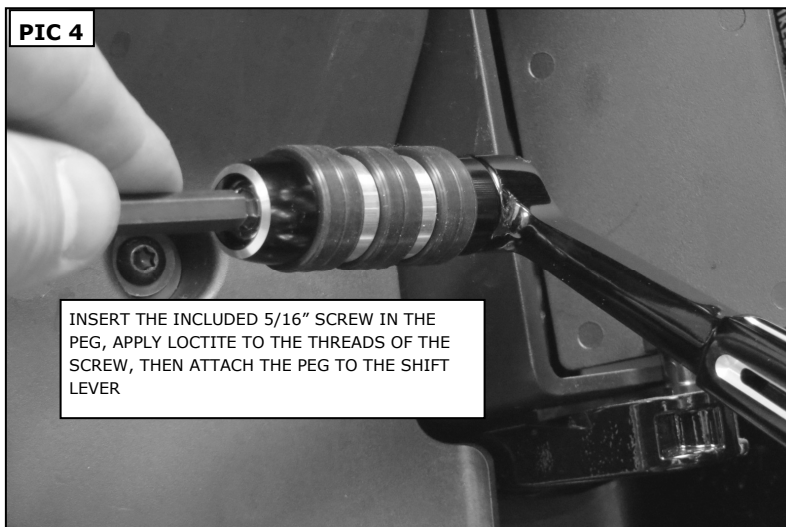

LIMITED WARRANTY

Küryakyn warrants that any Küryakyn products sold hereunder, shall be free of defects in materials & workmanship for a period of one (1) year from the date of purchase by the consumer excepting the following provisions:

1. Küryakyn shall have no obligation in the event the customer is unable to provide a receipt showing the date the customer purchased the product(s).
2. The product must be properly installed, maintained & operated under normal conditions.
3. Küryakyn shall not be liable for any consequential & incidental damages, including labor & paint, resulting from failure of a Küryakyn product, failure to deliver, delay in delivery, delivery in nonconforming condition, or for any breach of contract or duty between Küryakyn & a customer.
4. Küryakyn products are often intended for use in specific applications. Küryakyn makes no warranty if a Küryakyn product is used in applications other than intended.
5. Küryakyn electrical products are warranted for one (1) year from the date of purchase by the consumer. L.E.D.'s contained in components of Küryakyn products will be warranted for defects in materials & workmanship for 3 years from the date of purchase where as all other components shall be warranted for one (1) year. This includes, but is not limited to; control modules, wiring, chrome & other components.
6. Exhaust systems are warranted for manufacturing defects only. There is no warranty on exhaust pipes & mufflers with regard to any discoloration. Discoloration or "blue-ing" is caused by tuning characteristics, exhaust timing, carburetor jetting, overheating, etc. & is not caused by defective manufacturing.
7. Küryakyn makes no warranty of any kind in regard to other manufacturer's products distributed by Küryakyn. Küryakyn will pass on all warranties made by the manufacturer & where possible, will expedite the claim on behalf of the customer, but ultimately, responsibility for disposition of the warranty claim lies with the manufacturer.
8. Merchandise purchased directly from internet auction sites or any other third party seller is considered sold as is & shall not carry a Küryakyn warranty. All warranty claims must be directed to the original seller. If unsure please contact the seller to verify they are an authorized Küryakyn retailer.